

# JUDGING PROGRAM

SAT: #2021145001-CO, #2021145003-R • SUN: #2021145002-CO #2021145004-R  
**AMERICAN KENNEL CLUB RULES AND REGULATIONS GOVERN THESE EVENTS.**

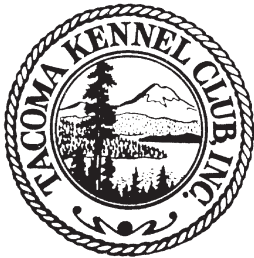

**Saturday & Sunday – April 24-25, 2021**

**Tacoma Kennel Club, Inc.**

~ 1890 – 2021 ~ (American Kennel Club Licensed)

**Two All Breed Dog Shows with NOHS**

**Two Obedience Trials & Rally Trials**

**JUNIOR SHOWMANSHIP BOTH DAYS**

**BEST PUPPY-SATURDAY • BEST BRED BY EXHIBITOR-SUNDAY**

These Shows will be held indoors and are Unbenched

**THE TACOMA DOME • 2727 East D Street • Tacoma, Washington**

**FREE PARKING – ALL EVENTS UNDER ONE ROOF**

**FACEMASKS MUST BE WORN**

**WRISTBANDS PICKUP WILL NOT BE AVAILABLE UNTIL 7:00 AM**

**These Shows are Dedicated to the Memory of Sandi Murphy and Carol Wolf.**

**CONCURRENT SPECIALTIES** • Washington State Cocker Spaniel Club (both days) • Puget Sound Pug Dog Club (Saturday only)

**SUPPORTED ENTRIES - BOTH DAYS:** • Washington State Cocker Spaniel Club • The Rat Terrier Club of America • Evergreen Maltese Club • Mount Rainier Yorkshire Terrier Club

**SUPPORTED ENTRY - SUNDAY** • Puget Sound Pug Dog Club

All events closed to the public - an inherent risk of exposure to COVID-19 exists in any place where people are present. COVID-19 is an extremely contagious disease that can lead to severe illness and death. By attending these events, you voluntarily assume all risks related to exposure to COVID-19.

**EXHIBITORS NOTE: YOUR ACKNOWLEDGEMENT IS YOUR ADMITTANCE.**

**YOU MUST BRING YOUR ACKNOWLEDGEMENT AND ENTER THE BUILDING THROUGH THE TACOMA DOME MAIN ENTRANCE. IF YOU DO NOT RECEIVE YOUR ACKNOWLEDGEMENT IN THE MAIL BY THURSDAY, APRIL 22, CALL THE BARAY OFFICE.** If you forget your Acknowledgement, you will be directed in through security and stringent metal detectors.

**CONTRACTED SHOW PHOTOGRAPHERS/VIDEOGRAPHERS**

Elaine Russell Rushton ..... PO Box 2029, Milton, WA 98354 / 253-242-7491

**ON-SITE SHOW VETERINARIAN**

Kim Cargen, DVM, AVCA

**ON-CALL SHOW VETERINARIAN – 24-HOUR EMERGENCY**

**BLUE PEARL PET HOSPITAL**

2510 84th St. Suite 30D, Lakewood, WA 98499 • 253-474-0791

Get on I-5 S from E 26th St and Pacific Ave. Merge onto I-5 S toward Portland. Go 3.86 miles. Take the So 72 St exit, EXIT 129, toward So 84 St. Go 0.18 miles. Keep left to take the ramp toward S 84 St/S 72 St. Go 0.31 miles. Keep left to take the ramp toward Bates Technical College. Go 0.03 miles. Turn left onto Tacoma Mall Blvd. Go 0.58 miles. Turn right onto 84th St. Go 0.19 miles to 2510 84th St S, 30D, Lakewood, WA 98499-9034

There will be an EMT in attendance.

**SHOW COMMITTEE**

**Pamela Armstrong – Show Chair**

2240 S 308th St., Federal Way, WA 98003

Paula Olcott ..... Obedience Chair  
 Rod Jaeger ..... Rally Chair

*And All Officers and Directors of the Club*

Day of Show Phone: 253-951-0906

**BENCH COMMITTEE – Members of the Show Committee**

**COMMITTEES**

Ruth Richard ..... Chief Ring Steward  
 Mark Iseki ..... Decorations  
 Mark Iseki ..... Trophies  
 Bob Reid ..... Catalog Sales  
 Pamela Armstrong ..... Judges  
 Ruth Richard ..... Judges' Transportation  
 Robin Kestin ..... Historian  
 Pamela Armstrong ..... Judges' Hospitality  
 Lynette Richardson ..... Show Luncheon  
 Announcer ..... Bubba Russell  
 Jamie Morris ..... Website  
 Allen Morris & Rod Jaeger ..... General Parking/Grounds  
 Lynette Richardson, Robin Kestin,  
 Brianna Bundrick ..... Show Hospitality

**JUDGES – BOTH DAYS**

Dawn M Antoniak-Mitchell Esq. [39068].. QUEEN CREEK, AZ 85142  
 Emily (Fish) Barnhart\* [92354] ..... CAMAS, WA 98607  
 Sandra Bingham-Porter\* [94107] ..... CHARLESTON, IL 61920  
 Mrs. Kathleen J Brock\* [47792] ..... GIG HARBOR, WA 98329  
 Paul Chen [90736] (SUN) ..... VASHON, WA 98070  
 Sue Cox [4593] ..... SHORELINE, WA 98177  
 Karen M Ericson [7034] (Sun) ..... CARNATION, WA 98014  
 Kathleen M Galotti [17184] ..... NORTHFIELD, MN 55057  
 Christie Martinez\* [22596] ..... PORT LUDLOW, WA 98365  
 Kimberly Anne Meredith [5978] (SAT) ..... GRANTS PASS, OR 97526  
 Diana McCarty [17423] (SAT) ..... BUFFALO, MN 55313  
 Barbara J O'Neil [15439] ..... SEATTLE, WA 98168  
 Jane F Treiber\* [5791] ..... CHEHALIS, WA. 98532  
 Marilyn Van Vleit\* [67040] ..... SALEM, OR 97306  
 R C Williams\* [93917] ..... SHINGLE SPRINGS, CA 95682  
 Lee Whittier\* [18526] ..... VANCOUVER, WA 98664  
 Wood Wornall\* [95931] ..... WESTON, MO 64098  
 \*PROVISIONAL/PERMIT

**TRANSFER OF ENTRIES**

**NOTE: TRANSFER OF ENTRIES AND REQUESTS FOR REFUNDS FOR PUBLISHED JUDGE CHANGES WILL NOT BE ACCEPTED IN THE OFFICE AFTER 12:00 NOON ON THURSDAY, APRIL 22. AFTER THIS TIME, YOU MUST CONTACT THE SUPERINTENDENT ON SITE.**

**CONFORMATION:** Dogs may be transferred from one of the regular classes to the Best of Breed or Variety competition, provided this transfer is presented to the Superintendent at least one half-hour prior to the scheduled start of any regular conformation judging at the show.

**JUNIOR SHOWMANSHIP:** Junior Handlers who win a third Novice Class with competition, if a win in Novice leads to a Best Junior with competition present it will count as one win towards moving to Open, after closing of entries for a show are required to transfer their entry from the Novice Class to the Open Class by notifying the Superintendent prior to the start of the class at the show. Correction may be made from one age division to another, as well as, move from Master to Open or Open to Novice if a win has been disallowed or the Junior miscalculated number of placements, provided this transfer must be made to the Superintendent prior to the judging of the class at the show.

**OBEDIENCE OR RALLY:** A transfer (i.e., from an obedience class to an obedience class; or a rally class to a rally class) may be requested if, according to the owner's records the handler and dog are eligible provided the club offers transfers. Transfers from an "A" to "B" class at the same level are allowed provided the host club allows transfers. The request for a transfer must be in writing and presented to the Superintendent or Trial Secretary at least 30 minutes prior to the start of each trial. Clubs may choose to accept transfers prior to the day of the trial and this should be clearly stated in the premium list. Transfers may be approved provided the class and judge are available, and the class has not reached its limit.



**American Kennel Club®**

CERTIFICATION Permission has been granted by the American Kennel Club for the holding of this event under the American Kennel Club rules & regulations.

**GINA M. DINARDO, Executive Secretary**



**BaRay Event Services, Inc.**

**A.K.C. ANNUALLY LICENSED SUPERINTENDENTS**

**MEMBER: DOG SHOW SUPERINTENDENTS ASSOCIATION**  
 •SHEILA RAYMOND•BECKY SUMNER•JERRY SUMNER•CHUCK ST. JOHN  
 •DALE NEUKOM, JR•JEFFERY INMAN•GLENN WHITTEN•KRISTIN MARICICH  
 •ROBERTA MARTIN•GUY MICHELSON•SHARON SAMSON

PO BOX 508, BURLINGTON, WA 98233  
 PHONE: 360-755-7086 • FAX: 360-755-2248

HAND-DELIVERED, EXPRESS or PRIORITY, FEDEX or UPS:  
 113 E. FAIRHAVEN AVE., BURLINGTON, WA 98233 (do NOT require signature)  
 E-MAIL: dogshows@barayevents.com • WEB SITE: BaRayEvents.com

OFFICE HOURS  
 10AM-5PM  
 PACIFIC TIME  
 MON.-FRI.

Like us on  
**FACEBOOK**



**NOTICE TO EXHIBITORS**

**SAFETY, BEHAVIOR and LIABILITY**

The safety of the dog is our primary concern. By entering this event, exhibitors acknowledge that they are familiar with the rules and regulations of this sport. It is expressly understood that exhibitors alone are responsible for the behavior of their dogs and/or children. Any exhibitor whose dogs and/or children create an unnecessary disturbance or repeatedly engage in unsafe or disruptive behavior may, at the discretion of the event committee, be asked to leave the show site. In such case, no refund of any fees paid will be made. Tacoma Kennel Club and its agents, employees, etc., will assume no responsibilities for any loss, damage or injury sustained by exhibitors or handlers or to any of their dogs or property and further assume no responsibility for injury to children. The Club reserves the right to decline entries for cause and may remove any dog on account of aggression. No one shall have any recourse or claim against either organization or any official thereof. All dogs must be on leash at all times when on event grounds. No retractable leads or prong collars.

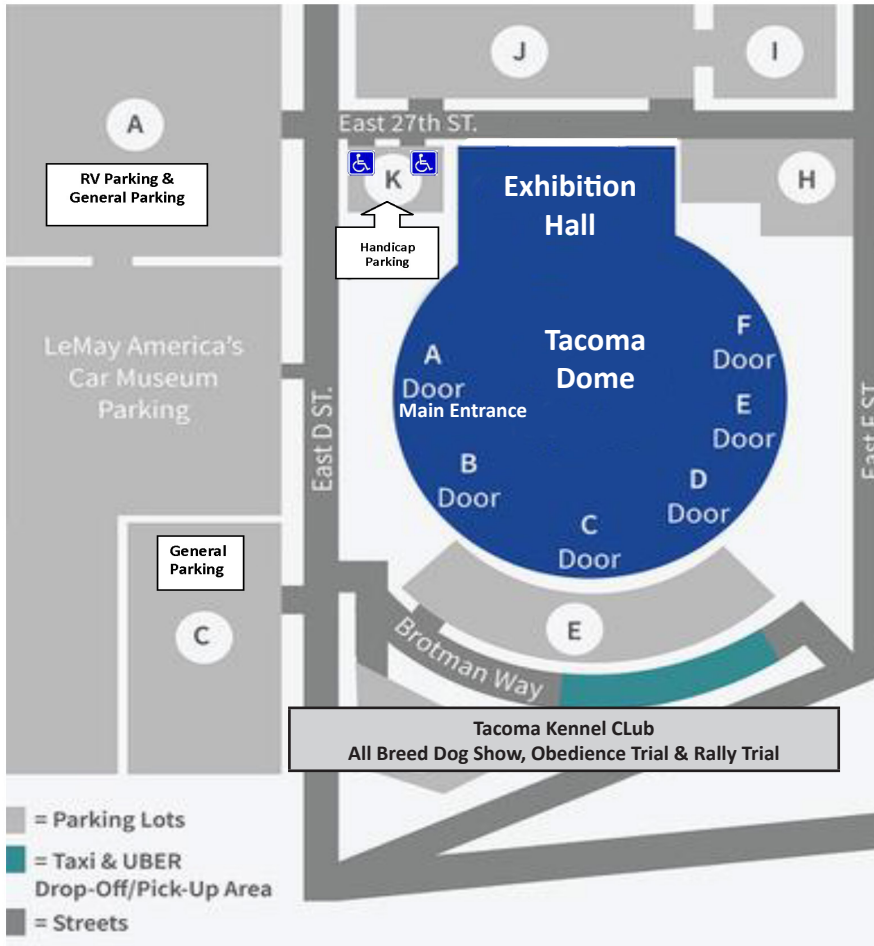

**Tacoma Kennel Club**  
All Breed Dog Show, Obedience Trial & Rally Trial

**ROUTES TO THE SHOW**

The Tacoma Dome is located at 2727 East D Street, Tacoma, Washington  
 Traveling South on I-5: Exit 135 to Portland Avenue; Follow E 27th Street until it becomes Wiley Avenue (Exit 133 is NOT recommended)  
 Traveling North on I-5: Exit 134 to Portland Avenue; Left on Portland Avenue; Left on E 27th Street until it becomes Wiley Avenue. (Exit 133 is NOT recommended)

**SHOW INFORMATION**

- Doors will open at 6:30AM Saturday and Sunday. Entrance available on the South Side on East "D" Street (Main Entrance).
- Each exhibitor will receive an acknowledgement of entry. See Admittance information above.
- No exercise pens will be permitted.
- All dogs shall be kept on leash except when in the obedience or rally ring.
- There shall be no drilling nor intensive corrective training of dogs on the grounds or premises.
- STOOP TO SCOOP. The City of Tacoma has a "Poop Scoop" Law – \$500 FINE for anyone seen leaving their dog's excrement on city property. Designated exercise areas will be clearly marked.
- No dogs that are disqualified for aggression will be allowed to enter these shows, nor be allowed to be on the grounds. In addition, no aggression reinstatement procedures will be performed at these shows.

**PARKING**

**THERE IS NO SECURITY PROVIDED, PARKING IS AT YOUR OWN RISK.**

**ABSOLUTELY NO HUMAN HABITATION OVERNIGHT IN RV ON TACOMA DOME PROPERTY**

*Parking will be available under the following conditions:*  
 Please note: ABSOLUTELY NO HUMAN HABITATION OVERNIGHT ON TACOMA DOME PROPERTY.

- Dog show Parking in Tacoma Dome "A" & "C" Lots is Free!
- UNINHABITED RV's are allowed to remain on Tacoma Dome property overnight in "A" Lot – ABSOLUTELY NO HUMAN HABITATION IS ALLOWED OVERNIGHT PURSUANT TO TACOMA DOME POLICY.
- Parking area must be left clean.
- No dumping of grey water or sewage. If found, \$500 fine will be levied.
- No electrical hook ups or access to water will be available.
- RV and Over-sized vehicle parking – Free in Tacoma Dome "A" Lot - NO OVERNIGHT HUMAN HABITATION ALLOWED ON TACOMA DOME PROPERTY - THERE IS NO SECURITY PROVIDED, PARK AT YOUR OWN RISK.

**IMPORTANT PARKING INFORMATION**

Parking is a privilege extended by the show giving club. The club reserves the right to withdraw this privilege from any person(s) who feel they cannot abide by the rules and regulations or resort to abusive language. All parking is at your own risk. The club assumes no responsibility for fire, theft, and/or damage to any vehicle or its cargo. No Parking in designated fire lanes.

**DOG FRIENDLY HOTELS**

Pets Welcome ([www.petswelcome.com](http://www.petswelcome.com)) -or-  
 Bring Fido ([www.bringfido.com](http://www.bringfido.com))

**AREA RV ACCOMMODATIONS**  
 Camping World, 4650 16th Street E, Fife, WA 98424 allows overnight camping for 2 nights free with a Good Sam membership (\$30 per year). First-come, first-served. May not leave dogs outside unattended. 800-526-4165.  
 THERE IS ABSOLUTELY NO HUMAN HABITATION OVERNIGHT IN RV ON TACOMA DOME PROPERTY

**SECURITY NOTICE TO ALL EXHIBITORS**

Allow PLENTY OF TIME to get to your rings because of the ADDITIONAL SECURITY required by the Tacoma Dome. Judges will not wait for you to get to the ring.

**AED LOCATION**

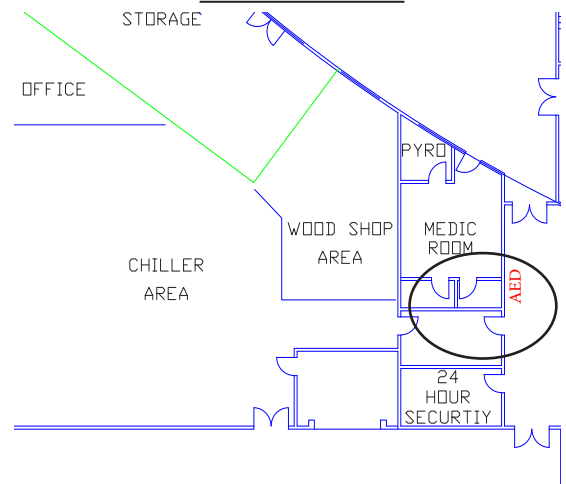

H LOT  
 SECURED LOT

## **COVID-19 EVENT WAIVER EXHIBIT "A"**

The following plan will be enforced throughout all time relevant to the Tacoma Kennel Club, Inc., all-breed dog shows and the associated events (collectively referred to as "The Event"). This plan is subject to change as necessary.

1. IF YOU ARE ILL, COUGHING, SNEEZING, RUNNING A TEMPERATURE OR FEEL UNWELL, please stay home because any Exhibitor or Attendee with these conditions will not be admitted to The Event.
2. EXPOSURE TO COVID-19: If you have recently tested positive for COVID-19, or if you have recently been in the presence of a person who has either tested positive for COVID-19 or has the symptoms of COVID-19 (including, but not limited to, coughing, sneezing, or high temperature), please stay home because any such by Exhibitor or Attendee will not be admitted to The Event. If proof of a positive COVID-19 test dated from The Event closing dates through April 25, 2021, is submitted, you will be eligible for a partial refund of entry fees.
3. WRISTBANDS AND ADMISSION INTO THE EVENT: The following procedures will be in place throughout The Event:
  - a. Wrist Bands or Stickers: All Exhibitors, and Attendees will be given a wrist band or sticker to indicate The Clubs have a signed Waiver on file. If you lose your wrist band/sticker or it falls off, please go to the COVID-19 Monitor for another wrist band or sticker; it will be confirmed that a signed Waiver is on file before another wrist band or sticker will be issued. Please note you MUST have a wrist band or sticker to pick up any armbands; and
  - b. Failure to comply with these procedures will result in a bench hearing.
4. ATTENDANCE: All Exhibitors and Attendees must adhere to the Social Distancing Guidelines provided in Paragraph 5 below. This includes, but is not limited to, placing chairs six (6) feet apart or creating small "family units." Please understand that Exhibitors and Attendees may be asked to move, spread out, or wait outside the building, so that state, county, and/or local social distancing requirements may be maintained.
5. SOCIAL DISTANCING: All Exhibitors and Attendees must maintain social distancing of the recommended six (6) feet from others in attendance at The Event. Please be cognizant that other Exhibitors and Attendees may have medical issues or concerns of which you are unaware. Those in attendance at The Event will undoubtedly have different levels of concern and fear, and thus The Clubs are requiring that each individual in attendance at The Event to be respectful of others.
6. MASKS: PER AKC AND THE CLUBS, EVERYONE IN ATTENDANCE AT THIS EVENT WILL BE REQUIRED TO WEAR A MASK AT ALL TIMES THAT ADEQUATELY COVERS BOTH THE NOSE AND MOUTH. YOU ARE REQUIRED TO SUPPLY YOUR OWN MASK(S). THERE WILL NOT BE ANY EXCEPTIONS.
7. DESIGNATED COVID-19 MONITORS: The Clubs will have assigned throughout the duration of The Event "COVID-19 Monitors", including before and after The Event for set up and break down, who will be responsible for the following:
  - a. Ensuring that all Exhibitors and Attendees are in compliance with the mask-wearing requirement set forth in Paragraph 6 above;
  - b. Ensuring that all Exhibitors and Attendees are wearing a wrist band or sticker as provided to them to indicate that The Clubs have a signed Waiver on file for that individual; and
  - c. Providing the COVID-19 Event Waiver to those who need to execute it prior to entry into The Event facilities.
8. SANITIZING STATIONS: Sanitizing stations will be placed throughout the Event facilities, which will include disinfecting wipes and/or hand sanitizer.
9. CRATING: Dogs may only be crated ringside 15 minutes prior to, and during judging, and dogs shall not be permitted to be crated anywhere else on The Event or facility premises, with the exception of automobiles or under personal canopies set-up six (6) feet apart or in small "family units" outside in Parking Lots A & C. Ringside crates must have the recommended spacing of six (6) feet between them. No blow dryers will be permitted ringside or anywhere else inside a building throughout The Event facilities.
10. ARM BANDS: You must know your arm band number and have a wrist band or sticker before picking up your arm band. A table will be provided, and the arm bands laid out in advance of each class. Remember to maintain social distancing guidelines while you are obtaining your arm bands.
11. ENTRANCE AND EXIT FROM THE EVENT FACILITIES:
  - a. On the first day of the Exhibitor's and Attendee's attendance at The Event, it must be confirmed that all Exhibitors and Attendees to The Event have signed the "COVID-19 Event Waiver." Entry will be denied to anyone refusing to sign the Waiver.
  - b. Once it has been confirmed that The Clubs have a signed waiver for the Exhibitor and/or Attendee, the Exhibitor and/or Attendee will be issued a wristband/sticker to wear for the duration of the event. If that wristband/sticker is lost or if it comes off, please return to the COVID-19 monitor to obtain another wristband.
12. HAND WASHING: As always, washing your hands frequently and thoroughly and not touching your face decrease the spread of germs. Continual hand washing throughout the day by Exhibitors and/or Attendees is encouraged. The restroom area will provide a wash station, hand sanitizer and paper towels for drying your hands. The Clubs also suggest that Exhibitors and/or Attendees keep a supply of sanitizing wipes and an alcohol-based hand sanitizer with them and use those items as necessary.
13. RING ENTRY/EXIT: The ring will have a separate entrance and exit, clearly marked. Markings will be placed to assist exhibitors with proper distancing while in the ring.

**THE TACOMA KENNEL CLUB, INC., AND THE CLUBS  
SPONSORING THE ASSOCIATED EVENTS  
RESERVE THE RIGHT TO IMPLEMENT  
ADDITIONAL PRECAUTIONARY MEASURES  
THEY DEEM NECESSARY.**

**NO WRISTBAND • NO SHOW • NO EXCEPTIONS**



**TACOMA KENNEL CLUB, INC.**

**COVID-19 EVENT WAIVER • APRIL 24 & 25, 2021**

ALL ENTRANTS TO THE TACOMA DOME FOR ANY AND ALL OF THE TACOMA KENNEL CLUB, INC., AND ASSOCIATED EVENTS HELD FROM APRIL 24 & 25, 2021 (HEREINAFTER "THE EVENT") MUST COMPLETE AND SIGN THIS COVID-19 EVENT WAIVER ("WAIVER") BEFORE ATTENDANCE AT THE EVENT IS PERMITTED. THERE WILL BE NO EXCEPTIONS.

THIS IS FOR EXHIBITORS, OWNERS, HANDLERS, BREEDERS, ASSISTANTS, FAMILY MEMBERS, JUDGES, FRIENDS, VOLUNTEERS, MINOR CHILDREN, COMMITTEE MEMBERS AND ANYONE ELSE WHO ENTERS THE TACOMA DOME DURING THE EVENT.

IF YOU ARE ON THE TACOMA DOME SITE THIS FORM MUST BE ON FILE.

My signature below confirms that I voluntarily attest, to the best of my knowledge, that at the time of signing this Waiver, I: (1) do not have COVID-19; and (2) have not been in contact with or exposed to any known carrier of COVID-19 within the past 14 days. I further attest that I am not currently displaying or feeling symptoms of COVID-19 (including, but not limited to, coughing, sneezing, elevated temperature, or any other symptom(s) that the United States Center for Disease Control has attributed to COVID-19).

My signature below confirms that I will follow all guidelines set in place by the Tacoma Kennel Club, Inc., and the Clubs sponsoring the associated events (hereinafter "The Clubs") throughout my attendance at The Event held at The Tacoma Dome. The guidelines to The Event are described in Exhibit A to this Waiver and is attached to and incorporated into this Waiver.

I fully acknowledge that an inherent risk of exposure to COVID-19 exists in any public or private place where people are present. I further acknowledge that I am attending The Event entirely at my own risk and take full responsibility for my own health and safety, and the health and safety of any minor children or adults for whom I am responsible at The Event.

I fully submit that The Clubs, their members, their Boards of Directors, committee members, volunteers and/or workers at The Event, and any other individuals involved with conducting and organizing The Event shall not be held liable for any present or future COVID-19 exposure (including, but not limited to, any subsequent illness) incurred at any time by any person, in attendance or not in attendance at The Event, during or after The Event, and hereby waive all rights to bring any claims, charges, lawsuits or other legal actions against The Clubs, their members, their Boards of Directors, committee members, volunteers and/or workers at The Event, and any other individuals involved with conducting and organizing The Event if I am exposed to or contract COVID-19.

By signing this Waiver, I hereby agree to the terms of this Waiver, including the guidelines provided in Exhibit A, and all other conditions that may be applicable at the time of The Event.

_____ Signature	_____ Signature of Parent or Legal Guardian (For any minor child under your care at The Event)
_____ Print Name	_____ Name of Minor Child
_____ Date	_____ Date
For purposes of contact tracing, if necessary, please provide the following:	
Address: _____	
City, State, Zip _____	Phone: _____
Email: _____	

PLEASE PRINT & COMPLETE THIS FORM.

BRING THE ORIGINAL TO THE EVENT. IT MUST BE DATED NO MORE THAN 24 HOURS BEFORE YOU ARRIVE. YOU ARE RESPONSIBLE FOR COMPLETING THIS FORM. FAILURE TO PROVIDE THE CLUBS WITH A FULLY EXECUTED VERSION OF THIS FORM AT THE EVENT WILL PROHIBIT YOU FROM ATTENDING THE EVENT. THERE WILL BE NO EXCEPTIONS.

**Substitution of Judges – Both Days**

**OFFICIAL NOTICE: SUBSTITUTION OF JUDGES** – Reference Chapter 7, Section 8 of AKC Rules and Chapter 1, Section 26 of Obedience Regulations: Owner has the right to withdraw his entry and have his entry fee refunded provided notification of his withdrawal is received no later than one half-hour prior to the start of any regular judging.  
**MRS. FAYE STRAUSS AND MRS. PAT PUTMAN WILL BE UNABLE TO FULFILL THEIR ASSIGNMENTS. THE FOLLOWING CHANGES HAVE BEEN MADE.**

**SATURDAY**

- NEW SCHEDULED JUDGE - KATHLEEN J. BROCK:** Sporting Group, Barbet, Lagotto Romagnolo, Nederlandse Kooikerhondie, Chesapeake Bay Retriever, Labrador Retriever, Nova Scotia Duck Tolling Retriever, English Setter, Irish Setter, Irish Red & White Setter, American Water Spaniel, Boykin Spaniel, Clumber Spaniel, Spinone Italiano, Vizsla, Weimaraner, Wirehaired Pointing, Griffon, Wirehaired Vizsla, Beagle (13"), Beagle(15").
- NEW SCHEDULED JUDGE - EMILY FISH BARNHART:** NOHS Sporting Group
- NEW SCHEDULED JUDGE - CHRISTIE MARTINEZ:** NOHS Terrier Group, NOHS Toy Group, Puppy Sporting Group, Puppy Best in Show, Pug, American Eskimo Dogs, Chow Chow, Lhasa Apso.
- NEW SCHEDULED JUDGE - JANE E TREIBER:** Anatolian Shepherd Dog.
- NEW SCHEDULED JUDGE - MARILYN VAN VLEIT:** Herding Group, NOHS Working Group, Australian Cattle Dogs, Bearded Collies, Beauceron, Belgian Laeknois, Belgian Malinois, Belgian Sheepdogs, Bergamasco Sheepdog, Berger Picard, Border Collie, Briard, Canaan Dog, Cardigan Welsh Corgi, Entlebucher Mountain Dog, Finnish Lapphund, German Shepherd Dog, Icelandic Sheepdog, Miniature American Shepherd, Norwegian Buhund, Old English Sheepdog, Polish Lowland Sheepdog.
- NEW SCHEDULED JUDGE - LEE WHITTIER:** Brussels Griffons, Havanese, Shih Tzu, Silky Terr, Toy Fox Terr.
- NEW SCHEDULED JUDGE - R.C. WILLIAMS:** Toy Poodles, Boston Terriers, Bulldog, Miniature Poodle, Standard Poodle.

**SUNDAY**

- NEW SCHEDULED JUDGE - SANDRA BINGHAM-PORTER:** Non-Sporting Group, Bred by Exhibitor Best in Show, Finnish Spitz.
- NEW SCHEDULED JUDGE - CHRISTIE MARTINEZ:** Bred by Exhibitor Sporting Group, Vizsla, Affenpinscher, Chinese Crested, English Toy Spaniel (BL&PC), English Toy Spaniel (KC&R), Japanese Chin, Pekingese, Pomeranian, Coton de Tulear.
- NEW SCHEDULED JUDGE - JANE E TREIBER:** NOHS Non-Sporting Group, Komondor, Leonberger, Neapolitan Mastiff, Portuguese Water Dog, Rottweiler, St. Bernard, Samoyed, Siberian Husky, Standard Schnauzer, Tibetan Mastiff
- NEW SCHEDULED JUDGE - MARILYN VAN VLEIT:** NOHS Hound Group, NOHS Toy Group, Bred-by-Exhibitor Working Group, Bred by Exhibitor Herding Group, Belgian Tervuren, Bred by Exhibitor Working Group, Bred by Exhibitor Herding Group, Australian Shepherd, Belgian Tervuren, Rough Collie, Smooth Collie, Puli, Pumi, Pyrenean Shepherd, Shetland Sheepdog, Spanish Water Dog, Swedish Vallhund.
- NEW SCHEDULED JUDGE - LEE WHITTIER:** Toy Group, Spinone Italiano, Wirehaired Pointing Griffon.
- NEW SCHEDULED JUDGE - WOOD WORNALL:** Terrier Group.

**SUNDAY - JUDGE OVERLOAD**

BREEDS	Reg. Judge	Sub. Judge
Dachshunds Longhaired, Smooth & Wirehaired, Cairn Terriers & Rat Terriers	R C Williams	Lee Whittier

# TACOMA PROGRAM OF JUDGING

## SATURDAY, APRIL 24, 2021

There are 1008 dogs entered in this show with a total entry of 1089

ENTRIES: 929 Conformation • 28 Jr. Showmanship, 68 Obedience, 64 Rally

For your convenience, the following division of sexes has been carefully tabulated; however, neither the Club nor the Superintendent assumes responsibility for absolute accuracy. The number before each Breed (Variety) indicates the number of dogs entered in that Breed (Variety). The numbers following each Breed (Variety) indicate the number of Regular Class Dogs, Regular Class Bitches, Non-Regular Class Dogs or Bitches, and Best of Breed (Variety) (Dogs/Bitches).

OFFICIAL JUDGE SUBSTITUTIONS ARE LISTED ON PAGE 4 FOR BOTH DAYS.

**EXHIBITORS PLEASE NOTE: THIS SCHEDULE IS BASED ON AN AVERAGE OF 20 DOGS PER HOUR, INSTEAD OF THE USUAL 25. THIS IS TO ACCOMMODATE A MORE ORDERLY INGRESS AND EGRESS OF DOGS AND PEOPLE AT EACH BREAK. PLEASE COOPERATE!**

### SATURDAY VARIETY GROUPS

Variety Groups will be in Rings 1 & 2 and will begin no earlier than 3:15PM. Group Order will be announced at 2:45PM. Tentative Group Order:

TERRIER GROUP..... R C Williams  
SPORTING GROUP..... Kathleen J Brock  
HOUND GROUP..... Barbara J O'Neill  
HERDING GROUP..... Marilyn Van Vleit\*  
WORKING GROUP..... Jane E Treiber  
TOY GROUP..... Sandra Bingham-Porter  
NON-SPORTING GROUP..... Lee Whittier  
BEST IN SHOW SATURDAY..... Wood Wornall

### SATURDAY NOHS GROUPS

NOHS Groups will follow their respective groups in Rings 3 & 4. Tentative Group Order:

NOHS TERRIER GROUP..... Christie Martinez  
NOHS SPORTING GROUP..... Emily (Fish) Barnhart  
NOHS HOUND GROUP..... Jane E Treiber  
NOHS HERDING GROUP..... R C Williams  
NOHS WORKING GROUP..... Marilyn Van Vleit  
NOHS TOY GROUP..... Christie Martinez  
NOHS NON-SPORTING GROUP..... R C Williams  
NOHS BEST IN SHOW..... Sandra Bingham-Porter

### SATURDAY PUPPY GROUPS

Puppy Groups will follow their respective NOHS groups in Ring 5. Tentative Group Order:

PUPPY TERRIER GROUP..... Sandra Bingham-Porter  
PUPPY SPORTING GROUP..... Christie Martinez  
PUPPY NOHS HOUND..... Ms Diane McCarty  
PUPPY HERDING GROUP..... Emily (Fish) Barnhart  
PUPPY WORKING GROUP..... Jane E Treiber  
PUPPY TOY GROUP..... Wood Wornall  
PUPPY NON-SPORTING..... R C Williams  
PUPPY BEST IN SHOW..... Christie Martinez

### RING 1 – SANDRA BINGHAM-PORTER 120

8:00AM  
12 Dalmatians\* ..... 2-3-4/3  
4 Schipperkes\* ..... 1-3-0/0  
4 Chihuahuas (Long Coat) ..... 2-1-1/0

9:00AM  
20 Cavalier King Charles Spaniels ..... 10-6-1/2

10:00AM  
5 Chinese Crested ..... 3-1-0/1  
1 Maltese ..... 1-0-0/0  
4 Pekingese ..... 1-1-2/0  
2 Pomeranians ..... 0-2-0/0  
2 Coton de Tulear\* ..... 0-1-0/1  
7 Yorkshire Terriers ..... 2-3-1/1

11:00AM  
17 French Bulldogs\* ..... 6-10-1/0  
2 Lowchen\* ..... 0-2-0/0

LUNCH  
12:45PM

11 Italian Greyhounds ..... 1-6-2/2  
1:15PM  
29 Papillons ..... 14-11-3/1

### RING 2 – WOOD WORNALL – 98

8:00AM  
1 American Hairless Terriers ..... 0-0-1/0  
11 Rat Terriers ..... 2-7-1/0  
1 Russell Terriers ..... 0-1-0/0  
4 Fox Terriers (Smooth) ..... 1-0-1/2  
3 Australian Terriers ..... 0-3-0/0

9:00AM  
1 Parson Russell Terriers ..... 1-0-0/0  
8 Cairn Terriers ..... 3-2-1/2  
1 Dandie Dinmont Terriers ..... 1-0-0/0  
5 Glen of Imaal Terriers ..... 1-1-1/2  
5 Miniature Schnauzers ..... 0-3-1/1

### 10:00AM

4 Norwich Terriers ..... 1-1-2/0  
3 Scottish Terriers ..... 1-1-0/1  
5 Welsh Terriers ..... 1-4-0/0  
5 Miniature Bull Terriers ..... 0-2-1/1  
1 Irish Terriers ..... 1-0-0/0  
3 American Staffordshire Terriers ..... 1-1-1/0

### 11:00AM

6 Spaniels (English Springer) ..... 4-0-0/2  
13 Staffordshire Bull Terriers ..... 5-5-3/0  
1 Pointers ..... 0-0-0/1

### LUNCH

### 12:45PM

17 Retrievers (Golden) ..... 6-10-0/1

### RING 3 – MARILYN VAN VLEIT – 82

8:00AM  
3 Finnish Lapphunds ..... 2-1-0/0  
10 Icelandic Sheepdogs ..... 4-2-3/1  
3 Norwegian Buhunds ..... 0-1-1/1  
4 German Shepherd Dogs ..... 2-2-0/0

### 9:00AM

5 Beaucerons\* ..... 3-1-0/1  
5 Australian Cattle Dogs ..... 2-2-0/1

### 9:30AM

2 Belgian Malinois ..... 0-2-0/0  
1 Belgian Sheepdogs ..... 1-0-0/0  
1 Berger Picards ..... 0-0-1/0  
16 Old English Sheepdogs ..... 4-8-3/0

### 10:30AM

17 Cardigan Welsh Corgis ..... 7-8-0/2  
8 Miniature American Shepherds ..... 3-4-0/1  
7 Bearded Collies ..... 1-4-1/1

### RING 3 – JANE TREIBER – 59

12:00PM  
12 Border Terriers\* ..... 4-7-0/1  
11 Shiba Inu\* ..... 3-6-2/0

### 1:15PM

12 Spaniels (Welsh Springer) \* ..... 4-4-2/2  
1 Spaniels (Irish Water) \* ..... 0-1-0/0  
1 Black and Tan Coonhounds ..... 0-1-0/0

### 2:00PM

5 Retrievers (Flat-Coated) \* ..... 2-2-1/0  
8 Irish Wolfhounds ..... 3-4-0/1  
3 Pharaoh Hounds ..... 1-1-0/1  
6 Salukis ..... 1-2-2/1

### RING 4 – KATHLEEN BROCK – 77

8:00AM  
3 Retrievers (Nova Scotia Duck Tolling) ..... 1-2-0/0  
2 Spaniels (Clumber) ..... 1-1-0/0  
2 Nederlandse Kooikerhondjes ..... 1-1-0/0  
2 Beagles (over 13 in.) ..... 1-0-1/0  
8 Setters (English) ..... 3-3-1/1  
2 Setters (Irish Red and White) ..... 2-0-0/0  
1 Spinoni Italiani ..... 0-0-1/0

### 9:00AM

31 Retrievers (Labrador) ..... 13-15-3/0

### 10:30AM

6 Retrievers (Chesapeake Bay) ..... 2-3-0/1  
11 Vizslas ..... 4-4-2/1  
8 Weimaraners ..... 2-3-1/2  
1 Wirehaired Pointing Griffons ..... 0-1-0/0

### RING 4 EMILY BARNHART – 74

11:50AM  
24 Australian Shepherds ..... 9-12-2/1

### 1:00PM

7 Pointers (German Shorthaired) \* ..... 3-2-2/0  
1 Belgian Tervuren ..... 0-0-1/0  
4 Collies (Rough) \* ..... 1-3-0/0  
3 Collies (Smooth) \* ..... 1-2-0/0

### 1:45PM

21 Pembroke Welsh Corgis ..... 8-12-1/0  
9 Shetland Sheepdogs ..... 2-5-0/2  
2 Swedish Vallhunds ..... 1-1-0/0  
3 Spanish Water Dogs\* ..... 1-2-0/0

### RING 5 – CHRISTIE MARTINEZ – 87

### 8:00AM

20 Pugs ..... 6-11-3/0

### 9:00AM

2 Dachshunds (Longhaired) ..... 0-1-1/0  
4 Dachshunds (Smooth) ..... 1-1-0/2  
2 Dachshunds (Wirehaired) ..... 1-1-0/0  
8 Lhasa Apsos ..... 3-3-2/0  
4 Alaskan Malamutes ..... 2-1-0/1

### 10:00AM

15 Brittanys ..... 8-5-0/2  
2 Greyhounds\* ..... 0-1-0/0  
1 Scottish Deerhounds\* ..... 0-1-0/0  
2 Portuguese Water Dogs ..... 1-1-0/0

### 11:00AM

13 Borzois ..... 6-4-1/2  
14 Rhodesian Ridgebacks ..... 4-8-2/0

### RING 5 – OPEN SHOW #1 – 18 ENTRIES

12:30PM ..... SEE OPEN SHOW JUDGING PROGRAM

### RING 6 – DIANA MCCARTY – 28 OF 91

### 8:00AM

28 Junior Showmanship ..... 3ni-2ns-1oj-15oi-7os

### RING 6 – COCKER CONCURRENT SPECIALTY – 37

9:30AM ..... SEE COCKER JUDGING PROGRAM

### RING 6 – DIANA MCCARTY – 53 OF 99

### 12:00PM

16 Basenjis ..... 4-9-1/2  
3 Bloodhounds ..... 1-1-1/0

### 1:00PM

12 Basset Hounds ..... 3-6-2/1

### 1:45PM

22 Whippets ..... 7-13-0/2

### RING 6 – OPEN SHOW #2 – 18

3:00PM ..... SEE OPEN SHOW JUDGING PROGRAM

### RING 7 – R.C. WILLIAMS – 122

### 8:00AM

11 Bullmastiffs ..... 1-2-7/1  
3 Boxers ..... 0-3-0/0  
4 Cane Corso ..... 3-0-0/1  
2 Black Russian Terriers\* ..... 2-0-0/0

### 9:00AM

10 Leonbergers ..... 7-1-1/1  
8 Mastiffs ..... 1-5-0/2  
1 Chinooks\* ..... 0-1-0/0  
1 Akitas ..... 0-1-0/0

### 10:00AM

12 Great Danes ..... 4-4-4/0  
5 German Pinschers\* ..... 2-2-1/0  
10 Newfoundland ..... 2-7-1/0

### 11:20AM

18 Bernese Mountain Dogs ..... 7-6-2/3

### LUNCH

### 1:00PM

12 Poodles (Standard) ..... 4-5-2/1  
1 Standard Schnauzers ..... 1-0-0/0  
7 Bulldogs ..... 5-1-1/0

### 2:00PM

4 Poodles (Miniature) ..... 1-2-1/0  
13 Boston Terriers ..... 5-4-4/0

### RING 8 – LEE WHITTIER – 61 OF 157

### 8:00AM

17 Doberman Pinschers ..... 5-11-1/0  
4 Pointers (German Wirehaired)\* ..... 0-2-1/1

### 9:00AM

7 Rottweilers ..... 2-4-0/1  
12 Great Pyrenees ..... 4-7-1/0  
1 Samoyeds ..... 0-1-0/0

### 10:00AM

5 Siberian Huskies ..... 2-1-0/2  
7 Bouviers des Flandres ..... 2-4-0/1  
1 Afghan Hounds ..... 1-0-0/0  
7 Bichons Frises ..... 4-2-0/1

**RING 8 – LEE WHITTIER –17**

**11:00AM**..... PUG CONCURRENT SPECIALTY  
.....See Pug Judging Program

**RING 8 – KRYSTAL EINOWSKI – 7**

**12:00PM**..... PUG SWEEPSTAKES  
.....See Pug Judging Program

**RING 8 – LEE WHITTIER – 96 OF 157**

**12:45PM**

8 Keeshonden ..... 3-2-1/2  
12 Saint Bernards ..... 3-5-3/1

**1:45PM**

7 Spaniels (Cocker) ASCOB\* ..... 2-3-1/1  
11 Spaniels (Cocker) Black\* ..... 5-5-1/0  
10 Spaniels (Cocker) Parti\* ..... 1-4-4/1  
3 Spaniels (English Cocker)\* ..... 1-2-0/0

**3:00PM**

11 Greater Swiss Mountain Dogs ..... 2-9-0/0  
6 Biewer Terriers ..... 3-2-0/1  
6 Brussels Griffons ..... 3-2-1/0

**4:00PM**

11 Havanese ..... 2-5-3/1  
6 Shih Tzu ..... 3-2-0/1  
1 Toy Fox Terriers ..... 0-1-0/0  
4 Tibetan Spaniels ..... 0-2-1/1

**RING 9 – SUE COX – 32**

**8:00AM**

7 Obed. Beginner Novice A [1101], 1701-1706

**8:45AM**

5 Obed. Beginner Novice B ..... 1741-1743,  
1745-1746

**9:30AM**

4 Obed. Utility Class A ..... 1502-1504, 1506

**10:15AM**

7 Obed. Open Class B ..... 1401-1402, P1941,  
1403-1406, 1408-1409

1 Preferred Open ..... See Above

**11:30AM**

8 Obed. Novice Class A ..... 1101-1108

**RING 10 – DAWN ANTONIAK-MITCHELL – 36**

**8:00AM**

1 Obed. Versatility\* ..... 1505

**8:15AM**

9 Obed. Utility Class B\* ..... 1601-1602,  
[1402-1405, 1408], 1603, [1409]

**9:45AM**

4 Obed. Open Class A ..... 1301-1304

**10:20AM**

3 Obed. Preferred Novice ..... [1205], P1743,  
P1745

**10:45AM**

19 Obed. Novice Class B ..... 1201-1218, 1221

**RING 11 – KATHLEEN GALOTTI – 64**

**8:00AM**

10 Rally Master ..... 2801, [2502-2504], 2802,  
[2509-2511, 2514, 2517]

**8:45AM**

15 Rally Excellent B ..... [2501-2505, 2509-2510],  
2701, [2511, 2513-2514, 2517], 2702-2704

1 Rally Excellent A ..... 2601

**10:00AM**

16 Rally Advanced B ..... 2501-2515, 2517

3 Rally Advanced A ..... 2401-2403

**11:15AM**

6 Rally Intermediate ..... 2301-2304, 2306-2307

**11:45AM**

4 Rally Novice B ..... 2201-2203, 2205

9 Rally Novice A ..... 2101, 2103-2110

**INDEX OF BREEDS – SATURDAY**

This index has been prepared to enable exhibitors to (1) identify the Ring(s) in which their Breed(s) is (are) to be judged and (2) have an approximation of the number of dogs entered. The entry figures are not to be taken as a representation on the part of the Superintendent that all dogs entered will be present on the Show day. If there are any discrepancies between the ring schedule and this Index, the ring schedule governs.

#	BREED	R	TIME
1	AFGHAN HOUNDS	8	10:00AM
1	AKITAS	7	9:00AM
4	ALASKAN MALAMUTES	5	9:00AM
1	AMERICAN HAIRLESS TERRIERS	2	8:00AM
3	AMERICAN STAFFORDSHIRE TERRIERS	2	10:00AM
5	AUSTRALIAN CATTLE DOGS	3	9:00AM
24	AUSTRALIAN SHEPHERDS	4	11:50AM
3	AUSTRALIAN TERRIERS	2	8:00AM
16	BASENJIS	6	12:00PM
12	BASSET HOUNDS	6	1:00PM
2	BEAGLES (OVER 13 IN.)	4	8:00AM
7	BEARDED COLLIES	3	10:30AM
5	BEAUCERONS	3	9:00AM
2	BELGIAN MALINOIS	3	9:30AM
1	BELGIAN SHEEPDOGS	3	9:30AM
1	BELGIAN TERVUREN	4	1:00PM
1	BERGER PICARDS	3	9:30AM
18	BERNESE MOUNTAIN DOGS	7	11:20AM
7	BICHONS FRISES	8	10:00AM
6	BIEWER TERRIERS	8	3:00PM
1	BLACK AND TAN COONHOUNDS	3	1:15PM
2	BLACK RUSSIAN TERRIERS	7	8:00AM
3	BLOODHOUNDS	6	12:00PM
12	BORDER TERRIERS	3	12:00PM
13	BORZOIS	5	11:00AM
13	BOSTON TERRIERS	7	2:00PM
7	BOUVIERS DES FLANDRES	8	10:00AM
3	BOXERS	7	8:00AM
15	BRITTANYS	5	10:00AM
6	BRUSSELS GRIFFONS	8	3:00PM
7	BULLDOGS	7	1:00PM
11	BULLMASTIFFS	7	8:00AM
8	CAIRN TERRIERS	2	9:00AM
4	CANE CORSO	7	8:00AM
17	CARDIGAN WELSH CORGIS	3	10:30AM
20	CAVALIER KING CHARLES SPANIELS	1	9:00AM
4	CHIHUAHUAS (LONG COAT)	1	8:00AM
5	CHINESE CRESTED	1	10:00AM
1	CHINOOKS	7	9:00AM
4	COLLIES (ROUGH)	4	1:00PM
3	COLLIES (SMOOTH)	4	1:00PM
2	COTON DE TULEAR	1	10:00AM
2	DACHSHUNDS (LONGHAIRED)	5	9:00AM
2	DACHSHUNDS (SMOOTH)	5	9:00AM
2	DACHSHUNDS (WIREHAIRED)	5	9:00AM
12	DALMATIANS	1	8:00AM
1	DANDIE DINMONT TERRIERS	2	9:00AM
17	DOBERMAN PINSCHERS	8	8:00AM
3	FINNISH LAPPHUNDS	3	8:00AM
4	FOX TERRIERS (SMOOTH)	2	8:00AM
17	FRENCH BULLDOGS	1	11:00AM
5	GERMAN PINSCHERS	7	10:00AM
4	GERMAN SHEPHERD DOGS	3	8:00AM
5	GLEN OF IMAAL TERRIERS	2	9:00AM
12	GREAT DANES	7	10:00AM
12	GREAT PYRENEES	8	9:00AM
11	GREATER SWISS MOUNTAIN DOGS	8	3:00PM
2	GREYHOUNDS	5	10:00AM
11	HAVANESE	8	4:00PM
10	ICELANDIC SHEEPDOGS	3	8:00AM
1	IRISH TERRIERS	2	10:00AM
8	IRISH WOLFHOUSES	3	2:00PM
11	ITALIAN GREYHOUNDS	1	12:45PM
28	JUNIOR SHOWMANSHIP	6	8:00AM
8	KEESHONDEN	8	12:45PM
10	LEONBERGERS	7	9:00AM
8	LHASA APSOS	5	9:00AM
2	LOWCHEN	1	11:00AM
1	MALTESE	1	10:00AM
8	MASTIFFS	7	9:00AM
8	MINIATURE AMERICAN SHEPHERDS	3	10:30AM
5	MINIATURE BULL TERRIERS	2	10:00AM
5	MINIATURE SCHNAUZERS	2	9:00AM
2	NEDERLANDSE KOOIKERHONDJES	4	8:00AM
10	NEWFOUNDLANDS	7	10:00AM
3	NORWEGIAN BUHUNDS	3	8:00AM

#	BREED	R	TIME
4	NORWICH TERRIERS	2	10:00AM
16	OLD ENGLISH SHEEPDOGS	3	9:30AM
29	PAPILLONS	1	1:15PM
1	PARSON RUSSELL TERRIERS	2	9:00AM
4	PEKINGESE	1	10:00AM
21	PEMBROKE WELSH CORGIS	4	1:45PM
3	PHARAOH HOUNDS	3	2:00PM
1	POINTERS	2	11:00AM
7	POINTERS (GERMAN SHORTHAIRED)	4	1:00PM
4	POINTERS (GERMAN WIREHAIRED)	8	8:00AM
2	POMERANIANS	1	10:00AM
4	POODLES (MINIATURE)	7	2:00PM
12	POODLES (STANDARD)	7	1:00PM
2	PORTUGUESE WATER DOGS	5	10:00AM
1	PREFERRED OPEN		10:15AM
20	PUGS	5	8:00AM
11	RAT TERRIERS	2	8:00AM
6	RETRIEVERS (CHESAPEAKE BAY)	4	10:30AM
5	RETRIEVERS (FLAT-COATED)	3	2:00PM
17	RETRIEVERS (GOLDEN)	2	12:45PM
31	RETRIEVERS (LABRADOR)	4	9:00AM
3	RETRIEVERS (NOVA SCOTIA DUCK TOLL)	4	8:00AM
14	RHODESIAN RIDGEBACKS	5	11:00AM
7	ROTTWEILERS	8	9:00AM
1	RUSSELL TERRIERS	2	8:00AM
12	SAINT BERNARDS	8	12:45PM
6	SALUKIS	3	2:00PM
1	SAMOYEDS	8	9:00AM
4	SCHIPPERKES	1	8:00AM
1	SCOTTISH DEERHOUNDS	5	10:00AM
3	SCOTTISH TERRIERS	2	10:00AM
8	SETTERS (ENGLISH)	4	8:00AM
2	SETTERS (IRISH RED AND WHITE)	4	8:00AM
9	SHETLAND SHEEPDOGS	4	1:45PM
11	SHIBA INU	3	12:00PM
6	SHIH TZU	8	4:00PM
5	SIBERIAN HUSKIES	8	10:00AM
2	SPANIELS (CLUMBER)	4	8:00AM
7	SPANIELS (COCKER) ASCOB	8	1:45PM
11	SPANIELS (COCKER) BLACK	8	1:45PM
10	SPANIELS (COCKER) PARTI	8	1:45PM
3	SPANIELS (ENGLISH COCKER)	8	1:45PM
6	SPANIELS (ENGLISH SPRINGER)	2	11:00AM
1	SPANIELS (IRISH WATER)	3	1:15PM
12	SPANIELS (WELSH SPRINGER)	3	1:15PM
3	SPANISH WATER DOGS	4	1:45PM
1	SPINONI ITALIANI	4	8:00AM
13	STAFFORDSHIRE BULL TERRIERS	2	11:00AM
1	STANDARD SCHNAUZERS	7	1:00PM
2	SWEDISH VALLHUNDS	4	1:45PM
4	TIBETAN SPANIELS	8	4:00PM
1	TOY FOX TERRIERS	8	4:00PM
11	VIZSLAS	4	10:30AM
8	WEIMARANERS	4	10:30AM
5	WELSH TERRIERS	2	10:00AM
22	WHIPPETS	6	1:45PM
1	WIREHAIRED POINTING GRIFFONS	4	10:30AM
7	YORKSHIRE TERRIERS	1	10:00AM
7	OBED. BEGINNER NOVICE A	9	8:00AM
5	OBED. BEGINNER NOVICE B	9	8:45AM
8	OBED. NOVICE CLASS A	9	11:30AM
19	OBED. NOVICE CLASS B	10	10:45AM
4	OBED. OPEN CLASS A	10	9:45AM
7	OBED. OPEN CLASS B	9	10:15AM
3	OBED. PREFERRED NOVICE	10	10:20AM
4	OBED. UTILITY CLASS A	9	9:30AM
9	OBED. UTILITY CLASS B	10	8:15AM
1	OBED. VERSATILITY	10	8:00AM
3	RALLY ADVANCED A	11	10:00AM
16	RALLY ADVANCED B	11	10:00AM
1	RALLY EXCELLENT A	11	8:45AM
15	RALLY EXCELLENT B	11	8:45AM
6	RALLY INTERMEDIATE	11	11:15AM
10	RALLY MASTER	11	8:00AM
9	RALLY NOVICE A	11	11:45AM
4	RALLY NOVICE B	11	11:45AM

# TACOMA PROGRAM OF JUDGING SUNDAY, APRIL 25, 2021

There are 987 dogs entered in this show with a total entry of 1062  
ENTRIES: 931 Conformation • 30 Jr. Showmanship, 53 Obedience, 48 Rally

For your convenience, the following division of sexes has been carefully tabulated; however, neither the Club nor the Superintendent assumes responsibility for absolute accuracy. The number before each Breed (Variety) indicates the number of dogs entered in that Breed (Variety). The numbers following each Breed (Variety) indicate the number of Regular Class Dogs, Regular Class Bitches, Non-Regular Class Dogs or Bitches, and Best of Breed (Variety) (Dogs/Bitches).

**OFFICIAL JUDGE SUBSTITUTIONS ARE LISTED ON PAGE 4 FOR BOTH DAYS.**  
**EXHIBITORS PLEASE NOTE: THIS SCHEDULE IS BASED ON AN AVERAGE OF 20 DOGS PER HOUR, INSTEAD OF THE USUAL 25. THIS IS TO ACCOMMODATE A MORE ORDERLY INGRESS AND EGRESS OF DOGS AND PEOPLE AT EACH BREAK. PLEASE COOPERATE!**

## SUNDAY VARIETY GROUPS

Variety Groups will be in Rings 1 & 2 and will begin no earlier than 3:15PM. Group Order will be announced at 2:45PM. Tentative Group Order:

SPORTING GROUP ..... Karen M Ericson  
HERDING GROUP ..... Emily (Fish) Barnhart\*  
HOUND GROUP ..... Jane E Treiber  
NON-SPORTING ..... Sandra Bingham-Porter\*  
WORKING GROUP ..... R C Williams\*  
TOY GROUP ..... Lee Whittier  
TERRIER GROUP ..... Wood Wornall  
BEST IN SHOW ..... Christie Martinez

## SUNDAY NOHS GROUPS

NOHS Groups will be in Rings 3 & 4 and will begin no earlier than 2:45PM. Group Order will be announced at 2:15PM. Tentative Group Order:

NOHS TOY GROUP ..... Marilyn Van Vleit  
NOHS WORKING GROUP ..... Karen M Ericson  
NOHS HOUND GROUP ..... Marilyn Van Vleit  
NOHS SPORTING GROUP ..... Lee Whittier  
NOHS NON-SPORTING GROUP ..... Jane E Treiber  
NOHS HERDING GROUP ..... Lee Whittier  
NOHS TERRIER GROUP ..... R C Williams  
NOHS BEST IN SHOW ..... Wood Wornall

## SUNDAY BRED BY EXHIBITOR GROUPS

Bred by Exh. Groups will follow their respective NOHS groups in Ring 6. Tentative Group Order:

BRED BY EX. TOY GROUP ..... Emily (Fish) Barnhart  
BRED BY EX. WORKING GROUP ..... Marilyn Van Vleit  
BRED BY EX. NOHS HOUND GROUP ..... Lee Whittier  
BRED BY EX. SPORTING GROUP ..... Christie Martinez  
BRED BY EX. NON-SPORT ..... Sandra Bingham-Porter  
BRED BY EX. HERDING GROUP ..... Marilyn Van Vleit  
BRED BY EX. TERRIER GROUP ..... Karen M Ericson  
BRED BY EX. BEST IN SHOW ..... Sandra Bingham-Porter

## RING 1 – CHRISTIE MARTINEZ – 103

8:00AM  
13 Vizslas ..... 5-4-2/2  
5 Salukis ..... 1-2-2/0  
3 Bloodhounds ..... 1-1-1/0

9:00AM  
1 Black and Tan Coonhounds ..... 0-1-0/0  
17 Retrievers (Golden) ..... 6-10-0/1  
3 Pharaoh Hounds ..... 1-1-0/1

10:00AM  
6 Biewer Terriers ..... 3-2-0/1  
4 Chihuahuas (Long Coat) ..... 2-1-1/0  
7 Chinese Crested ..... 3-3-0/1  
1 Maltese ..... 1-0-0/0  
2 Pomeranians ..... 0-2-0/0

11:00AM  
5 Pekingese ..... 1-1-3/0  
2 Coton de Tulear ..... 0-1-0/1  
2 Lowchen ..... 0-2-0/0  
4 Tibetan Spaniels ..... 0-2-1/1

LUNCH  
12:30PM  
28 Papillons ..... 12-11-3/1

## RING 1 – OPEN SHOW #2 – 15

1:45PM SEE OPEN JUDGING PROGRAM

## RING 2 – KAREN ERICSON – 63

8:00AM  
14 Brittans ..... 7-5-0/2  
2 Setters (Irish Red and White) ..... 2-0-0/0  
3 Spaniels (Irish Water) ..... 0-3-0/0

## 9:00AM

19 Bernese Mountain Dogs ..... 6-8-2/3  
2 Nederlandse Kooikerhondjes ..... 1-1-0/0

## 10:00AM

3 Retrievers (Nova Scotia Duck Tolling) 1-2-0/0  
8 Spaniels (English Springer) ..... 5-1-0/2  
12 Spaniels (Welsh Springer) ..... 4-4-2/2

## RING 2 – OPEN SHOW #1 – 15

11:15AM SEE OPEN SHOW JUDGING PROGRAM

## RING 2 – MARILYN VAN VLEIT – 48

12:15PM  
1 Belgian Tervuren ..... 0-0-1/0  
4 Collies (Rough) ..... 1-3-0/0  
3 Collies (Smooth) ..... 1-2-0/0  
8 Shetland Sheepdogs ..... 1-5-0/2  
2 Spanish Water Dogs ..... 1-1-0/0  
2 Swedish Vallhunds ..... 1-1-0/0

## 1:15PM

28 Australian Shepherds ..... 13-13-2/0

## RING 3 – EMILY BARNHART – 70

8:00AM  
3 Miniature American Shepherds ..... 3-4-0/1  
8 Finnish Lapphunds ..... 2-1-0/0  
10 Icelandic Sheepdogs ..... 4-2-3/1

## 9:00AM

2 Norwegian Buhunds ..... 0-1-1/0  
Setre43w21 ..... 5  
Australian Cattle Dogs ..... 2-2-0/1  
5 Beaucerons ..... 3-1-0/1  
2 Belgian Malinois ..... 0-2-0/0  
1 Belgian Sheepdogs ..... 1-0-0/0  
1 Berger Picards ..... 0-0-1/0  
4 German Shepherd Dogs ..... 2-2-0/0

## 10:00AM

7 Bouviers des Flandres ..... 2-4-0/1  
7 Bearded Collies ..... 1-4-1/1

## 10:45AM

15 Old English Sheepdogs ..... 4-8-2/0

## RING 3 – COCKER CONCURRENT SPECIALTY – 37

11:30AM SEE COCKER JUDGING PROGRAM

## RING 4 – JANE TREIBER – 120

8:00AM  
30 Junior Showmanship ....4ni-3ns-1oj-15oi-7os

## 9:30AM

15 Rhodesian Ridgebacks ..... 5-8-2/0  
1 Pointers ..... 0-0-0/1  
1 Samoyeds ..... 0-1-0/0  
2 Portuguese Water Dogs ..... 1-1-0/0

## 10:30AM

13 Saint Bernards ..... 3-5-3/2  
8 Leonbergers ..... 6-0-1/1

## 11:30AM

18 Doberman Pinschers ..... 6-11-1/0  
3 Spaniels (English Cocker) ..... 1-2-0/0

## LUNCH

1:15PM  
6 Rottweilers ..... 1-4-0/1  
10 Siberian Huskies ..... 4-4-0/2  
12 Basset Hounds ..... 3-6-2/1  
1 Standard Schnauzers ..... 1-0-0/0

## RING 5 – SANDRA BINGHAM-PORTER – 103

8:00AM  
7 Bulldogs ..... 5-1-1/0  
13 Boston Terriers ..... 5-4-4/0

## 9:00AM

20 Pugs ..... 6-11-3/0

## 10:00AM

13 Havanese ..... 3-5-3/2  
7 Shih Tzu ..... 3-2-1/1

## 11:00AM

1 Toy Fox Terriers ..... 0-1-0/0  
1 Poodles (Toy) ..... 0-1-0/0  
4 Poodles (Miniature) ..... 1-2-1/0  
7 Bichons Frises ..... 4-2-0/1  
8 Lhasa Apsos ..... 3-3-2/0

## LUNCH

## 12:45PM

11 Shiba Inu ..... 3-6-2/0  
11 Poodles (Standard) ..... 4-5-1/1

## RING 5 – PAUL CHEN – 33

## 2:00PM

14 Cardigan Welsh Corgis ..... 6-6-0/2  
19 Pembroke Welsh Corgis ..... 5-13-1/0

## RING 6 – WOOD WORNALL – 122

## 8:00AM

26 Retrievers (Labrador) ..... 11-11-3/1  
5 Pointers (German Wirehaired) ..... 1-2-1/1

## 9:30AM

10 Spaniels (Cocker) Parti ..... 1-4-4/1  
11 Spaniels (Cocker) Black ..... 5-5-1/0

## 10:30AM

7 Spaniels (Cocker) ASCOB ..... 2-3-1/1  
7 Pointers (German Shorthaired) ..... 3-2-2/0  
5 Retrievers (Flat-Coated) ..... 2-2-1/0

## 11:30AM

8 Setters (English) ..... 3-3-1/1  
7 Retrievers (Chesapeake Bay) ..... 2-4-0/1

## LUNCH

## 1:00PM

8 Weimaraners ..... 2-3-1/2  
7 Brussels Griffons ..... 4-2-1/0

## 1:45PM

19 Cavalier King Charles Spaniels ..... 10-5-1/2  
2 Spaniels (Clumber) ..... 1-1-0/0

## RING 7 – LEE WHITTIER – 125

## 8:00AM

11 Great Danes ..... 4-3-4/0  
1 Spinoni Italiani ..... 0-0-1/0  
1 Wirehaired Pointing Griffons ..... 0-1-0/0  
2 Greyhounds ..... 0-1-0/0  
1 Akitas ..... 0-1-0/0  
4 Cane Corso ..... 3-0-0/1

## 9:00AM

4 Alaskan Malamutes ..... 2-1-0/1  
2 Black Russian Terriers ..... 2-0-0/0  
3 Boxers ..... 0-3-0/0  
3 German Pinschers ..... 2-1-0/0  
8 Mastiffs ..... 1-5-0/2

## 10:00AM

1 Chinooks ..... 0-1-0/0  
3 Dachshunds (Longhaired) ..... 0-2-1/0  
5 Dachshunds (Smooth) ..... 1-1-1/2  
5 Dachshunds (Wirehaired) ..... 1-3-1/0  
5 Yorkshire Terriers ..... 1-3-1/0

## 11:00AM

12 Border Terriers ..... 3-8-0/1  
9 Newfoundlands ..... 1-7-1/0

## LUNCH

## 12:45PM

11 Rat Terriers ..... 2-7-1/0  
8 Cairn Terriers ..... 3-2-1/2

## 1:45PM

15 Basenjis ..... 4-8-1/2  
11 Bullmastiffs ..... 1-3-6/1

## RING 8 – R C WILLIAMS – 174

## 8:00AM

17 French Bulldogs ..... 6-10-1/0  
3 Beagles (over 13 in.) ..... 2-0-1/0  
1 American Hairless Terriers ..... 0-0-1/0

## 9:00AM

4 Fox Terriers (Smooth) ..... 1-0-1/2  
1 Russell Terriers ..... 0-1-0/0  
3 Australian Terriers ..... 0-3-0/0  
1 Dandie Dinmont Terriers ..... 1-0-0/0  
5 Glen of Imaal Terriers ..... 1-1-1/2  
5 Miniature Schnauzers ..... 0-3-1/1  
1 Parson Russell Terriers ..... 1-0-0/0



# INDEX OF BREEDS – SUNDAY

This index has been prepared to enable exhibitors to (1) identify the Ring(s) in which their Breed(s) is (are) to be judged and (2) have an approximation of the number of dogs entered. The entry figures are not to be taken as a representation on the part of the Superintendent that all dogs entered will be present on the Show day. If there are any discrepancies between the ring schedule and this Index, the ring schedule governs.

## 10:00AM

- 3 Scottish Terriers.....1-1-0/1
- 5 Welsh Terriers.....1-4-0/0
- 11 Italian Greyhounds.....1-6-2/2

## 11:00AM

- 4 Norwich Terriers.....1-1-2/0
- 4 Schipperkes.....1-3-0/0
- 13 Borzois.....6-4-1/2

## LUNCH

## 12:45PM

- 11 Greater Swiss Mountain Dogs.....2-9-0/0
- 1 Afghan Hounds.....1-0-0/0
- 8 Irish Wolfhounds.....3-4-0/1
- 1 Scottish Deerhounds.....0-1-0/0
- 12 Great Pyrenees.....4-7-1/0

## 2:15PM

- 10 Dalmatians.....2-3-3/2
- 21 Whippets.....6-13-0/2

## 3:30PM

- 8 Keeshonden.....3-2-1/2
- 12 Staffordshire Bull Terriers.....5-4-3/0
- 3 American Staffordshire Terriers.....1-1-1/0
- 1 Irish Terriers.....1-0-0/0
- 5 Miniature Bull Terriers.....0-2-1/1

### RING 9 – KATHLEEN GALOTTI – 25

## 8:00AM

- 4 Obed. Utility Class A.....1501, 1503-1505

## 8:45AM

- 7 Obed. Open Class B.....1401, 1403-1408

## 9:45AM

- 4 Obed. Novice Class A1101-1102, 1104, 1107

## 10:15AM

- 5 Obed. Beginner Novice A..... [1101], 1701, 1704-1706

## 10:45AM

- 5 Obed. Beginner Novice B.....1742-1746

### RING 10 – SUE COX – 28

## 8:00AM

- 8 Obed. Utility Class B...1601-1602, [1403-1405, 1407-1408], 1603

## 9:15AM

- 1 Obed. Graduate Open Class.....1841

## 9:30AM

- 2 Obed. Open Class A.....1201, 1303

## 9:45AM

- 4 Obed. Preferred Novice...[1205, 1220, 1743, 1745]

## 10:15AM

- 13 Obed. Novice Class B.....1202, 1204-1206, 1208-1211, 1213-1214, 1217, 1219-1220

### RING 11 – DAWN ANTONIAK-MITCHELL – 48

## 8:00AM

- 5 Rally Master 2801, [2502, 2511, 2514, 2517]

## 8:20AM

- 11 Rally Excellent B... [2501-2502, 2505], 2701, [2511, 2514, 2517], 2702-2705

- 1 Rally Excellent A.....2601

## 9:00AM

- 9 Rally Advanced B..... 2501-2502, 2505-2506, 2508, 2511, 2514, 2516-2517

- 2 Rally Advanced A.....2401, 2403

## 9:45AM

- 6 Rally Intermediate.... 2301-2303, 2305-2307

## 10:15AM

- 5 Rally Novice B..... 2201-2202, 2204-2206

- 9 Rally Novice A..... 2101-2105, 2107–2110

#	BREED	R	TIME
1	AFGHAN HOUNDS	8	12:45PM
1	AKITAS	7	8:00AM
4	ALASKAN MALAMUTES	7	9:00AM
1	AMERICAN HAIRLESS TERRIERS	8	8:00AM
3	AMERICAN STAFFORDSHIRE TERRIERS	8	3:30PM
5	AUSTRALIAN CATTLE DOGS	3	9:00AM
28	AUSTRALIAN SHEPHERDS	2	1:15PM
3	AUSTRALIAN TERRIERS	8	9:00AM
15	BASENJIS	7	1:45PM
12	BASSET HOUNDS	4	1:15PM
3	BEAGLES (OVER 13 IN.)	8	8:00AM
7	BEARDED COLLIES	3	10:00AM
5	BEAUCERONS	3	9:00AM
2	BELGIAN MALINOIS	3	9:00AM
1	BELGIAN SHEEPDOGS	3	9:00AM
1	BELGIAN TERVUREN	2	12:15PM
1	BERGER PICARDS	3	9:00AM
19	BERNESE MOUNTAIN DOGS	2	9:00AM
7	BICHONS FRISES	5	11:00AM
6	BIEWER TERRIERS	1	10:00AM
1	BLACK AND TAN COONHOUNDS	1	9:00AM
2	BLACK RUSSIAN TERRIERS	7	9:00AM
3	BLOODHOUNDS	1	8:00AM
12	BORDER TERRIERS	7	11:00AM
13	BORZOIS	8	11:00AM
13	BOSTON TERRIERS	5	8:00AM
7	BOUVIERS DES FLANDRES	3	10:00AM
3	BOXERS	7	9:00AM
14	BRITTANYS	2	8:00AM
7	BRUSSELS GRIFFONS	6	1:00PM
7	BULLDOGS	5	8:00AM
11	BULLMASTIFFS	7	1:45PM
8	CAIRN TERRIERS	7	12:45PM
4	CANE CORSO	7	8:00AM
14	CARDIGAN WELSH CORGIS	5	2:00PM
19	CAVALIER KING CHARLES SPANIELS	6	1:45PM
4	CHIHUAHUAS (LONG COAT)	1	10:00AM
7	CHINESE CRESTED	1	10:00AM
1	CHINOOKS	7	10:00AM
4	COLLIES (ROUGH)	2	12:15PM
3	COLLIES (SMOOTH)	2	12:15PM
2	COTON DE TULEAR	1	11:00AM
3	DACHSHUNDS (LONGHAIRED)	7	10:00AM
5	DACHSHUNDS (SMOOTH)	7	10:00AM
5	DACHSHUNDS (WIREHAIRED)	7	10:00AM
10	DALMATIANS	8	2:15PM
1	DANDIE DINMONT TERRIERS	8	9:00AM
18	DOBERMAN PINSCHERS	4	11:30AM
3	FINNISH LAPPHUNDS	3	8:00AM
4	FOX TERRIERS (SMOOTH)	8	9:00AM
17	FRENCH BULLDOGS	8	8:00AM
3	GERMAN PINSCHERS	7	9:00AM
4	GERMAN SHEPHERD DOGS	3	9:00AM
5	GLEN OF IMAAL TERRIERS	8	9:00AM
11	GREAT DANES	7	8:00AM
12	GREAT PYRENEES	8	12:45PM
11	GREATER SWISS MOUNTAIN DOGS	8	12:45PM
2	GREYHOUNDS	7	8:00AM
13	HAVANESE	5	10:00AM
10	ICELANDIC SHEEPDOGS	3	8:00AM
1	IRISH TERRIERS	8	3:30PM
8	IRISH WOLFHOUSES	8	12:45PM
11	ITALIAN GREYHOUNDS	8	10:00AM
30	JUNIOR SHOWMANSHIP	4	8:00AM
8	KEESHONDEN	8	3:30PM
8	LEONBERGERS	4	10:30AM
8	LHASA APSOS	5	11:00AM
2	LOWCHEN	1	11:00AM
1	MALTESE	1	10:00AM
8	MASTIFFS	7	9:00AM
8	MINIATURE AMERICAN SHEPHERDS	3	8:00AM
5	MINIATURE BULL TERRIERS	8	3:30PM
5	MINIATURE SCHNAUZERS	8	9:00AM
2	NEDERLANDSE KOOIKERHONDJES	2	9:00AM
9	NEWFOUNDLANDS	7	11:00AM
2	NORWEGIAN BUHUNDS	3	9:00AM

4	NORWICH TERRIERS	8	11:00AM
15	OLD ENGLISH SHEEPDOGS	3	10:45AM
28	PAPILLONS	1	12:30PM
1	PARSON RUSSELL TERRIERS	8	9:00AM
5	PEKINGESE	1	11:00AM
19	PEMBROKE WELSH CORGIS	5	2:00PM
3	PHARAOH HOUNDS	1	9:00AM
1	POINTERS	4	9:30AM
7	POINTERS (GERMAN SHORTHAIRED)	6	10:30AM
5	POINTERS (GERMAN WIREHAIRED)	6	8:00AM
2	POMERANIANS	1	10:00AM
4	POODLES (MINIATURE)	5	11:00AM
11	POODLES (STANDARD)	5	12:45PM
1	POODLES (TOY)	5	11:00AM
2	PORTUGUESE WATER DOGS	4	9:30AM
20	PUGS	5	9:00AM
11	RAT TERRIERS	7	12:45PM
7	RETRIEVERS (CHESAPEAKE BAY)	6	11:30AM
5	RETRIEVERS (FLAT-COATED)	6	10:30AM
17	RETRIEVERS (GOLDEN)	1	9:00AM
26	RETRIEVERS (LABRADOR)	6	8:00AM
3	RETRIEVERS (NOVA SCOTIA DUCK TOLL)	2	10:00AM
15	RHODESIAN RIDGEBACKS	4	9:30AM
6	ROTTWEILERS	4	1:15PM
1	RUSSELL TERRIERS	8	9:00AM
13	SAINT BERNARDS	4	10:30AM
5	SALUKIS	1	8:00AM
1	SAMOYEDS	4	9:30AM
4	SCHIPPERKES	8	11:00AM
1	SCOTTISH DEERHOUNDS	8	12:45PM
3	SCOTTISH TERRIERS	8	10:00AM
8	SETTERS (ENGLISH)	6	11:30AM
2	SETTERS (IRISH RED AND WHITE)	2	8:00AM
8	SHETLAND SHEEPDOGS	2	12:15PM
11	SHIBA INU	5	12:45PM
7	SHIH TZU	5	10:00AM
10	SIBERIAN HUSKIES	4	1:15PM
2	SPANIELS (CLUMBER)	6	1:45PM
7	SPANIELS (COCKER) ASCOB	6	10:30AM
11	SPANIELS (COCKER) BLACK	6	9:30AM
10	SPANIELS (COCKER) PARTI	6	9:30AM
3	SPANIELS (ENGLISH COCKER)	4	11:30AM
8	SPANIELS (ENGLISH SPRINGER)	2	10:00AM
3	SPANIELS (IRISH WATER)	2	8:00AM
12	SPANIELS (WELSH SPRINGER)	2	10:00AM
2	SPANISH WATER DOGS	2	12:15PM
1	SPINONI ITALIANI	7	8:00AM
12	STAFFORDSHIRE BULL TERRIERS	8	3:30PM
1	STANDARD SCHNAUZERS	4	1:15PM
2	SWEDISH VALLHUNDS	2	12:15PM
4	TIBETAN SPANIELS	1	11:00AM
1	TOY FOX TERRIERS	5	11:00AM
13	VIZSLAS	1	8:00AM
8	WEIMARANERS	6	1:00PM
5	WELSH TERRIERS	8	10:00AM
21	WHIPPETS	8	2:15PM
1	WIREHAIRED POINTING GRIFFONS	7	8:00AM
5	YORKSHIRE TERRIERS	7	10:00AM
4	OBED. UTILITY CLASS A	9	8:00AM
7	OBED. OPEN CLASS B	9	8:45AM
4	OBED. NOVICE CLASS A	9	9:45AM
5	OBED. BEGINNER NOVICE A	9	10:15AM
5	OBED. BEGINNER NOVICE B	9	10:45AM
8	OBED. UTILITY CLASS B	10	8:00AM
1	OBED. GRADUATE OPEN CLASS	10	9:15AM
2	OBED. OPEN CLASS A	10	9:30AM
4	OBED. PREFERRED NOVICE	10	9:45AM
13	OBED. NOVICE CLASS B	10	10:15AM
5	RALLY MASTER	11	8:00AM
11	RALLY EXCELLENT B	11	8:20AM
1	RALLY EXCELLENT A	11	8:20AM
9	RALLY ADVANCED B	11	9:00AM
2	RALLY ADVANCED A	11	9:00AM
6	RALLY INTERMEDIATE	11	9:45AM
5	RALLY NOVICE B	11	10:15AM
9	RALLY NOVICE A	11	10:15AM