

# JUDGING PROGRAM

AMERICAN KENNEL CLUB RULES & REGULATIONS GOVERN THESE EVENTS.

EVENT NUMBERS: #1-2025011420, #2-2025011421 • SHOW HOURS - 8:30AM to 7:00PM - MDT



## Alaskan Malamute Club of America

(Member of the American Kennel Club - Outdoors, Unbenched)

Cache County Fairgrounds  
450 South 500 West, Logan, UT 84321

**WEDNESDAY, MAY 14, 2025**

**ROCKY MOUNTAIN AREA SPECIALTY**

Show #1 with Sweepstakes

Show #2 with Sweepstakes & Jr. Showmanship

Entry Limit 100 Each Show.

Dogs are not required to be at the show until scheduled time of judging.

All dogs not needed for further judging will be excused.

### JUDGES

Show #1 - All Conformation Classes

Mrs. Abigail (Abby) S. Patrizio [97059].....CLINTON, CT

Show #1 - Sweepstakes & Veteran Sweepstakes

Ms. Janet Bodin [101381].....WAUKESHA, WI

Show #2 - All Conformation & Junior Showmanship Classes

Mrs. Terry Dennison\* [47424].....WASILLA, AK

Show #2 - Sweepstakes & Veteran Sweepstakes

Ms. Brandy Brian.....BOISE, ID

*\*One or more breeds assigned approved as provisional/permit by AKC.*

### NEW EXHIBITOR BRIEFING

Superintendent will have New Exhibitor Handbooks available, and are there to answer any of your questions on the days of the shows.

### IMPORTANT EXHIBITOR INFORMATION

ADDITIONAL RULES INCLUDED IN PREMIUM LIST - READ IT.

There is no acceptable excuse for breaking or being unfamiliar with the rules.



AMERICAN  
KENNEL CLUB®

CERTIFICATION Permission has been granted by the American Kennel Club for the holding of this event under the American Kennel Club rules and regulations.

GINA M. DINARDO, Executive Secretary



### BaRay Event Services, Inc.

A.K.C. ANNUALLY LICENSED SUPERINTENDENTS  
MEMBER: DOG SHOW SUPERINTENDENTS ASSOCIATION

• SHEILA RAYMOND • BECKY SUMNER • JERRY SUMNER • ANDREA L. FERNANDEZ  
• KRISTIN MARICICH • SHARON SAMSON • ROBERTA MARTIN • GLENN WHITTEN  
• KRISTILYN FALKENTHAL • SCOTT KIPP • JEFFERY INMAN • ANDREW MUELLER

PO BOX 508, BURLINGTON, WA 98233-0508  
PHONE: 360-755-7086 • FAX: 360-755-2248

HAND-DELIVERED, EXPRESS or PRIORITY, FEDEX or UPS:

113 E. FAIRHAVEN AVE., BURLINGTON, WA 98233-0508 (do NOT require signature)

E-MAIL: dogshows@barayevents.com • WEB SITE: BaRayEvents.com

OFFICE HOURS  
10AM-5PM  
PACIFIC TIME  
MON.-FRI.

Like us on  
FACEBOOK



### SHOW COMMITTEE

Brock Powell - Show Chair • brock75p@yahoo.com

Day of Show Phone: 801-201-2038

Bench Committee: All Officers, Members of the Board  
of Directors & Any Other Members Present.

### COMMITTEES

Kami Jenkins ..... Chief Ring Steward  
Pat & Morty Jenkins ..... Grounds  
Justin & Navy Scofield ..... Trophies  
Leneia Rogowski ..... Catalog Advertising

### SHOW VETERINARIAN (ON-CALL)

Bridgeland Cache Animal Hospital

95 W 900 N, Logan, UT 84321 • 435-752-2151

DIRECTIONS TO CLINIC: Out of the Fairgrounds go North 1/2 block to 400 South, turn right and go East on 400 S (.7 mi). Turn left onto Main Street (US89/US91). Continue on Main to 900 N (1.7 mi). Turn left onto 900 North. Go 1 block to 95 W. The clinic is on the North side of the street. (If calling after hours press 1 to talk to a veterinarian. The show is considered a client)

### SHOW PHOTOGRAPHER

Tyler Crady-Roche • 916-807-6043

Tyler@AllBreedPhoto.com • www.AllBreedPhoto.com

All photos will be available for viewing and purchase within 24 hours after Best In Show (Donating complimentary photos for any Junior and PeeWee)

The Show Site & RV Parking will be available to exhibitors after 2:00PM Tuesday. On Wednesday parking will be available after 10:00AM. While Wednesday's specialty and group shows are occurring, those with RV parking adjacent to the rings will be required to wait until after the conclusion of the specialty and group shows. Dogs must be removed from the show site 1.5 hours after Best in Show on Sunday unless approved by grounds chair.

The AKC is committed to creating a safe and respectful sport environment for all. If you need to talk to someone, or need help, please call 800-656-HOPE (National Sexual Assault Hotline) or text HOME to 741-741 for free, 24/7, confidential services from trained crisis counselors.

**ATTENTION EXHIBITORS OF FOREIGN DOGS,** please visit <https://www.cdc.gov/importation/dogs/index.html> for the most recent updates regarding bringing a dog into the U.S.

### TRANSFER OF ENTRIES

**NOTE: TRANSFER OF ENTRIES AND REQUESTS FOR REFUNDS FOR PUBLISHED JUDGE CHANGES WILL NOT BE ACCEPTED IN THE OFFICE AFTER 12:00 NOON ON FRIDAY, MAY 9. AFTER THIS TIME, YOU MUST CONTACT THE SUPERINTENDENT ON SITE.**

**CONFORMATION:** Dogs may be transferred from one of the regular classes to the Best of Breed or Variety competition, provided this transfer is presented to the Superintendent at least one half-hour prior to the scheduled start of any regular conformation judging at the show.

**JUNIOR SHOWMANSHIP:** Junior Handlers who win a third Novice Class with competition, if a win in Novice leads to a Best Junior with competition present it will count as one win towards moving to Open, after closing of entries for a show are required to transfer their entry from the Novice Class to the Open Class by notifying the Superintendent prior to the start of the class at the show. Correction may be made from one age division to another, as well as, move from Master to Open or Open to Novice if a win has been disallowed or the Junior miscalculated number of placements, provided this transfer must be made to the Superintendent prior to the judging of the class at the show.

# ALASKAN MALAMUTE CLUB OF AMERICA

## JUDGING PROGRAM - WEDNESDAY, MAY 14, 2025

### SHOW #1

Total: 32 Dogs, 42 Entries

**RINGS 1 & 2 - JUDGE: JANET BODIN**

#### 9:30AM - 8 SWEEPSTAKES

- 1 Sweepstakes Dogs 9-12 Mos.
- 3 Sweepstakes Dogs 12-18 Mos.
- 2 Sweepstakes Bitches 6-9 Mos.
- 1 Sweepstakes Bitches 9-12 Mos.
- 1 Sweepstakes Bitches 12-18 Mos.
- Best in Sweepstakes,*
- Best of Opposite Sex*

#### 3 VETERAN SWEEPSTAKES

- 2 Veteran Sweepstakes Dogs 8-10 Yrs.
- 1 Veteran Sweepstakes Bitches 10-12 Yrs.
- Best in Veteran Sweepstakes,*
- Best of Opposite Sex*

**RINGS 1 & 2 - JUDGE: ABBY PATRIZIO**

#### 10:15AM - 31 CONFORMATION

##### 31 Alaskan Malamutes 9-6-2vd-1vb-6/7

- 1 Puppy Dogs 9-12 Mos.
- 1 Dogs 12-18 Mos.
- 1 Bred By Exhibitor Adult Dogs
- 6 Open Dogs
- Winners Dog, Reserve Winners Dog*
- 2 Puppy Bitches 6-9 Mos.
- 1 Puppy Bitches 9-12 Mos.
- 1 Bred By Exhibitor Adult Bitches
- 2 Open Bitches
- Winners Bitch, Reserve Winners Bitch*
- 2 Veteran Dogs 8-10 Yrs.
- 1 Veteran Bitches 10-12 Yrs.
- 13 Best of Breed Competition 6/7
- Best of Breed, Best of Winners,*
- Best of Opposite Sex,*
- Select Dog, Select Bitch*

### SHOW #2

Total: 32 Dogs, 43 Entries

**RINGS 1 & 2 - JUDGE: BRANDY BRIAN**

#### 1:00PM - 8 SWEEPSTAKES

- 1 Sweepstakes Dogs 9-12 Mos.
- 3 Sweepstakes Dogs 12-18 Mos.
- 2 Sweepstakes Bitches 6-9 Mos.
- 1 Sweepstakes Bitches 9-12 Mos.
- 1 Sweepstakes Bitches 12-18 Mos.
- Best in Sweepstakes,*
- Best of Opposite Sex*

#### 3 VETERAN SWEEPSTAKES

- 2 Veteran Sweepstakes Dogs 8-10 Yrs.
- 1 Veteran Sweepstakes Bitches 10-12 Yrs.
- Best in Veteran Sweepstakes,*
- Best of Opposite Sex*

**RINGS 1 & 2 - JUDGE: TERRY DENNISON**

#### 1:45PM - 1 JUNIOR SHOWMANSHIP

- 1 Novice Junior
- Best Junior Handler*

#### 2:00PM - 31 CONFORMATION

##### 31 Alaskan Malamutes 9-6-2vd-1vb-6/7

- 1 Puppy Dogs 9-12 Mos.
- 1 Dogs 12-18 Mos.
- 1 Bred By Exhibitor Adult Dogs
- 6 Open Dogs
- Winners Dog, Reserve Winners Dog*
- 2 Puppy Bitches 6-9 Mos.
- 1 Puppy Bitches 9-12 Mos.
- 1 Bred By Exhibitor Adult Bitches
- 2 Open Bitches
- Winners Bitch, Reserve Winners Bitch*
- 2 Veteran Dogs 8-10 Yrs.
- 1 Veteran Bitches 10-12 Yrs.
- 13 Best of Breed Competition 6/7
- Best of Breed, Best of Winners,*
- Best of Opposite Sex,*
- Select Dog, Select Bitch*

**Lunch will be offered between shows to be held at the Bowery.**

Sponsored by Wolfmountain Kennel (Pat & Morty Jenkins) and  
Stormrunner Kennel (Leneia & Cassandra Rogowski)

#### ATTENTION EXHIBITORS

Please clean up after your dogs on the show grounds and at your motel site. We want to retain these facilities for future events. Remember, all complaints regarding conduct prejudicial to the sport will be dealt with in accordance with AKC rules, by the Show Committee.

**SMOKING will not be permitted inside show buildings (state law), or around show rings. This will be enforced.**

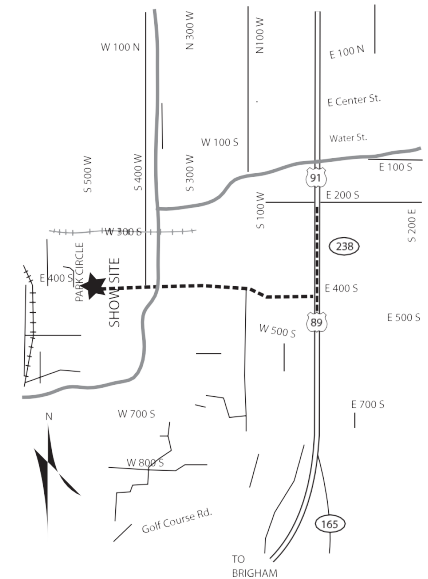

#### ROUTES TO THE SHOW

FROM NORTH OR SOUTH (Highway 89-21)  
Turn west on 400 S. Go 5 blocks, turn left. Please enter fairgrounds from west entrance. Vehicles that are parked illegally will be towed. If your vehicle is towed, you will be charged for towing as well as possible impound charges.

#### MOTELS THAT WILL ACCEPT PETS

NOTE: These motels will allow guests to have well-behaved dogs in the room provided the guests guarantee to reimburse the management for any damages. Some of these motels will not allow dogs unattended in rooms, some require a pet fee/deposit, and some limit numbers and sizes of dogs. (When calling for reservations let the motel know you are with the dog show as some are making special dispensations for our show).

##### MAKE RESERVATIONS EARLY.

##### SEE PREMIUM LIST FOR ADDRESSES

**LAQUINTA INN AND SUITES BY WYNDHAM**.....

• 435-752-0707

**SUPER 8 MOTEL** (Check with hotel for pet fee).....

• 435-753-8883

**COMFORT INN & SUITES**.....

• 435-713-4567

**TOWN PLACE SUITES**.....

• 435-709-6789

Free hot breakfast

• Nonrefundable pet fee of \$50

• Ask for the dog show rate.

Must reserve at least 30 days out to get block rate.

All motels have been notified of disciplinary action that WILL be taken if property is abused.

##### NO BATHING OF DOGS IN THE ROOM.

**PLEASE VERIFY THAT MOTEL WILL ACCEPT YOUR DOGS. MANAGERS AND POLICIES CHANGE.**

Vehicles that are parked illegally will be towed by the Logan City Police Department. If your vehicle is towed, you will be charged for towing as well as possible impound charges. WE MUST KEEP FIRE LANES as well as some other areas clear. PLEASE PARK ONLY IN DESIGNATED AREA