

REVISED JUDGE SUNDAY - COTON DE TULEAR & DANISH-SWEDISH FARM DOGS TO BRADLEY JENKINS

JUDGING PROGRAM AMERICAN KENNEL CLUB RULES & REGULATIONS GOVERN THESE EVENTS.

EVENT # - DUBUQUE: THU-#2021102001(C/J), FRI-#2021102003(C/J).

WISCONSIN: SAT-#2021124601(C/J), SUN-#2021124603(C/J).

RENAISSANCE CLUSTER DOG SHOWS

(Unbenched, Indoors, AKC Licensed)

November 18-21, 2021

These Shows are dedicated to Judy Fojtik

Four All Breed Dog Shows with Junior Showmanship

DUBUQUE KENNEL CLUB

THURSDAY, NOVEMBER 18, 2021

FRIDAY, NOVEMBER 19, 2021

DESIGNATED SPECIALTY - Irish Water Spaniel Club of America - Event #2021166924

SUPPORTED ENTRY THURSDAY & FRIDAY

American Brussels Griffon Association & Great Lakes Pug Club

WISCONSIN KENNEL CLUB

SATURDAY, NOVEMBER 20, 2021

DESIGNATED SPECIALTY w/ SWEEPSTAKES & VETERAN SWEEPSTAKES

Great Lakes Pug Club-Event #2021135105

DESIGNATED SPECIALTY - Midwest Boxer Club-Event #2021049106

SUPPORTED ENTRY WITH SWEEPSTAKES & VETERAN SWEEPSTAKES

Newfoundland Club of America, Inc. Hosted by the North Central Newfoundland Club-Event #2021194372

SUPPORTED ENTRY SATURDAY - American Brussels Griffon Association

SUNDAY, NOVEMBER 21, 2021

DESIGNATED SPECIALTY w/ SWEEPSTAKES & VETERAN SWEEPSTAKES

Great Lakes Pug Club-Event #2021135106

DESIGNATED SPECIALTY - Midwest Boxer Club-Event #2021049107

DESIGNATED SPECIALTY - Samoyed Association of Madison Inc. - EVENT #2021426003

SUPPORTED ENTRY WITH SWEEPSTAKES & VETERAN SWEEPSTAKES

Newfoundland Club of America, Inc. Hosted by the North Central Newfoundland Club-Event #2021194371

SUPPORTED ENTRY SATURDAY & SUNDAY - American Brussels Griffon Association

Alliant Energy Center, New Holland Pavilions, 1919 Alliant Energy Center Way, Madison, WI 53713

Regarding COVID-19, The Renaissance Cluster will abide by the State of Wisconsin, local and facility guidelines in effect on November 18-21, 2021. A risk of exposure to communicable diseases exists in any public place. Event attendees voluntarily assume all risks related to exposure to communicable diseases. It is incumbent upon event attendees to follow guidelines to prevent the spread.

Show Site will not be available to exhibitors including 3 National Specialties, held on the same

Show site until 6 AM on Wednesday morning, November 17th - CST

Food Service available in Lobby of Pavilion 1

Spectators Allowed • Renaissance Cluster will Provide limited Ringside seating.

NOTE: The Alliant Center will charge \$8 per day for parking.

NEW EXHIBITOR BRIEFING

Please come to Superintendent's Table between 8:30 - 10:30 AM each day.

Covid Rules for Madison and Dane County:

Effective at 12:01AM on November 5, 2021, Face Covering Emergency Order #4 pdf will take effect. The Order requires face coverings among people ages two and older when in any enclosed space open to the public where other people, except for members of the person's own household or living unit are present.



AMERICAN
KENNEL CLUB®

CERTIFICATION Permission has been granted by the American Kennel Club for the holding of this event under the American Kennel Club rules and regulations.

GINA M. DINARDO, Executive Secretary



BaRay Event Services, Inc.

A.K.C. ANNUALLY LICENSED SUPERINTENDENTS

MEMBER: DOG SHOW SUPERINTENDENTS ASSOCIATION

• SHEILA RAYMOND • BECKY SUMNER • JERRY SUMNER • CHUCK ST. JOHN
• DALE NEUKOM, JR. • JEFFERY INMAN • GLENN WHITTEN • KRISTIN MARICICH
• ROBERTA MARTIN • GUY MICHELSON • SHARON SAMSON

PO BOX 508, BURLINGTON, WA 98233

PHONE: 360-755-7086 • FAX: 360-755-2248

HAND-DELIVERED, EXPRESS or PRIORITY, FEDEX or UPS:

113 E. FAIRHAVEN AVE., BURLINGTON, WA 98233 (do NOT require signature)

E-MAIL: dogshows@barayevents.com • WEB SITE: BaRayEvents.com

OFFICE HOURS
10AM-5PM
PACIFIC TIME
MON.-FRI.

Like us on
FACEBOOK



SHOW HOURS EACH DAY 6:00AM-8:00PM

Doors to lock at 10:00PM - CST

SHOW SITE AVAILABILITY - Vendors to set up

starting Tuesday, November 16th 7:00AM

RV Parking will begin at 2:00PM, but will not be allowed

to set up in building until 4:00PM

(contact the RV chair for special accommodations)

SHOW COMMITTEE - BOTH EVENTS

Show Chair - Ed Fojtik

27356 W Nippersink Road, Ingleside, IL 60041

efojtik@aol.com • 847-254-6166

Co Show Chair - Margie Wilson

And All Officers & Available Members of the Club

VETERINARIAN - ON CALL

After-Hour Emergency

Madison Veterinary Specialists & Emergency

2704 Royal Ave., Madison, WI 53713 • 608-274-7772

PHOTOGRAPHER

Photos by Lennah, LLC

www.photosbylennah.com • photosbylennah@gmail.com

517-282-7943

(Only the Official Photographer may take win pictures.)



The American Kennel Club will Film Groups & Best in Show for AKCTV Publication Rights: By entering this show, all owners, handlers, breeders, and kennels agree that all rights to televise, videotape, photograph, advertise, promote, and publicize or otherwise exploit this show, or the persons or animals participating in it or the results of the competition before, during, or after the event, shall belong solely to the American Kennel Club and their respective assigns including the names likeness, or biographical matter of all dogs, owners, handlers, breeders, and kennels participating in the show and no such owner, handler, breeder, or kennel shall allow any other party to make commercial use of any videotape or photograph of any person or animal participating in this competition. NOTE: Entering this show all owners, handlers, breeders, and kennels agree to make themselves available for interviews if requested.

JUDGES FOR ALL EVENTS

Carissa Boettcher [25846] WAUKESHA, WI 53188
Janie Bousek* [7252] GREENVILLE, WI 54942
Anne Catterson [17478] HOT SPRINGS VILLAGE, AR 71909
Diane Collings* [94897] NOVATO, CA 94945
Beth Downey* [102539] OCEAN SPRINGS, MS 39565
Geir Flyckt-Pedersen* [65804] PEPPER PIKE, OH 44124
Ed Fojtik* [104757] INGLESIDE, IL 60041
Lisa Graser* [37267] MOSHEIM, TN 37818
Lloyd Graser Jr.* [16626] MOSHEIM, TN 37818
Sulie Greendale-Paveza* [7516] FORT PIERCE, FL 34951
Steve Hayden [6674] SPRINGFIELD, IL 62704
Robert Hutton* [15138] LOUISVILLE, KY 40214
Bradley Jenkins* [7469] BONO, AR 72416
Mary Lee [103048] COLUMBUS, MS 39701
Linda Robey* [6621] HIGH RIDGE, MO 63049
Barbara Scherer* [58838] NAPERVILLE, IL 60564
Patricia Sosa [45766] MADISONVILLE, LA 70447
Mary Lynn Speer [22531] GLENWOOD CITY, WI 54013
Delbert Thacker* [7331] UNION GROVE, WI 53182
Patricia Trotter [6420] CARMEL, CA 93922
Miss Alexis Lauren Truesdail* [103045] BEEBE, AR 72012
John Wade [5936] WASHOE VALLEY, NV 89704

*provisional/permit

NEWFOUNDLAND SWEEPSTAKES JUDGES

SATURDAY: Nancy Gasser ST. AUGUSTINE, FL 32085
SUNDAY: Ronda Bermke GREENLEAF, WI 54126

PUGS SWEEPSTAKES JUDGES

SATURDAY: Margie Wilson RACINE, WI 53402
SUNDAY: Ed Fojtik INGLESIDE, IL 60041

*provisional/permit

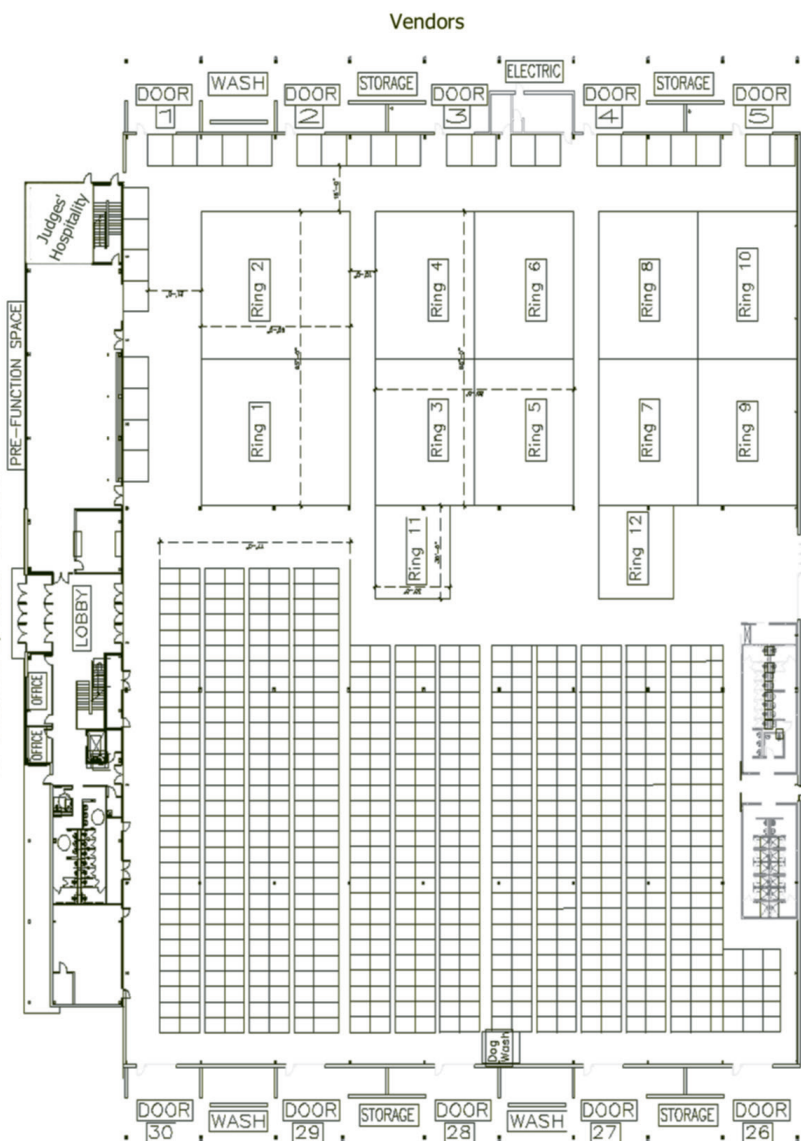

ROUTES TO THE SHOW

Directions to the Alliant Energy Center, New Holland Pavilion, 1919 Alliant Energy Center Way, Madison, WI:

I-90 to exit 142A, west on Hwy. 12/18, 5 miles to Rimrock Rd, exit 262

ACCOMMODATIONS:

There are other events in Madison that weekend, so all the hotels will probably sell out early.

The four hotels listed on this page are located within .2 miles from the event, and all allow dogs.

****Please help us have a good long-term relationship with the area hotels. Right now, dogs are welcome, and the hotels are excited to have us as guests. You will be responsible for any damage to a guest room or any hotel property, and it is your responsibility to clean up after your dog if it soils on the hotel property. Additional fees could be charged if your room is damaged or requires extensive cleaning, and this will be solely at hotel management's discretion. In the event of excessive barking, the occupant will be notified and expected to quiet the dog(s). There will be no bathing/grooming of dogs in hotel rooms; bathing facilities will be available at the show site. The hotel and show committee will investigate any problem areas and anyone found to violate these premises will be subject to a bench showing hearing that could result in suspension.****

**THE FOUR HOTELS BELOW CAN BE RESERVED VIA THE LINKS ON OUR WEBSITE. PLEASE GO TO:
[HTTPS://RENAISSANCECLUSTER.ORG/](https://renaissancecluster.org/) AND SELECT "HOTELS"**

Our host hotel is The Sheraton,

706 John Nolen Drive, Madison, Wisconsin, WI 53713 608-251-2300
 We have negotiated a discounted rate of \$99. Make your reservation by October 27th, 2021 deadline. If you call directly, identify yourself as being with the "Dog Show." You can book via the special link on our website-- (There is a \$25 pet fee per room)

If you have any problems booking online, call Lindsay Temple, Senior Sales Manager, and mention you are with the "Dog Show." Her direct line is 608-234-1022.

The Sheraton has a bar and restaurant and a Starbucks in the Lobby, Free shuttle service to the Alliant Energy Center and Dane County Airport.

The Comfort Inn Madison,

722 John Nolen Drive, Madison, WI 53713 608-255-7400
 We have negotiated a discounted rate of \$79. Make your reservation by the October 17th deadline.

Home2Suites by Hilton

2153 Rimrock Road, Madison, WI. 53713..... 608-949-9650
 We have negotiated a discounted rate of \$84, make your reservation by October 18th 2021.

Holiday Inn Express Madison

610 John Nolen Drive, Madison WI. 53713 608-709-5050
 To receive the discounted group rate of \$99 at the Holiday Inn Express, reserve by the October 17th 2021 deadline.

PLEASE CLEAN UP AFTER YOUR DOGS *CALL TO CONFIRM PRICES*

USE OF RAMPS – ALL BREEDS

A judge requesting the use of a ramp must give notice to the show superintendent/show secretary prior to judging. AKC approval is not required. The entire entry in a breed is to be examined in the same manner (ground, table, or ramp).

At the discretion of the judge, the following breeds may be judged on a ramp through all levels of competition: Lagotto Romagnolo, Nova Scotia Duck Tolling Retrievers, American Water Spaniels, Boykin Spaniels, English Springer Spaniels, Field Spaniels, Welsh Springer Spaniels, Grand Basset Griffon Vendeen, Standard Schnauzers, American Staffordshire Terriers, Irish Terriers, Kerry Blue Terriers, Soft Coated Wheaten Terriers, Staffordshire Bull Terriers, Finnish Spitz, Entlebucher Mountain Dogs, Finnish Lapphunds, Icelandic Sheepdogs, Norwegian Buhunds, Polish Lowland Sheepdogs, Spanish Water Dogs, and Norrbottenspets (Misc.).

At the discretion of the judge through all levels of competition, the following breeds may be judged on the ground, a ramp, or on a table: Whippets, Miniature Bull Terriers.

At the discretion of the judge through all levels of competition, the following breeds may be judged on a ramp, or on a table: Mudi.

The following breeds must be judged on a ramp through all levels of conformation competition: Clumber Spaniels, Sussex Spaniels, Basset Hounds, Cirneco dell'Etnas, Bulldogs, Chinese Shar-Pei, Chow Chows and Keeshonden.

This extends to all conformation competition at AKC conformation dog shows and any AKC event where a conformation title may be earned. This policy includes Group, BIS, Junior Showmanship, the 4-6 Month Beginner Puppy Competition, the AKC National Owner-Handled Series (NOHS), and all other special attractions that offer Group and BIS competitions. Ramps can be used in emergency situation to judge any breed.

In an emergency situation, where use of a ramp is not indicated in the premium list, an exhibitor has the option of withdrawing their entry and receiving a refund. For the judging of juniors the ramp may be used at the discretion of the judge for the ramp optional breeds. (01/2021)

TRANSFER OF ENTRIES

NOTE: TRANSFER OF ENTRIES AND REQUESTS FOR REFUNDS FOR PUBLISHED JUDGE CHANGES WILL NOT BE ACCEPTED IN THE OFFICE AFTER 12:00 NOON ON MONDAY, NOVEMBER 15, 2021. AFTER THIS TIME, YOU MUST CONTACT THE SUPERINTENDENT ON SITE.

CONFORMATION: Dogs may be transferred from one of the regular classes to the Best of Breed or Variety competition, provided this transfer is presented to the Superintendent at least one half-hour prior to the scheduled start of any regular conformation judging at the show.

JUNIOR SHOWMANSHIP: Junior Handlers who win a third Novice Class with competition, if a win in Novice leads to a Best Junior with competition present it will count as one win towards moving to Open, after closing of entries for a show are required to transfer their entry from the Novice Class to the Open Class by notifying the Superintendent prior to the start of the class at the show. Correction may be made from one age division to another, as well as, move from Master to Open or Open to Novice if a win has been disallowed or the Junior miscalculated number of placements, provided this transfer must be made to the Superintendent prior to the judging of the class at the show.

PROGRAM OF JUDGING - THURSDAY, NOVEMBER 18, 2021

There are 1109 dogs entered this day with a total entry of 1120 – ENTRIES: Conformation 1105, Junior Showmanship 15

For your convenience, the following division of sexes has been carefully tabulated; however, neither the Club nor the Superintendent assumes responsibility for absolute accuracy. The number before each Breed (Variety) indicates the number of dogs entered in that Breed (Variety). The numbers following each Breed (Variety) indicate the number of Regular Class Dogs, Regular Class Bitches, Non-Regular Class Dogs or Bitches, and Best of Breed (Variety) (Dogs/Bitches).

OFFICIAL NOTICE: SUBSTITUTION OF JUDGES – Reference Chapter 7, Section 8 of AKC Rules: Owner has the right to withdraw his entry and have his entry fee refunded provided notification of his withdrawal is received no later than one half-hour prior to the start of any regular judging. **FROM KATHY FORBES TO LUIS SOSA** - Basenjis, Basset Hounds, Beagles (13" & 15"), English Foxhounds, Grand Basset Griffon Vendeens, Rhodesian Ridgebacks, Salukis, Scottish Deerhounds, Sloughis. **FROM ANNE CATTERSON TO LUIS SOSA** - Chow Chows, Dalmatians, Keeshond, Standard Poodles. **FROM SULIE GREENDALE-PAVEZA TO JANIE BOUSEK** - Retrievers (Chesapeake Bay), Retrievers (Nova Scotia Duck Tolling), Setters (Gordon), Setters (Irish), Spaniels (American Water), Spaniels (Irish Water). **FROM BRADLEY JENKINS TO JANIE BOUSEK** – Spaniels (Sussex). **FROM SULIE GREENDALE-PAVEZA TO PATRICIA TROTTER** – Bearded Collies, Cardigan Welsh Corgis.

BEST IN SHOW & VARIETY GROUPS THURSDAY GROUP JUDGING WILL BEGIN NO EARLIER THAN 2:30PM IN RINGS 1 & 2.

Group Order will be announced at 2:00PM.

TENTATIVE GROUP ORDER

Terrier Group J M Bousek
Hound Group Luis Sosa
Working Group R E Hutton*
Non-Sporting Group A K Catterson
Toy Group B Jenkins
Sporting Group S Greendale-Paveza
Herding Group S Greendale-Paveza
Best In Show R E Hutton

RING 1 – CARISSA A BOETTCHER=15

8:30AM

15 Jr Showmanship.. 1nj-1ni-1ns-2oj-2oi-8os

RING 1 – JOHN P WADE=105

9:15AM

41 Brussels Griffons 6-20-9/6

11:00AM

1 Biewer Terriers 0-0-1/0
1 Chinese Crested 1-2-5/1
7 Miniature Pinschers 2-2-3/0
8 Pomeranians 5-2-1/0

LUNCH

12:45PM

11 Havanese 3-7-0/1
1 Maltese 0-0-1/0
19 Shih Tzu 7-9-0/3
2 Silky Terriers 1-1-0/0
6 Toy Fox Terriers 1-3-1/1

RING 2 – PATRICIA V TROTTER=118

8:30AM

27 Boxers 7-13-4/3

9:30AM

3 Pointers (German Wirehaired)..... 0-1-2/0
4 Borzois 1-2-1/0
1 Greyhounds 0-0-0/1
4 Irish Wolfhounds..... 0-3-0/1
7 Norwegian Elkhounds 2-4-0/1
1 Otterhounds 0-0-0/1
3 Great Pyrenees 1-0-1/1
4 Newfoundland 1-1-1/1

10:30AM

4 Saint Bernards 1-0-2/1
7 Siberian Huskies 2-3-1/1
3 Bearded Collies 1-1-1/0
6 Bouviers des Flandres 3-2-1/0
2 Afghan Hounds 0-0-1/1
2 Standard Schnauzers 0-0-1/1
8 Whippets 2-5-0/1

LUNCH

12:30PM

11 Dachshunds (Longhaired) 1-5-5/0
9 Dachshunds (Smooth) 2-3-1/3
7 Dachshunds (Wirehaired) 1-1-1/4
5 Cardigan Welsh Corgis 2-3-0/0

RING 3 – SULIE GREENDALE-PAVEZA=71 OF 175

8:30AM

2 Beaucerons 0-1-1/0
6 Border Collies 3-2-1/0
2 Miniature American Shepherds... 0-1-1/0
1 Pembroke Welsh Corgis 0-1-0/0
1 Pulik 0-1-0/0

9:00AM

59 Bichons Frises 14-22-12/11
Moves to Ring 5 following lunch

RING 3 – 12:30PM

Bichon Frise Concurrent Specialty
See separate schedule

RING 4 – JANIE M BOUSEK=73

8:30AM

3 Weimaraners 0-1-1/1
3 Pointers 0-0-1/2
1 Barbits 0-0-1/0
11 Retrievers (Chesapeake Bay)..... 2-5-2/2
2 Retrievers (NSDT) 1-0-1/0
6 Wirehaired Vizslas 1-3-1/1

9:30AM

11 Setters (Irish) 4-1-3/3
9 Spaniels (Irish Water) 2-3-3/1
3 Wirehaired Pointing Griffons 0-1-2/0
1 Russell Terriers 0-0-0/1
2 West Highland White Terriers 1-0-1/0

10:30AM

1 Lagotti Romagnoli 0-1-0/0
1 Spaniels (American Water) 0-0-1/0
1 Spaniels (Sussex) 0-0-0/1
5 Soft Coated Wheaten Terriers 0-2-1/2
13 Setters (Gordon) 2-7-3/1

RING 5 – LUIS SOSA=52

8:30AM

1 English Foxhounds 0-0-0/1
9 Rhodesian Ridgebacks 2-3-4/0
2 Salukis 0-1-1/0
5 Scottish Deerhounds 3-2-0/0
4 Sloughis 2-1-1/0
2 Dalmatians 1-0-1/0
2 Basset Hounds 1-0-1/0
1 Grand Basset Griffon Vendeens... 1-0-0/0

9:30AM

1 Chow Chows 1-0-0/0
4 Keeshonden 2-0-2/0
2 Basenjis 1-1-0/0
2 Beagles (13 in. and under) 1-0-1/2
5 Beagles (over 13 in.) 1-1-2/1
10 Poodles (Standard) 5-4-0/1

RING 5 – SULIE GREENDALE-PAVEZA=104 OF 175

12:30PM

40 Doberman Pinschers 11-16-5/8

2:00PM

25 Australian Shepherds 5-12-3/5

3:00PM

1 Belgian Malinois 0-0-0/1
6 Belgian Sheepdogs 1-1-2/2
4 Belgian Tervuren 0-1-1/2
2 Berger Picards 0-0-1/1
1 Briards 0-0-1/0
13 Collies (Rough) 4-5-3/1
3 Collies (Smooth) 0-2-1/0
9 Shetland Sheepdogs 3-4-2/0

RING 6 – BRADLEY JENKINS=175

8:30AM

22 Retrievers (Labrador) 8-11-1/2
4 Brittany 1-0-1/2

9:30AM

17 Setters (English) 3-7-6/1
8 Retrievers (Flat-Coated) 3-3-2/0

10:30AM

48 Retrievers (Golden) 16-20-7/5

LUNCH

1:15PM

13 Vizslas 3-2-6/2
5 Pointers (German Shorthaired).... 1-2-2/0

2:00PM

3 Spinoni Italiani 1-1-0/1
3 Retrievers (Curly-Coated) 0-0-2/1
1 Setters (Irish Red and White) 0-0-0/1
11 Spaniels (English Cocker) 4-4-3/0
8 Spaniels (Cocker) Parti 3-4-1/0

3:00PM

2 Spaniels (Cocker) ASCOB 0-1-1/0
7 Spaniels (Clumber) 2-2-2/1
9 Spaniels (English Springer) 2-4-2/1
8 Spaniels (Field) 2-4-1/1
6 Spaniels (Welsh Springer) 2-3-0/1

RING 7 – LINDA ROBEY=112

8:30AM

18 Great Danes 5-10-2/1
8 Greater Swiss Mountain Dogs 2-5-1/0

9:30AM

16 Bernese Mountain Dogs 7-4-5/0
7 Alaskan Malamutes 1-1-3/2
2 Bullmastiffs 1-1-0/0

10:30AM

14 Portuguese Water Dogs 4-6-4/0
8 Rottweilers 2-0-4/2
2 Giant Schnauzers 0-2-0/0
1 Kuvaszok 0-0-0/1

11:30AM

7 Leonbergers 2-1-2/2
7 Mastiffs 2-1-4/0

LUNCH

1:00PM

22 Polish Lowland Sheepdogs 3-10-4/5

RING 8 – ROBERT E HUTTON=98

8:30AM

9 Fox Terriers (Smooth) 1-5-2/1
2 Australian Terriers 0-1-1/0
3 Parson Russell Terriers 0-2-1/0
5 Border Terriers 1-3-0/1
7 Glen of Imaal Terriers 4-0-2/1

9:30AM

10 Cairn Terriers 2-6-2/0
3 Cesky Terriers 0-1-1/1
5 Fox Terriers (Wire) 1-2-1/1
8 Bedlington Terriers 2-5-1/0

10:30AM

1 Lakeland Terriers 0-1-0/0
8 Miniature Schnauzers 1-6-0/1
1 Norfolk Terriers 0-0-1/0
2 Norwich Terriers 0-1-1/0
7 Scottish Terriers 2-2-1/2
3 Sealyham Terriers 0-1-0/2
5 Airedale Terriers 0-2-1/2

11:30AM

8	German Shepherd Dogs.....	4-3-0/1
10	Old English Sheepdogs.....	1-4-1/4
1	Kerry Blue Terriers	0-0-0/1

RING 8 – ED FOJTIK=22**12:30PM**

4	Akitas	1-2-1/0
3	Cane Corso.....	0-1-2/0
1	German Pinschers.....	0-1-0/0
14	Samoyeds.....	4-6-2/2

RINGS 9-10-11 NOT USED**RING 12 ANNE K CATTERSON=175****8:30AM**

3	Bulldogs	2-0-0/1
4	Chinese Shar-Pei	1-1-1/1
11	Boston Terriers.....	2-5-3/1

9:15AM

44	French Bulldogs	12-23-5/4
----	-----------------------	-----------

11:00AM

24	Pugs	4-14-4/2
1	Poodles (Toy).....	0-0-0/1

LUNCH**12:45PM**

6	Affenpinschers	2-4-0/0
18	Cavalier King Charles Spaniels	5-5-7/1
2	Poodles (Miniature)	0-2-0/0

1:45PM

7	Japanese Chin	2-2-2/1
10	Lhasa Apsos	5-2-2/1
8	Yorkshire Terriers	1-6-1/0

2:45PM

4	Coton de Tulear	1-1-0/2
5	Lowchen.....	1-4-0/0
1	Schipperkes.....	0-1-0/0
6	Shiba Inu	2-2-2/0
1	Tibetan Terriers.....	0-1-0/0
3	American Eskimo Dogs	0-0-2/1
9	Papillons.....	4-2-2/0
1	Lancashire Heelers.....	0-1-0/0
7	Danish-Swedish Farmdogs.....	3-4-0/0

INDEX OF BREEDS – THURSDAY

The entry figures are not to be taken as a representation on the part of the Superintendent that all dogs entered will be present on the Show day. If there is a discrepancy between this Index and the Judging Schedule by ring, the Judging Schedule takes precedence.

#	BREED	R	TIME
6	AFFENPINSCHERS	12	12:45PM
2	AFGHAN HOUNDS	2	10:30AM
5	AIREDALE TERRIERS	8	10:30AM
4	AKITAS	8	12:30PM
7	ALASKAN MALAMUTES	7	9:30AM
3	AMERICAN ESKIMO DOGS	12	2:45PM
25	AUSTRALIAN SHEPHERDS	5	2:00PM
2	AUSTRALIAN TERRIERS	8	8:30AM
1	BARBETS	4	8:30AM
2	BASENJIS	5	9:30AM
2	BASSET HOUNDS	5	8:30AM
4	BEAGLES (13 IN. AND UNDER)	5	9:30AM
5	BEAGLES (OVER 13 IN.)	5	9:30AM
3	BEARDED COLLIES	2	10:30AM
2	BEAUCERONS	3	8:30AM
8	BEDLINGTON TERRIERS	8	9:30AM
1	BELGIAN MALINOIS	5	3:00PM
6	BELGIAN SHEEPDOGS	5	3:00PM
4	BELGIAN Tervuren	5	3:00PM
2	BERGER PICARDS	5	3:00PM
16	BERNESE MOUNTAIN DOGS	7	9:30AM
59	BICHONS FRISES	3	9:00AM
1	BIEWER TERRIERS	1	11:00AM
6	BORDER COLLIES	3	8:30AM
5	BORDER TERRIERS	8	8:30AM
4	BORZOIS	2	9:30AM
11	BOSTON TERRIERS	12	8:30AM
6	BOUVIERS DES Flandres	2	10:30AM
27	BOXERS	2	8:30AM
1	BRIARDS	5	3:00PM
4	BRITTANYS	6	8:30AM
41	BRUSSELS GRIFFONS	1	9:15AM
3	BULLDOGS	12	8:30AM
2	BULLMASTIFFS	7	9:30AM
10	CAIRN TERRIERS	8	9:30AM
3	CANE CORSO	8	12:30PM
5	CARDIGAN WELSH CORGIS	2	12:30PM
18	CAVALIER KING CHARLES SPAN	12	12:45PM
3	CESKY TERRIERS	8	9:30AM
9	CHINESE CRESTED	1	11:00AM
4	CHINESE SHAR-PEI	12	8:30AM
1	CHOW CHOWS	5	9:30AM
13	COLLIES (ROUGH)	5	3:00PM
3	COLLIES (SMOOTH)	5	3:00PM
4	COTON DE TULEAR	12	2:45PM
11	DACHSHUNDS (LONGHAIR)	2	12:30PM
9	DACHSHUNDS (SMOOTH)	2	12:30PM
7	DACHSHUNDS (WIREHAIR)	2	12:30PM
2	DALMATIANS	5	8:30AM
7	DANISH-SWEDISH FARMDOGS	12	2:45PM
40	DOBERMAN PINSCHERS	5	12:30PM
1	ENGLISH FOXHOUNDS	5	8:30AM
9	FOX TERRIERS (SMOOTH)	8	8:30AM
5	FOX TERRIERS (WIRE)	8	9:30AM
44	FRENCH BULLDOGS	12	9:15AM
1	GERMAN PINSCHERS	8	12:30PM
8	GERMAN SHEPHERD DOGS	8	11:30AM
2	GIANT SCHNAUZERS	7	10:30AM
7	GLEN OF IMAAL TERRIERS	8	8:30AM
1	GRAND BASSET GRIFFON VEND	5	8:30AM
18	GREAT DANES	7	8:30AM
3	GREAT PYRENEES	2	9:30AM
8	GREATER SWISS MTN DOGS	7	8:30AM
1	GREYHOUNDS	2	9:30AM
11	HAVANESE	1	12:45PM
4	IRISH WOLFHOUSES	2	9:30AM
7	JAPANESE CHIN	12	1:45PM
15	JUNIOR SHOWMANSHIP	1	8:30AM
4	KEESHONDEN	5	9:30AM
1	KERRY BLUE TERRIERS	8	11:30AM
1	KUVASZOK	7	10:30AM
1	LAGOTTI ROMAGNOLI	4	10:30AM
1	LAKELAND TERRIERS	8	10:30AM
1	LANCASHIRE HEELERS	12	2:45PM
7	LEONBERGERS	7	11:30AM

#	BREED	R	TIME
10	LHASA APSOS	12	1:45PM
5	LOWCHEN	12	2:45PM
1	MALTESE	1	12:45PM
7	MASTIFFS	7	11:30AM
2	MINIATURE AMER SHEPHERDS	3	8:30AM
7	MINIATURE PINSCHERS	1	11:00AM
8	MINIATURE SCHNAUZERS	8	10:30AM
4	NEWFOUNDLANDS	2	9:30AM
1	NORFOLK TERRIERS	8	10:30AM
7	NORWEGIAN ELKHOUNDS	2	9:30AM
2	NORWICH TERRIERS	8	10:30AM
10	OLD ENGLISH SHEEPDOGS	8	11:30AM
1	OTTERHOUNDS	2	9:30AM
9	PAPILLONS	12	2:45PM
3	PARSON RUSSELL TERRIERS	8	8:30AM
1	PEMBROKE WELSH CORGIS	3	8:30AM
3	POINTERS	4	8:30AM
5	POINTERS (GER SHORTHAIRED)	6	1:15PM
3	POINTERS (GER WIREHAIR)	2	9:30AM
22	POLISH LOWLAND SHEEPDOGS	7	1:00PM
8	POMERANIANS	1	11:00AM
2	POODLES (MINIATURE)	12	12:45PM
10	POODLES (STANDARD)	5	9:30AM
1	POODLES (TOY)	12	11:00AM
14	PORTUGUESE WATER DOGS	7	10:30AM
24	PUGS	12	11:00AM
1	PULK	3	8:30AM
11	RETRIEVERS (CHESAPEAKE BAY)	4	8:30AM
3	RETRIEVERS (CURLY-COATED)	6	2:00PM
8	RETRIEVERS (FLAT-COATED)	6	9:30AM
48	RETRIEVERS (GOLDEN)	6	10:30AM
22	RETRIEVERS (LABRADOR)	6	8:30AM
2	RETRIEVERS (NSDT)	4	8:30AM
9	RHODESIAN RIDGEBACKS	5	8:30AM
8	ROTTWEILERS	7	10:30AM
1	RUSSELL TERRIERS	4	9:30AM
4	SAINT BERNARDS	2	10:30AM
2	SALUKIS	5	8:30AM
14	SAMOYEDS	8	12:30PM
1	SCHIPPERKES	12	2:45PM
5	SCOTTISH DEERHOUNDS	5	8:30AM
7	SCOTTISH TERRIERS	8	10:30AM
3	SEALYHAM TERRIERS	8	10:30AM
17	SETTERS (ENGLISH)	6	9:30AM
13	SETTERS (GORDON)	4	10:30AM
1	SETTERS (IRISH RED & WHITE)	6	2:00PM
11	SETTERS (IRISH)	4	9:30AM
9	SHETLAND SHEEPDOGS	5	3:00PM
6	SHIBA INU	12	2:45PM
19	SHIH TZU	1	12:45PM
7	SIBERIAN HUSKIES	2	10:30AM
2	SILKY TERRIERS	1	12:45PM
4	SLOUGHIS	5	8:30AM
5	SOFT COATED WHEATEN TERR	4	10:30AM
1	SPANIELS (AMERICAN WATER)	4	10:30AM
7	SPANIELS (CLUMBER)	6	3:00PM
2	SPANIELS (COCKER) ASCOB	6	3:00PM
8	SPANIELS (COCKER) PARTI	6	2:00PM
11	SPANIELS (ENGLISH COCKER)	6	2:00PM
9	SPANIELS (ENGLISH SPRINGER)	6	3:00PM
8	SPANIELS (FIELD)	6	3:00PM
9	SPANIELS (IRISH WATER)	4	9:30AM
1	SPANIELS (SUSSEX)	4	10:30AM
6	SPANIELS (WELSH SPRINGER)	6	3:00PM
3	SPINONI ITALIANI	6	2:00PM
2	STANDARD SCHNAUZERS	2	10:30AM
1	TIBETAN TERRIERS	12	2:45PM
6	TOY FOX TERRIERS	1	12:45PM
13	VIZSLAS	6	1:15PM
3	WEIMARANERS	4	8:30AM
2	WEST HIGHLAND WHITE TERR	4	9:30AM
8	WHIPPETS	2	10:30AM
3	WIREHAIR POINTING GRIFF	4	9:30AM
6	WIREHAIR VIZSLAS	4	8:30AM
8	YORKSHIRE TERRIERS	12	1:45PM

PROGRAM OF JUDGING - FRIDAY, NOVEMBER 19, 2021

There are 1263 dogs entered this day with a total entry of 1277 – ENTRIES: Conformation 1257, Junior Showmanship 20

For your convenience, the following division of sexes has been carefully tabulated; however, neither the Club nor the Superintendent assumes responsibility for absolute accuracy. The number before each Breed (Variety) indicates the number of dogs entered in that Breed (Variety). The numbers following each Breed (Variety) indicate the number of Regular Class Dogs, Regular Class Bitches, Non-Regular Class Dogs or Bitches, and Best of Breed (Variety) (Dogs/Bitches). **OFFICIAL NOTICE: SUBSTITUTION OF JUDGES** – Reference Chapter 7, Section 8 of AKC Rules: Owner has the right to withdraw his entry and have his entry fee refunded provided notification of his withdrawal is received no later than one half-hour prior to the start of any regular judging. FROM LISA GRASER TO BRADLEY JENKINS – Affenpinschers, Havanese, Japanese Chin, Maltese. FROM LISA GRASER TO PATRICIA TROTTER – Pomeranians, Shih Tzus. FROM LISA GRASER TO JOHN WADE – Chihuahua (Long Coat). FROM GEIR FLYCKT-PEDERSEN TO LLOYD GRASER – Junior Showmanship.

BEST IN SHOW & VARIETY GROUPS

FRIDAY GROUP JUDGING WILL BEGIN NO

EARLIER THAN 3:00PM IN RINGS 1 & 2.

Group Order will be announced at 2:30PM.

TENTATIVE GROUP ORDER

Hound Group John Wade
Terrier Group John Wade
Herding Group Lloyd Graser Jr.
Sporting Group Bradley Jenkins
Non-Sporting Group Robert Hutton
Working Group Patricia Trotter
Toy Group John Wade
Best In Show Linda Robey

RING 1 – JOHN P WADE=33 OF 122

8:00AM

6 Airedale Terriers 1-2-1/2
27 Australian Shepherds 6-13-3/5

RING 1 – LISA GRASER=52 OF 165

10:00AM

11 Chinese Crested 2-3-5/1
41 Brussels Griffons 6-20-9/6

RING 2 – PATRICIA V TROTTER=90

8:00AM

4 Sloughis 2-1-1/0
4 Brittans 1-0-1/2
1 English Foxhounds 0-0-0/1
1 Harriers 0-1-0/0
13 Rhodesian Ridgebacks 3-6-3/1
2 Salukis 0-1-1/0
1 Kuvaszok 0-0-0/1

9:00AM

10 Scottish Deerhounds 4-2-1/3
6 Pomeranians 7-2-1/0
6 Beagles (over 13 in.) 1-2-2/1

10:00AM

4 Beagles (13 in. and under) 1-0-1/2
1 Basenjis 1-0-0/0
21 Shih Tzu 8-10-0/3
11 Basset Hounds 1-6-2/2
1 Grand Basset Griffon Vendeens ... 1-0-0/0

RING 2 – MARY LYNN SPEER=8

11:30AM

8 Rottweilers 2-0-4/2

RING 2 – ED FOJTIK=33

12:15PM

17 Setters (English) 4-7-5/1
16 Bernese Mountain Dogs 7-4-5/0

RING 3 – ROBERT E HUTTON=100 OF 130

8:00AM

12 Boston Terriers 3-5-3/1
11 Shiba Inu 3-4-3/1
3 American Eskimo Dogs 0-0-2/1

9:00AM

56 Bichons Frises 13-21-12/10

11:15AM

6 Poodles (Miniature) 1-3-0/2
10 Lhasa Apsos 5-3-2/0
2 Keeshonden 0-0-2/0

RING 3 – 12:00PM

Bichon Frise Concurrent Specialty
See separate schedule

RING 4 – BRADLEY JENKINS=113

8:00AM

6 Affenpinschers 2-4-0/0
7 Japanese Chin 2-2-2/1
14 Havanese 3-8-1/2

9:00AM

1 Maltese 0-0-1/0
1 Barbets 0-0-1/0
1 Lagotti Romagnoli 0-1-0/0
3 Pointers (German Wirehaired) 0-1-2/0
12 Retrievers (Chesapeake Bay) 2-6-2/2

9:45AM

11 Norwegian Elkhounds 2-7-1/1
15 Mastiffs 5-5-4/0

10:45AM

17 Setters (Gordon) 2-8-4/3
13 Setters (Irish) 5-1-4/3
6 Wirehaired Vizslas 1-3-1/1
3 Afghan Hounds 0-1-1/1
1 Otterhounds 0-0-0/1
2 Retrievers (Nova Scotia Duck Toll) 1-0-1/0
2 Spaniels (American Water) 0-0-1/1

RING 4 – 2:00PM

Mastiff Concurrent Specialty
See separate schedule

RING 5 – GEIR FLYCKT-PEDERSEN=165

8:00AM

5 Pointers (German Shorthaired) 0-2-3/0
22 Retrievers (Labrador) 8-11-1/2

9:00AM

3 Retrievers (Curly-Coated) 0-0-2/1
10 Retrievers (Flat-Coated) 4-4-2/0
3 Pointers 0-0-1/2
4 Borzois 1-2-1/0
1 Greyhounds 0-0-0/1
4 Irish Wolfhounds 0-2-0/2

10:00AM

48 Retrievers (Golden) 15-21-7/5

LUNCH

12:45PM

14 Collies (Rough) 3-7-3/1
4 Collies (Smooth) 0-3-1/0
6 German Shepherd Dogs 2-3-0/1
9 Whippets 2-6-0/1

2:00PM

5 Cardigan Welsh Corgis 2-3-0/0
9 Dachshunds (Longhaired) 1-4-4/0
10 Dachshunds (Smooth) 2-3-1/4
7 Dachshunds (Wirehaired) 1-1-1/4
1 Pembroke Welsh Corgis 0-1-0/0

RING 6 – PATRICIA A SOSA=112

8:00AM

20 Great Danes 6-11-2/1
5 Newfoundlands 1-2-1/1

9:00AM

7 Siberian Huskies 2-3-1/1
16 Portuguese Water Dogs 4-7-4/1
2 Standard Schnauzers 0-0-1/1

10:00AM

62 Doberman Pinschers 18-28-6/10

RING 6 – 1:00PM

Doberman Concurrent Specialty
See separate schedule

RING 7 – LLOYD GRASER JR.=20 OF 74

8:00AM

20 Jr Showmanship 1nj-1ni-1ns-4oj-4oi-10os

RING 7 – LISA GRASER=22 OF 165

9:00AM

22 Polish Lowland Sheepdogs 3-10-4/5

RING 7 – LLOYD GRASER JR.=54 OF 74

10:00AM

2 Miniature American Shepherds ... 0-1-1/0
1 Pulik 0-1-0/0
9 Shetland Sheepdogs 3-4-2/0
3 Bearded Collies 1-1-1/0
3 Beaucerons 0-1-2/0
1 Belgian Malinois 0-0-0/1
8 Belgian Sheepdogs 2-2-2/2

11:00AM

6 Belgian Tervuren 1-2-1/2
2 Berger Picards 0-0-1/1
8 Border Collies 4-3-1/0
1 Briards 0-0-1/0
10 Old English Sheepdogs 1-4-1/4

RING 7 – 12:30PM

Polish Lowland Sheepdog Concurrent Specialty
See separate schedule

RING 8 – LINDA ROBEY=103

8:00AM

19 Vizslas 5-6-4/4
6 Weimaraners 0-3-2/1

9:00AM

3 Spinoni Italiani 1-1-0/1
1 Setters (Irish Red and White) 0-0-0/1
11 Spaniels (Irish Water) 2-4-3/2

9:45AM

4 Wirehaired Pointing Griffons 0-2-2/0
2 Spaniels (Cocker) ASCOB 0-1-1/0
12 Spaniels (English Cocker) 5-4-3/0
8 Spaniels (Cocker) Parti 3-4-1/0

10:45AM

9 Spaniels (English Springer) 2-4-2/1
9 Spaniels (Clumber) 2-4-2/1
12 Spaniels (Field) 3-6-2/1
1 Spaniels (Sussex) 0-0-0/1
6 Spaniels (Welsh Springer) 2-3-0/1

RING 8 – ROBERT E HUTTON=30 OF 130

12:45PM

5 Lowchen 1-4-0/0
1 Schipperkes 0-1-0/0
1 Tibetan Terriers 0-1-0/0
11 Poodles (Standard) 6-4-0/1
9 Leonbergers 3-2-2/2
3 Dalmatians 2-0-1/0

RING 9 – DIANE COLLINGS=34

8:00AM

5 Akitas 1-3-1/0
3 Bullmastiffs 1-1-0/1
3 Cane Corso 0-1-2/0
8 Alaskan Malamutes 1-2-3/2
1 Black Russian Terriers 0-0-1/0
1 German Pinschers 0-1-0/0
3 Great Pyrenees 1-0-1/1
10 Greater Swiss Mountain Dogs 3-5-2/0

RING 9 – SULIE GREENDALE-PAVEZA=55 OF 126**10:00AM**

29	Boxers	8-13-5/3
9	Bouviere des Flandres	4-3-2/0

11:30AM

17	Samoyeds.....	6-7-2/2
----	---------------	---------

RING 9 – 12:15PM

Bouvier des Flandres Concurrent Specialty
See separate schedule

RING 9 – 12:45PM

Boxer Concurrent Specialty
See separate schedule

RING 9 – SULIE GREENDALE-PAVEZA=25 OF 126**2:00PM**

2	Giant Schnauzers	0-2-0/0
4	Saint Bernards.....	1-0-2/1
2	Bulldogs	1-0-0/1
4	Chinese Shar-Pei	1-1-1/1
1	Chow Chows	1-0-0/0
4	Coton de Tulear	1-1-0/2
1	Lancashire Heelers.....	0-1-0/0
7	Danish-Swedish Farmdogs	3-4-0/0

RING 10 – JOHN P WADE=89 OF 122**9:30AM**

5	Soft Coated Wheaten Terriers.....	0-2-1/2
1	Kerry Blue Terriers	0-0-0/1
3	Australian Terriers	1-1-1/0
8	Bedlington Terriers.....	2-5-1/0
5	Border Terriers	1-3-0/1
4	Cesky Terriers.....	0-1-2/1

10:30AM

10	Cairn Terriers.....	2-6-2/0
7	Fox Terriers (Smooth).....	1-5-1/0
8	Miniature Schnauzers	1-6-0/1

11:30AM

5	Fox Terriers (Wire)	1-2-1/1
7	Glen of Imaal Terriers.....	4-0-2/1

LUNCH**12:45PM**

1	Lakeland Terriers.....	0-1-0/0
1	Norfolk Terriers	0-0-1/0
2	Norwich Terriers	0-1-1/0
3	Parson Russell Terriers	0-2-1/0
1	Russell Terriers.....	0-0-0/1
7	Scottish Terriers	2-2-1/2
8	Sealyham Terriers	1-3-1/3
2	West Highland White Terriers	1-0-1/0
1	Chihuahuas (Long Coat)	0-0-1/0

RING 11 – LISA GRASER=91 OF 165**1:30PM**

7	Miniature Pinschers	2-2-3/0
8	Biewer Terriers	2-5-1/0
8	Papillons.....	4-2-2/0
2	Pekingese.....	1-0-1/0
2	Silky Terriers.....	1-1-0/0

2:30PM

25	Pugs	4-15-4/2
----	------------	----------

3:30PM

7	Toy Fox Terriers	1-4-1/1
8	Yorkshire Terriers	1-6-1/0
20	Cavalier King Charles Spaniels	6-6-7/1
4	Poodles (Toy).....	0-2-0/2

RING 12 – SULIE GREENDALE-PAVEZA=46 OF 126**8:00AM**

46	French Bulldogs	13-24-5/4
----	-----------------------	-----------

RING 12 – 1:15PM

French Bulldog Concurrent Specialty
See separate schedule

INDEX OF BREEDS – FRIDAY

The entry figures are not to be taken as a representation on the part of the Superintendent that all dogs entered will be present on the Show day. If there is a discrepancy between this Index and the Judging Schedule by ring, the Judging Schedule takes precedence.

#	BREED	R	TIME
6	AFKENPINSCHERS	4	8:00AM
3	AFGHAN HOUNDS	4	10:45AM
6	AIREDALE TERRIERS	1	8:00AM
5	AKITAS	9	8:00AM
8	ALASKAN MALAMUTES	9	8:00AM
3	AMERICAN ESKIMO DOGS	3	8:00AM
27	AUSTRALIAN SHEPHERDS	1	8:00AM
3	AUSTRALIAN TERRIERS	10	9:30AM
1	BARBETS	4	9:00AM
1	BASENJIS	2	10:00AM
11	BASSET HOUNDS	2	10:00AM
4	BEAGLES (13")	2	10:00AM
6	BEAGLES (15")	2	9:00AM
3	BEARDED COLLIES	7	10:00AM
3	BEAUCERONS	7	10:00AM
8	BEDLINGTON TERRIERS	10	9:30AM
1	BELGIAN MALINOIS	7	10:00AM
8	BELGIAN SHEEPDOGS	7	10:00AM
6	BELGIAN TERVUREN	7	11:00AM
2	BERGER PICARDS	7	11:00AM
16	BERNESE MOUNTAIN DOGS	2	12:15PM
56	BICHONS FRISES	3	9:00AM
8	BIEWER TERRIERS	11	1:30PM
1	BLACK RUSSIAN TERRIERS	9	8:00AM
8	BORDER COLLIES	7	11:00AM
5	BORDER TERRIERS	10	9:30AM
4	BORZOIS	5	9:00AM
12	BOSTON TERRIERS	3	8:00AM
9	BOUVIERS DES FLANDRES	9	10:00AM
33	BOXER CONCURRENT	9	12:45PM
29	BOXERS	9	10:00AM
1	BRIARDS	7	11:00AM
4	BRITTANY	2	8:00AM
41	BRUSSELS GRIFFONS	1	10:00AM
2	BULLDOGS	9	2:00PM
3	BULLMASTIFFS	9	8:00AM
10	CAIRN TERRIERS	10	10:30AM
3	CANE CORSO	9	8:00AM
5	CARDIGAN WELSH CORGIS	5	2:00PM
20	CAVALIER KING CHARLES SPAN	11	3:30PM
4	CESKY TERRIERS	10	9:30AM
1	CHIHUAHUAS (LONG COAT)	10	12:45PM
11	CHINESE CRESTED	1	10:00AM
4	CHINESE SHAR-PEI	9	2:00PM
1	CHOW CHOWS	9	2:00PM
14	COLLIES (ROUGH)	5	12:45PM
4	COLLIES (SMOOTH)	5	12:45PM
4	COTON DE TULEAR	9	2:00PM
9	DACHSHUNDS (LONGHAIR)	5	2:00PM
10	DACHSHUNDS (SMOOTH)	5	2:00PM
7	DACHSHUNDS (WIREHAIR)	5	2:00PM
3	DALMATIANS	8	12:45PM
7	DANISH-SWEDISH FARMDOGS	9	2:00PM
62	DOBERMAN PINSCHERS	6	10:00AM
1	ENGLISH FOXHOUNDS	2	8:00AM
7	FOX TERRIERS (SMOOTH)	10	10:30AM
5	FOX TERRIERS (WIRE)	10	11:30AM
46	FRENCH BULLDOGS	12	8:00AM
1	GERMAN PINSCHERS	9	8:00AM
6	GERMAN SHEPHERD DOGS	5	12:45PM
2	GIANT SCHNAUZERS	9	2:00PM
7	GLEN OF IMAAL TERRIERS	10	11:30AM
1	GRAND BASSET GRIFFON VEND	2	10:00AM
20	GREAT DANES	6	8:00AM
3	GREAT PYRENEES	9	8:00AM
10	GREATER SWISS MTN DOGS	9	8:00AM
1	GREYHOUNDS	5	9:00AM
1	HARRIERS	2	8:00AM
14	HAVANESE	4	8:00AM
4	IRISH WOLFHOUSES	5	9:00AM
7	JAPANESE CHIN	4	8:00AM
20	JUNIOR SHOWMANSHIP	7	8:00AM
2	KEESHONDEN	3	11:15AM
1	KERRY BLUE TERRIERS	10	9:30AM
1	KUVASZOK	2	8:00AM
1	LAGOTTI ROMAGNOLI	4	9:00AM
1	LAKELAND TERRIERS	10	12:45PM
1	LANCASHIRE HEELERS	9	2:00PM
9	LEONBERGERS	8	12:45PM

#	BREED	R	TIME
10	LHASA APSOS	3	11:15AM
5	LOWCHEN	8	12:45PM
1	MALTESE	4	9:00AM
26	MASTIFF CONCURRENT	4	2:00PM
15	MASTIFFS	4	9:45AM
2	MIN AMER SHEPHERDS	7	10:00AM
7	MINIATURE PINSCHERS	11	1:30PM
8	MINIATURE SCHNAUZERS	10	10:30AM
5	NEWFOUNDLANDS	6	8:00AM
1	NORFOLK TERRIERS	10	12:45PM
11	NORWEGIAN ELKHOUNDS	4	9:45AM
2	NORWICH TERRIERS	10	12:45PM
10	OLD ENGLISH SHEEPDOGS	7	11:00AM
1	OTTERHOUNDS	4	10:45AM
8	PAPILLONS	11	1:30PM
3	PARSON RUSSELL TERRIERS	10	12:45PM
2	PEKINGESE	11	1:30PM
1	PEMBROKE WELSH CORGIS	5	2:00PM
3	POINTERS	5	9:00AM
5	POINTERS (GER SHORTHAIRED)	5	8:00AM
3	POINTERS (GER WIREHAIR)	4	9:00AM
22	POLISH LOWLAND SHEEPDOGS	7	9:00AM
10	POMERANIANS	2	9:00AM
6	POODLES (MINIATURE)	3	11:15AM
11	POODLES (STANDARD)	8	12:45PM
4	POODLES (TOY)	11	3:30PM
16	PORTUGUESE WATER DOGS	6	9:00AM
25	PUGS	11	2:30PM
1	PULIK	7	10:00AM
12	RETRIEVERS (CHESAPEAKE BAY)	4	9:00AM
3	RETRIEVERS (CURLY-COATED)	5	9:00AM
10	RETRIEVERS (FLAT-COATED)	5	9:00AM
48	RETRIEVERS (GOLDEN)	5	10:00AM
22	RETRIEVERS (LABRADOR)	5	8:00AM
2	RETRIEVERS (NSDTOLL)	4	10:45AM
13	RHODESIAN RIDGEBACKS	2	8:00AM
8	ROTTWEILERS	2	11:30AM
1	RUSSELL TERRIERS	10	12:45PM
4	SAINT BERNARDS	9	2:00PM
2	SALUKIS	2	8:00AM
17	SAMOYEDS	9	11:30AM
1	SCHIPPERKES	8	12:45PM
10	SCOTTISH DEERHOUNDS	2	9:00AM
7	SCOTTISH TERRIERS	10	12:45PM
8	SEALYHAM TERRIERS	10	12:45PM
17	SETTERS (ENGLISH)	2	12:15PM
17	SETTERS (GORDON)	4	10:45AM
1	SETTERS (IRISH RED AND WHITE)	8	9:00AM
13	SETTERS (IRISH)	4	10:45AM
9	SHETLAND SHEEPDOGS	7	10:00AM
11	SHIBA INU	3	8:00AM
21	SHIH TZU	2	10:00AM
7	SIBERIAN HUSKIES	6	9:00AM
2	SILKY TERRIERS	11	1:30PM
4	SLOUGHIS	2	8:00AM
5	SOFT COATED WHEATEN TERRIERS	10	9:30AM
2	SPANIELS (AMERICAN WATER)	4	10:45AM
9	SPANIELS (CLUMBER)	8	10:45AM
2	SPANIELS (COCKER) ASCOB	8	9:45AM
8	SPANIELS (COCKER) PARTI	8	9:45AM
12	SPANIELS (ENGLISH COCKER)	8	9:45AM
9	SPANIELS (ENGLISH SPRINGER)	8	10:45AM
12	SPANIELS (FIELD)	8	10:45AM
11	SPANIELS (IRISH WATER)	8	9:00AM
1	SPANIELS (SUSSEX)	8	10:45AM
6	SPANIELS (WELSH SPRINGER)	8	10:45AM
3	SPINONI ITALIANI	8	9:00AM
2	STANDARD SCHNAUZERS	6	9:00AM
1	TIBETAN TERRIERS	8	12:45PM
7	TOY FOX TERRIERS	11	3:30PM
19	VIZSLAS	8	8:00AM
6	WEIMARANERS	8	8:00AM
2	WEST HIGHLAND WHITE TERRIERS	10	12:45PM
9	WHIPPETS	5	12:45PM
4	WIREHAIR POINTING GRIFF	8	9:45AM
6	WIREHAIR VIZSLAS	4	10:45AM
8	YORKSHIRE TERRIERS	11	3:30PM

PROGRAM OF JUDGING - SATURDAY, NOVEMBER 20, 2021

There are 1472 dogs entered this day with a total entry of 1506 – ENTRIES: Conformation 1460, Junior Showmanship 34, 12 Sweepstakes

For your convenience, the following division of sexes has been carefully tabulated; however, neither the Club nor the Superintendent assumes responsibility for absolute accuracy. The number before each Breed (Variety) indicates the number of dogs entered in that Breed (Variety). The numbers following each Breed (Variety) indicate the number of Regular Class Dogs, Regular Class Bitches, Non-Regular Class Dogs or Bitches, and Best of Breed (Variety) (Dogs/Bitches). **OFFICIAL NOTICE: SUBSTITUTION OF JUDGES** – Reference Chapter 7, Section 8 of AKC Rules: Owner has the right to withdraw his entry and have his entry fee refunded provided notification of his withdrawal is received no later than one half-hour prior to the start of any regular judging. FROM GEIR FLYCKT PEDERSEN TO STEVE HAYDEN – Standard Poodles. FROM BRADLEY JENKINS TO STEVE HAYDEN – Sealyham Terriers. FROM PATRICIA TROTTER TO STEVE HAYDEN – Black Russian Terriers, Bullmastiffs, Chihuahuas (Long), Chinese Cresteds.

BEST IN SHOW & VARIETY GROUPS

SATURDAY GROUP JUDGING WILL BEGIN NO
EARLIER THAN 3:30PM IN RINGS 1 & 2.

Group Order will be announced at 3:00PM.

TENTATIVE GROUP ORDER

Terrier Group Bradley Jenkins*
Non-Sporting Group Patricia Sosa
Herding Group Linda Robey
Toy Group Patricia Trotter
Sporting Group Patricia Trotter
Hound Group Robert Hutton
Working Group John Wade
Best In Show Lloyd Graser

RING 1 – PATRICIA V TROTTER=102 OF 175

8:00AM

10 Pointers (German Shorthaired).... 1-4-4/1
11 Retrievers (NSDT) 3-4-2/2
1 Lagotti Romagnoli 0-1-0/0
4 Nederlandse Kooikerhondjes 2-0-2/0

9:00AM

42 Brussels Griffons 7-20-8/7

10:45AM

22 Cavalier King Charles Spaniels 8-6-7/1
5 Affenpinschers 1-4-0/0
7 Japanese Chin 2-2-2/1

RING 1 – 12:45PM

Brussels Griffons Concurrent Specialty
See Separate Schedule

RING 2 – LLOYD GRASER JR. = 58 OF 121

8:00AM

18 Retrievers (Labrador) 6-10-1/1
7 Weimaraners 0-4-2/1

9:00AM

3 Pointers 0-0-1/2
8 Brittany's 1-2-3/2
1 Barbets 0-0-1/0
2 Pointers (German Wirehaired).... 0-1-1/0
11 Retrievers (Curly-Coated) 2-4-3/2
8 Retrievers (Flat-Coated) 3-4-1/0

RING 2 – NANCY GASSER=4

10:30AM

3 Newfoundland Sweeps. 1(9-12D), 2(6-9B)
1 Newfoundland Vet Sweeps 1(8-9B)

RING 2 – BETH DOWNEY=31 OF 102

10:45AM

13 Newfoundlands 5-4-2/2
10 Alaskan Malamutes 1-4-2/3
8 Saint Bernards 3-2-2/1

RING 2 – LLOYD GRASER JR.=63 OF 121

1:00PM

50 Retrievers (Golden) 16-22-7/5
2 Giant Schnauzers 0-2-0/0
11 Pomeranians 7-2-2/0

RING 3 – JOHN P WADE=88 OF 135

8:00AM

10 Collies (Smooth) 2-6-2/0
8 German Shepherd Dogs 2-4-1/1
2 Miniature American Shepherds... 0-0-1/1
3 Pembroke Welsh Corgis 1-2-0/0
1 Pulik 0-1-0/0

9:00AM

56 Bichons Frises 13-22-11/10

11:15AM

9 Bouviers des Flandres 4-3-2/0

RING 3 – 12:00PM

Bouvier des Flandres Concurrent Specialty
See Separate Schedule

RING 3 – 12:30PM

Bichon Frise Concurrent Specialty
See Separate Schedule

RING 4 – PATRICIA A SOSA=84

8:00AM

10 Chinese Shar-Pei 2-4-2/2
1 Chow Chows 1-0-0/0
8 Keeshonden 4-1-3/0
3 American Eskimo Dogs 0-0-2/1
5 Lowchen 1-4-0/0

9:00AM

12 Boston Terriers 3-5-3/1
13 Lhasa Apsos 5-4-2/2
1 Schipperkes 0-1-0/0

10:00AM

14 Shiba Inu 5-5-2/2
1 Tibetan Terriers 0-1-0/0

10:45AM

16 Mastiffs 5-5-5/0

RING 4 STEVE HAYDEN=42

11:30AM

1 Black Russian Terriers 0-0-1/0
7 Bullmastiffs 4-1-0/2
8 Sealyham Terriers 1-3-1/3
2 Chihuahuas (Long Coat) 1-0-1/0

12:15PM

12 Chinese Crested 2-3-5/1
12 Poodles (Standard) 6-5-0/1

RING 4 – 1:15PM

Mastiff Concurrent Specialty
See Separate Schedule

RING 5 – GEIR FLYCKT-PEDERSEN=170

8:00AM

29 Vizslas 8-9-7/5
3 Spinoni Italiani 1-1-0/1
6 Wirehaired Pointing Griffons 1-3-2/0
2 Dalmatians 1-0-1/0

9:30AM

20 Setters (English) 4-8-7/1
14 Setters (Irish) 5-2-4/3

10:45AM

10 Spaniels (Irish Water) 2-3-3/2
1 Setters (Irish Red and White) 0-0-0/1
4 Poodles (Toy) 0-2-0/2
2 Spaniels (Cocker) ASCOB 0-1-1/0
4 Spaniels (Cocker) Parti 1-2-1/0
14 Spaniels (English Cocker) 4-6-4/0
5 Poodles (Miniature) 1-2-0/2

LUNCH

RING 5 – 12:30PM

Irish Water Spaniel Concurrent Specialty
See Separate Schedule

RING 5 – G FLYCKT-PEDERSEN CONTINUES

1:30PM

8 Danish-Swedish Farmdogs 4-4-0/0
1 Lancashire Heelers 0-1-0/0

2:00PM

9 Spaniels (Clumber) 2-4-2/1
9 Spaniels (English Springer) 2-4-2/1
15 Spaniels (Field) 3-8-2/2
1 Spaniels (Sussex) 0-0-0/1
13 Spaniels (Welsh Springer) 3-6-2/2

RING 6 – ALEXIS LAUREN TRUESDALE=34

8:00AM

34 Jr Showmanship 1nj-2ni-2ns-6oj-12oi-12os

RING 6 – DIANE COLLINGS=64 OF 119

10:30AM

64 Doberman Pinschers 17-31-5/11

RING 6 – 1:00PM

Doberman Pinscher Concurrent Specialty
See Separate Schedule

RING 7 – BETH DOWNEY=71 OF 102

8:00AM

32 Boxers 9-15-5/3
1 German Pinschers 0-1-0/0

9:15AM

19 Bernese Mountain Dogs 8-5-5/1
5 Great Pyrenees 1-1-2/1
14 Leonbergers 4-4-2/4

RING 7 – 10:45AM

Boxer Concurrent Specialty
See Separate Schedule

RING 7 – JOHN P WADE=47 OF 135

12:30PM

22 Polish Lowland Sheepdogs 3-10-4/5
1 Norwegian Buhunds 0-1-0/0
11 Shetland Sheepdogs 4-5-2/0
13 Old English Sheepdogs 2-5-2/4

RING 7 – 2:30PM

Polish Lowland Sheepdog Concurrent Specialty
See Separate Schedule

RING 8 – DIANE COLLINGS=55 OF 119

8:00AM

28 Great Danes 8-15-5/0

9:15AM

27 Samoyeds 8-12-5/2

RING 8 – DELBERT THACKER – 22

10:15AM

1 Kuvaszok 0-0-0/1
8 Rottweilers 2-0-4/2
7 Siberian Huskies 2-3-1/1
6 Akita's 1-4-1/0

RING 8 – 1:30PM

Samoyed Concurrent Specialty
See Separate Schedule

RING 9 – LINDA ROBEY=130

8:00AM

1 Spaniels (American Water) 0-0-1/0
3 Standard Schnauzers 0-1-1/1
15 Corgi Welsh Corgis 4-8-3/0
8 Wirehaired Vizslas 1-3-3/1

9:00AM

21 Setters (Gordon) 4-9-4/4
6 Bearded Collies 2-4-0/0

10:00AM

3 Beaucerons 0-1-2/0
1 Belgian Malinois 0-0-0/1
8 Belgian Sheepdogs 2-2-2/2
4 Belgian Tervuren 1-2-0/1
2 Berger Picards 0-0-1/1
7 Border Collies 3-2-1/1
1 Briards 0-0-1/0

11:00AM

20 Collies (Rough) 8-9-2/1

LUNCH

1:15PM

30 Australian Shepherds 7-14-3/6

RING 9 – PATRICIA V TROTTER=37 OF 175

2:30PM

1 Chihuahuas (Smooth Coat) 0-1-0/0
15 Havanese 4-8-1/2
1 Maltese 0-0-1/0
3 Miniature Pinschers 0-1-2/0
10 Papillons 5-2-2/1
3 Pekingese 2-0-1/0
4 Coton de Tulear 1-1-0/2

INDEX OF BREEDS – SATURDAY

The entry figures are not to be taken as a representation on the part of the Superintendent that all dogs entered will be present on the Show day. If there is a discrepancy between this Index and the Judging Schedule by ring, the Judging Schedule takes precedence.

RING 10 – ROBERT E HUTTON=76 OF 175

10:00AM

12	Dachshunds (Smooth).....	2-5-2/3
13	Dachshunds (Longhaired)	2-5-4/2
7	Dachshunds (Wirehaired)	1-3-1/2
1	Basenjis.....	1-0-0/0

11:15AM

6	Beagles (over 13 in.)	1-1-2/2
4	Beagles (13 in. and under)	1-0-1/2
1	Harriers	0-1-0/0
15	Rhodesian Ridgebacks	3-8-4/0
1	Azawakhs	0-1-0/0

12:15PM

6	Irish Wolfhounds.....	0-5-0/1
1	English Foxhounds	0-0-0/1
9	Borzoi.....	2-5-1/1

RING 10 – PATRICIA V TROTTER-36 OF 175

1:00PM

20	Portuguese Water Dogs	4-9-5/2
6	Retrievers (Chesapeake Bay).....	2-2-1/1
3	Cane Corso.....	0-1-2/0
7	Greater Swiss Mountain Dogs.....	3-1-3/0

RING 10 – ROBERT E HUTTON=52 OF 175

2:30PM

1	Ibizan Hounds	0-0-1/0
4	Norwegian Elkhounds.....	0-3-0/1
1	Otterhounds	0-0-0/1
2	Salukis	0-1-1/0
13	Scottish Deerhounds.....	4-3-2/4
5	Afghan Hounds	1-2-1/1
4	Sloughis.....	2-1-1/0
1	Grand Basset Griffon Vendeens ...	1-0-0/0
7	Whippets	3-3-0/1
14	Basset Hounds	1-9-2/2

RING 11 – BRADLEY JENKINS=112

8:00AM

2	Bulldogs	1-0-0/1
1	Staffordshire Bull Terriers	0-0-0/1
4	Irish Terriers	0-2-1/1
5	Soft Coated Wheaten Terriers.....	0-2-1/2
1	Kerry Blue Terriers	0-0-0/1
14	Fox Terriers (Smooth).....	2-9-2/1

9:00AM

11	Toy Fox Terriers	2-4-4/1
11	Yorkshire Terriers	2-7-1/1
4	Cesky Terriers.....	0-1-2/1
1	Norfolk Terriers.....	0-0-1/0

10:00AM

3	West Highland White Terriers	1-1-1/0
7	Biewer Terriers.....	2-4-1/0
17	Shih Tzu.....	5-9-0/3

11:00AM

2	Silky Terriers.....	1-1-0/0
29	Pugs	6-16-4/3

RING 11 – MARGIE WILSON=8

12:15PM

7	Pug Sweepstakes.....	1(6-9D), 1(12-15D), 3(6-9B), 2(12-15B)
1	Pug Veteran Sweepstakes	1(9-11D)

RING 12 – ROBERT E HUTTON=47 OF 175

8:00AM

47	French Bulldogs	14-24-5/4
----	-----------------------	-----------

RING 12 – MRS. LISA GRASER=73

10:00AM

6	Airedale Terriers.....	1-2-1/2
10	Bedlington Terriers.....	2-6-2/0
10	Cairn Terriers.....	2-6-2/0

11:00AM

5	Border Terriers	1-3-0/1
3	Australian Terriers.....	1-1-1/0
5	Fox Terriers (Wire).....	1-2-1/1
7	Glen of Imaal Terriers.....	4-0-2/1
6	Norwich Terriers	1-4-1/0

12:00PM

2	Lakeland Terriers.....	0-1-1/0
8	Miniature Schnauzers	1-6-0/1
3	Parson Russell Terriers	0-2-1/0
8	Scottish Terriers	3-1-1/3

RING 12 – 1:00PM

French Bulldog Concurrent Specialty
See Separate Schedule

#	BREED	R	TIME
5	AFFENPINSCHERS	1	10:45AM
5	AFGHAN HOUNDS	10	2:30PM
6	AIREDALE TERRIERS	12	10:00AM
6	AKITAS	8	10:15AM
10	ALASKAN MALAMUTES	2	10:45AM
3	AMERICAN ESKIMO DOGS	4	8:00AM
30	AUSTRALIAN SHEPHERDS	9	1:15PM
3	AUSTRALIAN TERRIERS	12	11:00AM
1	AZAWAKHS	10	11:15AM
1	BARBETS	2	9:00AM
1	BASENJIS	10	10:00AM
14	BASSET HOUNDS	10	2:30PM
4	BEAGLES (13 IN. AND UNDER)	10	11:15AM
6	BEAGLES (OVER 13 IN.)	10	11:15AM
6	BEARDED COLLIES	9	9:00AM
3	BEAUCERONS	9	10:00AM
10	BEDLINGTON TERRIERS	12	10:00AM
1	BELGIAN MALINOIS	9	10:00AM
8	BELGIAN SHEEPDOGS	9	10:00AM
4	BELGIAN TERVUREN	9	10:00AM
2	BERGER PICARDS	9	10:00AM
19	BERNESE MOUNTAIN DOGS	7	9:15AM
56	BICHONS FRISES	3	9:00AM
7	BIEWER TERRIERS	11	10:00AM
1	BLACK RUSSIAN TERRIERS	4	11:30AM
7	BORDER COLLIES	9	10:00AM
5	BORDER TERRIERS	12	11:00AM
9	BORZOIS	10	12:15PM
12	BOSTON TERRIERS	4	9:00AM
9	BOUVIERS DES FLANDRES	3	11:15AM
32	BOXERS	7	8:00AM
1	BRIARDS	9	10:00AM
8	BRITTANYS	2	9:00AM
42	BRUSSELS GRIFFONS	1	9:00AM
2	BULLDOGS	11	8:00AM
7	BULLMASTIFFS	4	11:30AM
10	CAIRN TERRIERS	12	10:00AM
3	CANE CORSO	10	1:00PM
15	CARDIGAN WELSH CORGIS	9	8:00AM
22	CAVALIER KING CHARLES SPANIELS	1	10:45AM
4	CESKY TERRIERS	11	9:00AM
2	CHIHUAHUAS (LONG COAT)	4	11:30AM
1	CHIHUAHUAS (SMOOTH COAT)	9	2:30PM
12	CHINESE CRESTED	4	12:15PM
10	CHINESE SHAR-PEI	4	8:00AM
1	CHOW CHOWS	4	8:00AM
20	COLLIES (ROUGH)	9	11:00AM
10	COLLIES (SMOOTH)	3	8:00AM
4	COTON DE TULEAR	9	2:30PM
13	DACHSHUNDS (LONGHAIED)	10	10:00AM
12	DACHSHUNDS (SMOOTH)	10	10:00AM
7	DACHSHUNDS (WIREHAIED)	10	10:00AM
2	DALMATIANS	5	8:00AM
8	DANISH-SWEDISH FARMDOGS	5	1:30PM
64	DOBERMAN PINSCHERS	6	10:30AM
1	ENGLISH FOXHOUNDS	10	12:15PM
14	FOX TERRIERS (SMOOTH)	11	8:00AM
5	FOX TERRIERS (WIRE)	12	11:00AM
47	FRENCH BULLDOGS	12	8:00AM
1	GERMAN PINSCHERS	7	8:00AM
8	GERMAN SHEPHERD DOGS	3	8:00AM
2	GIANT SCHNAUZERS	2	1:00PM
7	GLEN OF IMAAL TERRIERS	12	11:00AM
1	GRAND BASSET GRIFFON VENDEENS	10	2:30PM
28	GREAT DANES	8	8:00AM
5	GREAT PYRENEES	7	9:15AM
7	GREATER SWISS MOUNTAIN DOGS	10	1:00PM
1	HARRIERS	10	11:15AM
15	HAVANESE	9	2:30PM
1	IBIZAN HOUNDS	10	2:30PM
4	IRISH TERRIERS	11	8:00AM
6	IRISH WOLFHOUNDS	10	12:15PM
7	JAPANESE CHIN	1	10:45AM
34	JUNIOR SHOWMANSHIP	6	8:00AM
8	KEESHONDEN	4	8:00AM
1	KERRY BLUE TERRIERS	11	8:00AM
1	KUVASZOK	8	10:15AM
1	LAGOTTI ROMAGNOLI	1	8:00AM
2	LAKELAND TERRIERS	12	12:00PM
1	LANCASHIRE HEELERS	5	1:30PM
14	LEONBERGERS	7	9:15AM
13	LHASA APSOS	4	9:00AM
5	LOWCHEN	4	8:00AM

#	BREED	R	TIME
1	MALTESE	9	2:30PM
16	MASTIFFS	4	10:45AM
2	MINIATURE AMERICAN SHEPHERDS	3	8:00AM
3	MINIATURE PINSCHERS	9	2:30PM
8	MINIATURE SCHNAUZERS	12	12:00PM
4	NEDERLANDSE KOOIKERHONDJES	1	8:00AM
3	NEWFOUNDLAND SWEEPS	2	10:30AM
1	NEWFOUNDLAND VET SWEEPS	2	10:30AM
13	NEWFOUNDLANDS	2	10:45AM
1	NORFOLK TERRIERS	11	9:00AM
1	NORWEGIAN BUHUNDS	7	12:30PM
4	NORWEGIAN ELKHOUNDS	10	2:30PM
6	NORWICH TERRIERS	12	11:00AM
13	OLD ENGLISH SHEEPDOGS	7	12:30PM
1	OTTERHOUNDS	10	2:30PM
10	PAPILLONS	9	2:30PM
3	PARSON RUSSELL TERRIERS	12	12:00PM
3	PEKINGESE	9	2:30PM
3	PEMBROKE WELSH CORGIS	3	8:00AM
3	POINTERS	2	9:00AM
10	POINTERS (GERMAN SHORTHAIRED)	1	8:00AM
2	POINTERS (GERMAN WIREHAIED)	2	9:00AM
22	POLISH LOWLAND SHEEPDOGS	7	12:30PM
11	POMERANIANS	2	1:00PM
5	POODLES (MINIATURE)	5	10:45AM
12	POODLES (STANDARD)	4	12:15PM
4	POODLES (TOY)	5	10:45AM
20	PORTUGUESE WATER DOGS	10	1:00PM
7	PUG SWEEPSTAKES	11	12:15PM
1	PUG VETERAN SWEEPSTAKES	11	12:15PM
29	PUGS	11	11:00AM
1	PULIK	3	8:00AM
6	RETRIEVERS (CHESAPEAKE BAY)	10	1:00PM
11	RETRIEVERS (CURLY-COATED)	2	9:00AM
8	RETRIEVERS (FLAT-COATED)	2	9:00AM
50	RETRIEVERS (GOLDEN)	2	1:00PM
18	RETRIEVERS (LABRADOR)	2	8:00AM
11	RETRIEVERS (NSDT)	1	8:00AM
15	RHODESIAN RIDGEBACKS	10	11:15AM
8	ROTWEILERS	8	10:15AM
8	SAINT BERNARDS	2	10:45AM
2	SALUKIS	10	2:30PM
27	SAMOYEDS	8	9:15AM
1	SCHIPPERKES	4	9:00AM
13	SCOTTISH DEERHOUNDS	10	2:30PM
8	SCOTTISH TERRIERS	12	12:00PM
8	SEALYHAM TERRIERS	4	11:30AM
20	SETTERS (ENGLISH)	5	9:30AM
21	SETTERS (GORDON)	9	9:00AM
1	SETTERS (IRISH RED AND WHITE)	5	10:45AM
14	SETTERS (IRISH)	5	9:30AM
11	SHETLAND SHEEPDOGS	7	12:30PM
14	SHIBA INU	4	10:00AM
17	SHIH TZU	11	10:00AM
7	SIBERIAN HUSKIES	8	10:15AM
2	SILKY TERRIERS	11	11:00AM
4	SLOUGHIS	10	2:30PM
5	SOFT COATED WHEATEN TERRIERS	11	8:00AM
1	SPANIELS (AMERICAN WATER)	9	8:00AM
9	SPANIELS (CLUMBER)	5	2:00PM
2	SPANIELS (COCKER) ASCOB	5	10:45AM
4	SPANIELS (COCKER) PARTI	5	10:45AM
14	SPANIELS (ENGLISH COCKER)	5	10:45AM
9	SPANIELS (ENGLISH SPRINGER)	5	2:00PM
15	SPANIELS (FIELD)	5	2:00PM
10	SPANIELS (IRISH WATER)	5	10:45AM
1	SPANIELS (SUSSEX)	5	2:00PM
13	SPANIELS (WELSH SPRINGER)	5	2:00PM
3	SPINONI ITALIANI	5	8:00AM
1	STAFFORDSHIRE BULL TERRIERS	11	8:00AM
3	STANDARD SCHNAUZERS	9	8:00AM
1	TIBETAN TERRIERS	4	10:00AM
11	TOY FOX TERRIERS	11	9:00AM
29	VIZSLAS	5	8:00AM
7	WEIMARANERS	2	8:00AM
3	WEST HIGHLAND WHITE TERRIERS	11	10:00AM
7	WHIPPETS	10	2:30PM
6	WIREHAIED POINTING GRIFFONS	5	8:00AM
8	WIREHAIED VIZSLAS	9	8:00AM
11	YORKSHIRE TERRIERS	11	9:00AM

PROGRAM OF JUDGING - SUNDAY, NOVEMBER 21, 2021

There are 1392 dogs entered this day with a total entry of 1421 – ENTRIES: Conformation 1382, Junior Showmanship 29, 10 Sweepstakes

For your convenience, the following division of sexes has been carefully tabulated; however, neither the Club nor the Superintendent assumes responsibility for absolute accuracy. The number before each Breed (Variety) indicates the number of dogs entered in that Breed (Variety). The numbers following each Breed (Variety) indicate the number of Regular Class Dogs, Regular Class Bitches, Non-Regular Class Dogs or Bitches, and Best of Breed (Variety) (Dogs/Bitches). **OFFICIAL NOTICE: SUBSTITUTION OF JUDGES** – Reference Chapter 7, Section 8 of AKC Rules and Chapter 1, Section 26 of Obedience Regulations: Owner has the right to withdraw his entry and have his entry fee refunded provided notification of his withdrawal is received no later than one half-hour prior to the start of any regular judging. FROM PATRICIA TROTTER TO STEVE HAYDEN – Great Danes, Leonbergers. FROM ROBERT HUTTON TO STEVE HAYDEN – Toy Poodles, Shih Tzus. FROM PATRICIA TROTTER TO LLOYD GRASER – Vizslas. FROM LLOYD GRASER TO BRADLEY JENKINS – Coton de Tulear, Danish-Swedish Farmdogs.

BEST IN SHOW & VARIETY GROUPS

SUNDAY GROUP JUDGING WILL BEGIN NO EARLIER THAN 1:30PM IN RINGS 1 & 2.

Group Order will be announced at 1:00PM.

TENTATIVE GROUP ORDER

Terrier Group	Geir Flyckt-Pedersen
Herding Group	Lisa Graser
Working Group	Patricia Sosa
Non-Sporting Group	Bradley Jenkins
Sporting Group	Linda Robey
Hound Group	Patricia Trotter
Toy Group	Robert Hutton
Best In Show	John Wade

RING 1 – JOHN P WADE=96

8:00AM

5 Irish Wolfhounds.....	0-3-0/2
1 Otterhounds	0-0-0/1
13 Scottish Deerhounds.....	4-3-2/4
1 Harriers	0-1-0/0
7 Borzois	2-4-1/0

9:00AM

1 English Foxhounds	0-0-0/1
8 Brittans	1-2-3/2
1 Treeing Walker Coonhounds.....	0-0-1/0
1 Grand Basset Griffon Vendeens...	1-0-0/0
2 Spaniels (Cocker) ASCOB.....	0-1-1/0
4 Spaniels (Cocker) Parti	1-2-1/0

9:45AM

52 French Bulldogs	16-26-5/5
--------------------------	-----------

RING 1 – ROBERT HUTTON=34 OF 175

11:45AM

34 Brussels Griffons	6-16-7/5
----------------------------	----------

RING 2 – BARBARA C SCHERER=102

8:00AM

14 Basset Hounds	1-9-2/2
11 Whippets	5-5-0/1

9:00AM

14 Dachshunds (Smooth).....	3-6-2/3
11 Dachshunds (Longhaired)	1-6-4/0

10:00AM

5 Dachshunds (Wirehaired)	1-1-1/2
2 Basenjis	1-1-0/0
4 Beagles (13")	1-0-1/2
7 Beagles (over 15")	1-2-2/2
2 Portuguese Podengo Pequenos...	1-0-1/0
1 Ibizan Hounds	0-0-1/0
5 Norwegian Elkhounds	0-4-0/1

11:00AM

16 Rhodesian Ridgebacks	3-8-5/0
2 Salukis	0-1-1/0
4 Sloughis	2-1-1/0
4 Afghan Hounds	1-1-1/1

RING 3 – BRADLEY JENKINS=138

8:00AM

12 Boston Terriers	3-5-3/1
5 Lowchen	1-4-0/0

8:45AM

3 American Eskimo Dogs	0-0-2/1
12 Lhasa Apsos	5-4-2/1
1 Schipperkes	0-1-0/0

9:30AM

1 Tibetan Terriers	0-1-0/0
6 Poodles (Miniature)	2-2-0/2
13 Shiba Inu	5-4-2/2
8 Chinese Shar-Pei	1-3-2/2
1 Chow Chows	1-0-0/0
8 Keeshonden	3-2-3/0

11:00AM

11 Poodles (Standard)	6-4-0/1
-----------------------------	---------

LUNCH

12:30PM

45 Bichons Frises	10-16-10/9
-------------------------	------------

2:30PM

4 Coton de Tulear	1-1-0/2
8 Danish-Swedish Farmdogs	4-4-0/0

RING 4 – PATRICIA V TROTTER=174

8:00AM

43 Doberman Pinschers.....	11-20-3/9
----------------------------	-----------

9:45AM

1 Setters (Irish Red and White)	0-0-0/1
12 Setters (Irish).....	4-2-3/3
9 Spaniels (Irish Water).....	2-3-3/1
3 Spinoni Italiani	1-1-0/1
7 Weimaraners	0-4-2/1

11:00AM

6 Wirehaired Pointing Griffons	1-3-2/0
8 Wirehaired Vizslas	1-3-3/1
3 Giant Schnauzers	0-2-0/0

LUNCH

12:30PM

21 Setters (Gordon)	3-9-4/5
15 Spaniels (English Cocker)	4-7-4/0
1 Spaniels (American Water)	0-0-1/0
1 Spaniels (Sussex).....	0-0-0/1

2:00PM

9 Spaniels (Clumber).....	2-4-2/1
9 Spaniels (English Springer).....	2-4-2/1
14 Spaniels (Field).....	2-8-2/2
13 Spaniels (Welsh Springer)	3-6-2/2

RING 5 – LINDA ROBEY=165

8:00AM

30 Boxers	8-15-4/3
3 Pointers.....	0-0-1/2

9:15AM

1 Barbets.....	0-0-1/0
9 Pointers (German Shorthaired)....	1-4-4/0
2 Pointers (German Wirehaired)....	0-1-1/0
5 Retrievers (Chesapeake Bay).....	2-1-1/1

10:00AM

19 Retrievers (Labrador)	7-10-1/1
11 Retrievers (Curly-Coated).....	4-2-3/2
3 Retrievers (Flat-Coated)	1-1-1/0

11:15AM

17 Setters (English)	3-7-6/1
----------------------------	---------

LUNCH

12:45PM

49 Retrievers (Golden).....	16-23-6/4
-----------------------------	-----------

2:45PM

11 Retrievers (NSDT).....	3-4-2/2
4 Nederlandse Kooikerhondjes.....	2-0-2/0
1 Lagotti Romagnoli	0-1-0/0

RING 6 – LISA GRASER=114

8:00AM

8 German Shepherd Dogs.....	3-4-0/1
8 Collies (Smooth).....	0-6-2/0

3 Beaucerons	0-1-2/0
1 Belgian Malinois	0-0-0/1
7 Border Collies.....	3-2-1/1

9:00AM

3 Bearded Collies	1-2-0/0
8 Belgian Sheepdogs.....	1-3-2/2
5 Belgian Tervuren	1-2-1/1
2 Berger Picards.....	0-0-1/1

9:45AM

1 Briards.....	0-0-1/0
20 Collies (Rough)	8-9-2/1
13 Old English Sheepdogs.....	2-5-2/4

11:00AM

1 Norwegian Buhunds	0-1-0/0
2 Miniature American Shepherds...	0-0-1/1
3 Pembroke Welsh Corgis	2-1-0/0
1 Pulik	0-1-0/0
12 Shetland Sheepdogs	4-6-2/0
16 Cardigan Welsh Corgis	4-8-4/0

RING 7 – LLOYD GRASER JR. =174

8:00AM

30 Australian Shepherds.....	7-14-3/6
2 Dalmatians	1-0-1/0
8 Rottweilers	2-0-4/2

9:30AM

28 Samoyeds.....	10-11-5/3
------------------	-----------

10:30AM

29 Vizslas	9-8-7/5
6 Saint Bernards.....	2-1-2/1
6 Bouviers des Flandres	3-2-1/0

LUNCH

12:45PM

12 Newfoundlands.....	5-3-2/2
7 Siberian Huskies.....	2-3-1/1

1:30PM

21 Portuguese Water Dogs	4-10-5/2
3 Standard Schnauzers.....	0-1-1/1
3 Bulldogs	2-0-0/1

2:30PM

18 Polish Lowland Sheepdogs.....	3-7-3/5
----------------------------------	---------

RING 7 – RONDA BERMKE=3

12:30PM

2 Newfoundland Sweeps..1(9-12D), 1(6-9B)	
1 Newfoundland Vet Sweeps.....1(8-9B)	

RING 8 – STEVE HAYDEN=65

9:30AM

27 Great Danes	8-15-4/0
----------------------	----------

10:30AM

14 Leonbergers	4-4-2/4
20 Shih Tzu.....	6-11-0/3
4 Poodles (Toy).....	0-2-0/2

RING 8 – ED FOJTIK=23 OF 30

12:15PM

6 Greater Swiss Mountain Dogs.....	3-1-2/0
17 Mastiffs	4-7-5/0

RING 9 – MARY LEE=29

8:00AM

29 Jr Showmanship.. 2nj-1ni-1ns-6oj-9oi-10os	
--	--

RING 9 – PATRICIA A SOSA=51

9:30AM

6 Akitas	1-4-1/0
9 Alaskan Malamutes.....	1-3-2/3
7 Bullmastiffs	4-1-0/2

INDEX OF BREEDS – SUNDAY

The entry figures are not to be taken as a representation on the part of the Superintendent that all dogs entered will be present on the Show day. If there is a discrepancy between this Index and the Judging Schedule by ring, the Judging Schedule takes precedence.

3	Cane Corso	0-1-2/0
10:30AM		
19	Bernese Mountain Dogs	8-5-5/1
1	Black Russian Terriers	0-0-1/0
5	Great Pyrenees	1-1-2/1
1	Kuvaszok	0-0-0/1

RING 10 – GEIR FLYCKT-PEDERSEN=105

8:00AM

1	Staffordshire Bull Terriers	0-0-0/1
3	Miniature Bull Terriers	0-1-1/1
4	Irish Terriers	0-2-1/1
5	Soft Coated Wheaten Terriers.....	0-2-1/2
1	Kerry Blue Terriers	0-0-0/1
5	Airedale Terriers.....	0-2-1/2
4	Australian Terriers.....	1-1-2/0
3	Cesky Terriers.....	0-1-1/1

9:00AM

10	Bedlington Terriers.....	2-6-2/0
5	Border Terriers	1-3-0/1
10	Cairn Terriers.....	2-6-2/0
2	Lakeland Terriers.....	0-1-1/0

10:00AM

14	Fox Terriers (Smooth).....	2-9-2/1
5	Fox Terriers (Wire)	1-2-1/1
7	Glen of Imaal Terriers.....	4-0-2/1

11:00AM

8	Miniature Schnauzers	1-6-0/1
1	Norfolk Terriers	0-0-1/0
6	Norwich Terriers	1-4-1/0
7	Scottish Terriers	2-1-1/3
1	Sealyham Terriers	0-0-0/1
3	West Highland White Terriers	1-1-1/0

RING 11 – NOT USED

RING 12 – ED FOJTIK=7 OF 30

8:00AM

6	Pug Sweeps.....	1(6-9D), 1(12-15D), 2(6-9B), 2(12-15B)
1	Pug Vet Sweeps.....	1(9-11D)

RING 12 – ROBERT E HUTTON=81 OF 175

8:30AM

27	Pugs	6-14-4/3
----	------------	----------

9:30AM

5	Affenpinschers	1-4-0/0
8	Biewer Terriers.....	2-5-1/0
2	Silky Terriers.....	1-1-0/0
11	Toy Fox Terriers	2-4-4/1
1	Chihuahuas (Long Coat).....	1-0-0/0

10:30AM

1	Chihuahuas (Smooth Coat)	0-1-0/0
22	Cavalier King Charles Spaniels	8-6-7/1
3	Miniature Pinschers	0-1-2/0
1	Pekingese.....	0-0-1/0

Moves to Ring 1, 11:45-1:00

RING 12 – ROBERT E HUTTON=60 OF 175

1:45PM

8	Chinese Crested	0-3-4/1
11	Pomeranians	7-2-2/0
7	Japanese Chin	2-2-2/1
1	Maltese	0-0-1/0

2:45PM

13	Havanese	4-8-0/1
9	Papillons.....	5-1-2/1
11	Yorkshire Terriers	2-7-1/1

#	BREED	R	TIME
5	AFFENPINSCHERS	12	9:30AM
4	AFGHAN HOUNDS	2	11:00AM
5	AIREDALE TERRIERS	10	8:00AM
6	AKITAS	9	9:30AM
9	ALASKAN MALAMUTES	9	9:30AM
3	AMERICAN ESKIMO DOGS	3	8:45AM
30	AUSTRALIAN SHEPHERDS	7	8:00AM
4	AUSTRALIAN TERRIERS	10	8:00AM
1	BARBETS	5	9:15AM
2	BASENJIS	2	10:00AM
14	BASSET HOUNDS	2	8:00AM
4	BEAGLES (13 IN. AND UNDER)	2	10:00AM
7	BEAGLES (OVER 13 IN.)	2	10:00AM
3	BEARDED COLLIES	6	9:00AM
3	BEAUCERONS	6	8:00AM
10	BEDLINGTON TERRIERS	10	9:00AM
1	BELGIAN MALINOIS	6	8:00AM
8	BELGIAN SHEEPDOGS	6	9:00AM
5	BELGIAN TERVUREN	6	9:00AM
2	BERGER PICARDS	6	9:00AM
19	BERNESE MOUNTAIN DOGS	9	10:30AM
45	BICHONS FRISES	3	12:30PM
8	BIEWER TERRIERS	12	9:30AM
1	BLACK RUSSIAN TERRIERS	9	10:30AM
7	BORDER COLLIES	6	8:00AM
5	BORDER TERRIERS	10	9:00AM
7	BORZOIS	1	8:00AM
12	BOSTON TERRIERS	3	8:00AM
6	BOUVIERS DES FLANDRES	7	10:30AM
30	BOXERS	5	8:00AM
1	BRIARDS	6	9:45AM
8	BRITTANYS	1	9:00AM
34	BRUSSELS GRIFFONS	1	11:45AM
3	BULLDOGS	7	1:30PM
7	BULLMASTIFFS	9	9:30AM
10	CAIRN TERRIERS	10	9:00AM
3	CANE CORSO	9	9:30AM
16	CARDIGAN WELSH CORGIS	6	11:00AM
22	CAVALIER KING CHARLES SPANIELS	12	10:30AM
3	CESKY TERRIERS	10	8:00AM
1	CHIHUAHUAS (LONG COAT)	12	9:30AM
1	CHIHUAHUAS (SMOOTH COAT)	12	10:30AM
8	CHINESE CRESTED	12	1:45PM
8	CHINESE SHAR-PEI	3	9:30AM
1	CHOW CHOWS	3	9:30AM
20	COLLIES (ROUGH)	6	9:45AM
8	COLLIES (SMOOTH)	6	8:00AM
4	COTON DE TULEAR	7	2:30PM
11	DACHSHUNDS (LONGHAired)	2	9:00AM
14	DACHSHUNDS (SMOOTH)	2	9:00AM
5	DACHSHUNDS (WIREHAired)	2	10:00AM
2	DALMATIANS	7	8:00AM
8	DANISH-SWEDISH FARMDOGS	7	2:30PM
43	DOBERMAN PINSCHERS	4	8:00AM
1	ENGLISH FOXHOUNDS	1	9:00AM
14	FOX TERRIERS (SMOOTH)	10	10:00AM
5	FOX TERRIERS (WIRE)	10	10:00AM
52	FRENCH BULLDOGS	1	9:45AM
8	GERMAN SHEPHERD DOGS	6	8:00AM
2	GIANT SCHNAUZERS	4	11:00AM
7	GLEN OF IMAAL TERRIERS	10	10:00AM
1	GRAND BASSET GRIFF VENDEENS	1	9:00AM
27	GREAT DANES	8	9:30AM
5	GREAT PYRENEES	9	10:30AM
6	GREATER SWISS MOUNTAIN DOGS	8	12:15PM
1	HARRIERS	1	8:00AM
13	HAVANESE	12	2:45PM
1	IBIZAN HOUNDS	2	10:00AM
4	IRISH TERRIERS	10	8:00AM
5	IRISH WOLFHOUSES	1	8:00AM
7	JAPANESE CHIN	12	1:45PM
29	JUNIOR SHOWMANSHIP	9	8:00AM
8	KEESHONDEN	3	9:30AM
1	KERRY BLUE TERRIERS	10	8:00AM
1	KUVASZOK	9	10:30AM
1	LAGOTTI ROMAGNOLI	5	2:45PM
2	LAKELAND TERRIERS	10	9:00AM
14	LEONBERGERS	8	10:30AM
12	LHASA APSOS	3	8:45AM
5	LOWCHEN	3	8:00AM
1	MALTESE	12	1:45PM
17	MASTIFFS	8	12:15PM
2	MINIATURE AMERICAN SHEPHERDS	6	11:00AM

#	BREED	R	TIME
3	MINIATURE BULL TERRIERS	10	8:00AM
3	MINIATURE PINSCHERS	12	10:30AM
8	MINIATURE SCHNAUZERS	10	11:00AM
4	NEDERLANDSE KOOIKERHONDJES	5	2:45PM
2	NEWFOUNDLAND SWEEPS	7	12:30PM
1	NEWFOUNDLAND VET SWEEPS	7	12:30PM
12	NEWFOUNDLANDS	7	12:45PM
1	NORFOLK TERRIERS	10	11:00AM
1	NORWEGIAN BUHUNDS	6	11:00AM
5	NORWEGIAN ELKHOUNDS	2	10:00AM
6	NORWICH TERRIERS	10	11:00AM
13	OLD ENGLISH SHEEPDOGS	6	9:45AM
1	OTTERHOUNDS	1	8:00AM
9	PAPILLONS	12	2:45PM
1	PEKINGESE	12	10:30AM
3	PEMBROKE WELSH CORGIS	6	11:00AM
3	POINTERS	5	8:00AM
9	POINTERS (GERSHORTHAIRED)	5	9:15AM
2	POINTERS (GER WIREHAired)	5	9:15AM
18	POLISH LOWLAND SHEEPDOGS	7	2:30PM
11	POMERANIANS	12	1:45PM
6	POODLES (MINIATURE)	3	9:30AM
11	POODLES (STANDARD)	3	11:00AM
4	POODLES (TOY)	8	10:30AM
2	PORTUGUESE PODENGO PEQ	2	10:00AM
21	PORTUGUESE WATER DOGS	7	1:30PM
6	PUG SWEEPS	12	8:00AM
1	PUG VET SWEEPS	12	8:00AM
27	PUGS	12	8:30AM
1	PULIK	6	11:00AM
5	RETRIEVERS (CHESAPEAKE BAY)	5	9:15AM
11	RETRIEVERS (CURLY-COATED)	5	10:00AM
3	RETRIEVERS (FLAT-COATED)	5	10:00AM
49	RETRIEVERS (GOLDEN)	5	12:45PM
19	RETRIEVERS (LABRADOR)	5	10:00AM
11	RETRIEVERS (NSDT)	5	2:45PM
16	RHODESIAN RIDGEBACKS	2	11:00AM
8	ROTTWEILERS	7	9:00AM
6	SAINT BERNARDS	7	10:30AM
2	SALUKIS	2	11:00AM
28	SAMOYEDS	7	10:30AM
1	SCHIPPERKES	3	8:45AM
13	SCOTTISH DEERHOUNDS	1	8:00AM
7	SCOTTISH TERRIERS	10	11:00AM
1	SEALYHAM TERRIERS	10	11:00AM
17	SETTERS (ENGLISH)	5	11:15AM
21	SETTERS (GORDON)	4	12:30PM
1	SETTERS (IRISH RED AND WHITE)	4	9:45AM
12	SETTERS (IRISH)	4	9:45AM
12	SHEPHERD SHEEPDOGS	6	11:00AM
13	SHIBA INU	3	9:30AM
20	SHIH TZU	8	10:30AM
7	SIBERIAN HUSKIES	7	12:45PM
2	SILKY TERRIERS	12	9:30AM
4	SLOUGHIS	2	11:00AM
5	SOFT COATED WHEATEN TERRIERS	10	8:00AM
1	SPANIELS (AMERICAN WATER)	4	12:30PM
9	SPANIELS (CLUMBER)	4	2:00PM
2	SPANIELS (COCKER) ASCOB	1	9:00AM
4	SPANIELS (COCKER) PARTI	1	9:00AM
15	SPANIELS (ENGLISH COCKER)	4	12:30PM
9	SPANIELS (ENGLISH SPRINGER)	4	2:00PM
14	SPANIELS (FIELD)	4	2:00PM
9	SPANIELS (IRISH WATER)	4	9:45AM
1	SPANIELS (SUSSEX)	4	12:30PM
13	SPANIELS (WELSH SPRINGER)	4	2:00PM
3	SPINONI ITALIANI	4	9:45AM
1	STAFFORDSHIRE BULL TERRIERS	10	8:00AM
3	STANDARD SCHNAUZERS	7	1:30PM
1	TIBETAN TERRIERS	3	9:30AM
11	TOY FOX TERRIERS	12	9:30AM
1	TREEING WALKER COONHOUNDS	1	9:00AM
29	VIZSLAS	7	10:30AM
7	WEIMARANERS	4	9:45AM
3	WEST HIGHLAND WHITE TERRIERS	10	11:00AM
11	WHIPPETS	2	8:00AM
6	WIREHAired POINTING GRIFFONS	4	11:00AM
8	WIREHAired VIZSLAS	4	11:00AM
11	YORKSHIRE TERRIERS	12	2:45PM