

ENTRIES OPEN WEDNESDAY, MARCH 24, 12:00 NOON PDT

PREMIUM LIST AMERICAN KENNEL CLUB RULES & REGULATIONS GOVERN THESE EVENTS. Entries close at the BaRay Event's Office 12:00PM PDT, Wednesday, May 5, 2021, or when any limit is reached, after which time entries cannot be accepted, cancelled or substituted EXCEPT as provided for in Ch. 11, Sec. 6 of the Dog Show Rules. **EVENT NUMBER: #2021653501.**



8th Independent Specialty Show
with NOHS, Junior Showmanship & Sweepstakes
Rocky Mountain Mastiff Fanciers

(AKC Licensed – Outdoors, Unbenched)

SATURDAY, MAY 22, 2021

Entry Limit 100.

This Specialty is concurrent with Mt. Ogden Kennel Club All-Breed Show.

Cache County Fairgrounds – 450 South 500 West, Logan, UT

An inherent risk of exposure to COVID-19 exists in any public place where people are present. COVID-19 is an extremely contagious disease that can lead to severe illness and death. By attending these events, you voluntarily assume all risks related to exposure to COVID-19.



**American
Kennel Club®**

CERTIFICATION Permission has been granted by the American Kennel Club for the holding of this event under the American Kennel Club rules & regulations.

GINA M. DINARDO, Executive Secretary



BaRay Event Services, Inc.

A.K.C. ANNUALLY LICENSED SUPERINTENDENTS
MEMBER: DOG SHOW SUPERINTENDENTS ASSOCIATION

•SHEILA RAYMOND•BECKY SUMNER•JERRY SUMNER•CHUCK ST. JOHN
•DALE NEUKOM, JR•JEFFERY INMAN•GLENN WHITTEN•KRISTIN MARICICH
•ROBERTA MARTIN•GUY MICHELSON•SHARON SAMSON

PO BOX 508, BURLINGTON, WA 98233
PHONE: 360-755-7086 • FAX: 360-755-2248

HAND-DELIVERED, EXPRESS or PRIORITY, FEDEX or UPS:
113 E. FAIRHAVEN AVE., BURLINGTON, WA 98233 (do NOT require signature)
E-MAIL: dogsshows@barayevents.com • WEB SITE: BaRayEvents.com

OFFICE HOURS
10AM-5PM
PACIFIC TIME
MON.-FRI.

Like us on
FACEBOOK



SHOW HOURS - 8:00AM to 7:00PM - MDT

Dogs are not required to be at the show until scheduled time of judging.

All dogs not needed for further judging will be excused.

**The Show Site & RV Parking will be available to exhibitors after 2:00PM Tuesday.
On Wednesday, parking will be available after 10:00AM.**

OFFICERS

Shannon Van DurenPresident Mary Dymond Vice President
Shannon Van Duren.....Treasurer Becky GalmishSecretary
52205 E 48th Ave, Strasburg, CO 80136
rjgalmish@gmail.com

BOARD OF DIRECTORS

Rebecca Bennett, Maureen McGuire, Kim Wilson

SHOW COMMITTEE

Shannon Van Duren – Show Chair

16615 Mystic Ln, Strasburg, CO 80136 • 303-883-5058

Bench Committee: Members and all officers and board members of the Club

JUDGES

Betty Nelson Pollock [39858] 12384 FM 114, Avery, TX 75554
All Conformation Classes & Junior Showmanship
Kainoa Clark..... 160 South Westwood Drive, Orem, UT 84097
All Sweepstakes Classes

SHOW VETERINARIAN (ON-CALL)

Bridgeland Cache Animal Hospital

95 W 900 N, Logan, UT 84321 • 435-752-2151

DIRECTIONS TO CLINIC: Out of the Fairgrounds go North 1/2 block to 400 South, turn right and go East on 400 S (.7 mi). Turn left onto Main Street (US89/US91). Continue on Main to 900 N (1.7 mi). Turn left onto 900 North. Go 1 block to 95 W. The clinic is on the North side of the street.

OFFICIAL PHOTOGRAPHER

Bill Kohler & Associates, Inc. – Bill and Jan Kohler

2202W Edgemont Ave, Phoenix, AZ 85009-1941

602-271-9953 • 602-340-1263 fax • billkohlerphoto@msn.com

ENTRY FEES

Highest Priced Class considered the FIRST ENTRY

Separate Fee for each dog – Includes AKC Fees where applicable

When a dog is entered in more than one class, highest priced class is considered the first entry.

First Entry of Each Dog, unless otherwise specified \$28.00
Each Additional Entry of Same Dog, unless otherwise specified..... \$23.00
Puppy Classes(6-9 & 9-12 mos.), Bred by Exhibitor, and Veterans Classes..... \$23.00
Junior Showmanship Only or as Additional Class No Fee
Sweepstakes (must be entered in a regular class) \$17.00
Veteran Sweepstakes (need not be entered in another class) \$17.00

MAIL ENTRIES WITH FEES to BaRay Event Services, PO Box 508, Burlington, WA 98233

See Entry Submission Guidelines, Page 8

PARKING INFORMATION & RESERVED GROOMING

SEE MT. OGDEN KENNEL CLUB PREMIUM LIST
For questions contact Pat Jenkins – 435-770-0334 – pmj16@msn.com

COVID 19 GUIDELINES

SEE MT. OGDEN KENNEL CLUB PREMIUM LIST

BRING YOUR OWN

Face mask/covering • Hand sanitizer • Disposable Gloves if desired
You are responsible for your own safety

CLASSIFICATION – MASTIFFS ONLY

Regular Classes

PUPPY DOGS (6 mos. & under 9 mos.)	PUPPY BITCHES (6 mos. & under 9 mos.)
PUPPY DOGS (9 mos. & under 12 mos.)	PUPPY BITCHES (9 mos. & under 12 mos.)
DOGS (12 mos. & under 15 mos.)	BITCHES (12 mos. & under 15 mos.)
DOGS (15 mos. & under 18 mos.)	BITCHES (15 mos. & under 18 mos.)

NOVICE CLASSES NOT OFFERED

AMATEUR-OWNER-HANDLER DOGS	AMATEUR-OWNER-HANDLER BITCHES
BRED BY EXHIBITOR DOGS	BRED BY EXHIBITOR BITCHES
AMERICAN BRED DOGS	AMERICAN BRED BITCHES
OPEN DOGS, APRICOT	OPEN BITCHES, APRICOT
OPEN DOGS, BRINDLE	OPEN BITCHES, BRINDLE
OPEN DOGS, FAWN	OPEN BITCHES, FAWN
WINNERS DOG	WINNERS BITCH

Non-Regular Classes Involving Single Dog Entries

VETERAN DOGS, 6 yrs. & under 8 yrs.	VETERAN BITCHES, 6 yrs. & under 8 yrs.
VETERAN DOGS, 8 yrs. & under 10 yrs.	VETERAN BITCHES, 8 yrs. & under 10 yrs.
VETERAN DOGS, 10 yrs. & older	VETERAN BITCHES, 10 yrs. & older

A class for Dogs and a class for Bitches in each of the age groups listed above. Dogs/bitches entered in Veterans need not be intact. Winners, if otherwise undefeated, are eligible for Best of Breed competition.

BEST OF BREED (VARIETY) COMPETITION – The following categories of dogs may be entered and shown in Best of Breed (Variety) Competition: Dogs that are Champions of Record and dogs which according to their owners' records, have completed the requirements for a championship, but whose championships are unconfirmed. The showing of unconfirmed champions in Best of Breed (Variety) Competition is limited to a period of 90 days from the date of the show where the dog completed the requirements for a championship. Selects, if applicable, will be chosen following Best of Breed.

Best Puppy in Regular Puppy Classes - For winners of the Puppy Dog & Puppy Bitch 6-9 Months and 9-12 Months classes only.

Best Bred By Exhibitor - For winners of the Bred By Exhibitor Dog & Bred By Exhibitor Bitch classes only.

Best Veteran - Chosen from winners of the 6 Veteran classes

Award of Merit - At the judge's discretion, an Award of Merit may be given to those quality animals the judge feels are worthy of final consideration for Best of Breed. Award of Merit winners will be selected after BOB, BOS & Selects are awarded. The number of awards is determined by the number of dogs entered in the Best of Breed class: 1-5=1; 6-10=2; 11-15=3; 16-20=4; 21 or more = 5.

"Dogs found in an unsafe environment, distress or harm's way (for example: left unattended on a grooming table in a noose not attached to a safety release clip; left in a vehicle without proper ventilation) will be removed to safety. Exposing a dog to an unsafe environment, distress or harm's way is considered mistreatment."

No dogs that are disqualified for aggression will be allowed to enter these Shows, nor be allowed to be on the grounds. In addition, no aggression reinstatement procedures will be performed at these Shows.

RIBBON/ROSETTE PRIZES – EACH DAY

The Ribbon Prizes in all Regular Classes will be as follows:

First Prize	Blue Ribbon
Second Prize	Red Ribbon
Third Prize.....	Yellow Ribbon
Fourth Prize	White Ribbon
Best of Breed	Purple & Gold Rosette
Best of Opposite Sex to Best of Breed	Red & White Rosette
Best of Winners	Blue & White Rosette
Select Dog & Select Bitch	Light Blue & White Rosette
Awards of Merit.....	Dark Green & White Rosette
NOHS Best of Breed.....	Maroon Rosette
Winners Dog & Winners Bitch	Purple Rosette
Reserve Winners Dog & Reserve Winners Bitch.....	Purple & White Rosette
Best Puppy, Best Bred by Exhibitor, Best Veteran.....	Dark Green Rosette
Best Junior Handler	Rose & Green Rosette
Reserve Best Junior Handler.....	Rose & Gray Rosette
Best in Sweepstakes & Best in Veteran Sweepstakes	Pink & Green Rosette
Best of Opposite Sex in Sweepstakes & Veteran Sweepstakes.....	Lavender Rosette

The Ribbon Prizes in all Non-Regular Classes will be as follows:

First Prize.....	Pink Ribbon
Second Prize.....	Brown Ribbon
Third Prize	Light Green Ribbon
Fourth Prize	Gray Ribbon
Best of Breed	Purple & Gold Rosette
Best of Opposite Sex to Best of Breed	Red & White Rosette
Best of Winners	Blue & White Rosette
Select Dog & Select Bitch	Light Blue & White Rosette
Awards of Merit.....	Dark Green & White Rosette
NOHS Best of Breed.....	Maroon Rosette
Winners Dog & Winners Bitch	Purple Rosette
Reserve Winners Dog & Reserve Winners Bitch.....	Purple & White Rosette
Best Puppy, Best Bred by Exhibitor, Best Veteran.....	Dark Green Rosette
Best Junior Handler	Rose & Green Rosette
Reserve Best Junior Handler.....	Rose & Gray Rosette
Best in Sweepstakes & Best in Veteran Sweepstakes	Pink & Green Rosette
Best of Opposite Sex in Sweepstakes & Veteran Sweepstakes.....	Lavender Rosette

JUNIOR SHOWMANSHIP COMPETITION

NOVICE CLASS: This shall be for boys and girls who are at least 9 years old and under 18 years old on the day of the show and who at the time entries close have not won three (3) first place awards, with competition present, in a Novice Class. A first place in Novice without competition leading to a Best Junior award with competition would count as one win towards moving to Open at a licensed or member show.

OPEN CLASS: For boys and girls who are at least 9 years old and under 18 years old on the day of the show, and who have won three first place awards in a Novice Class or if a win in Novice leads to a Best Junior with competition present it will count as one win towards moving to Open in a licensed or member show.

MASTER CLASS: This class will be for boys and girls who are at least 9 years old and under 18 years old on the day of the show, and who have 10 Best Junior wins with competition. The calendar for this class will be consistent with the eligibility dates for the AKC National Championship. All Juniors meeting the criteria for this class are required to enter the Master Class and may change their entry the day of the show if entries have already closed. Once the eligibility time frame for that year has passed all participants return to the Open Class to compete for the following year.

After the judge has awarded the Best Junior Handler, the second place winner from the class that the Junior was awarded Best Junior Handler is to return to the ring to compete for Reserve Best Junior Handler.

NOTICE: Junior Handlers must include their AKC JUNIOR HANDLER NUMBER on each entry. You may obtain your junior identification number by calling the AKC, Judges Education Department, 919-233-9767. BE SURE ALL INFORMATION for Junior Showmanship Classes is entered on front and back of entry form.

NOTE: SUBSTITUTION OF DOG IN JUNIOR SHOWMANSHIP AT THE SHOW(S): There will be an Administration Fee of \$5.00 charged for any substitution of dog in Junior Showmanship at each show. In addition, if the dog originally entered in Jr. Showmanship was an additional entry, and the dog being substituted is not otherwise entered in the show, the Junior Showmanship Only fee applies.

ATTENTION EXHIBITORS

- Please clean up after your dogs on the show grounds and at your motel site. We want to retain these facilities for future events.
- Remember, all complaints regarding conduct prejudicial to the sport will be dealt with in accordance with AKC rules, by the Show Committee.
- **SMOKING will not be permitted inside show buildings - state law, or around show rings. This will be enforced.**
- The Redwood Empire Mastiff Club does not agree to arbitrate claims as set forth on the Official AKC entry form for these events.

SWEEPSTAKES & VETERAN SWEEPSTAKES

SWEEPSTAKES REQUIREMENTS & CLASSIFICATION

- The RMMF Sweepstakes is open to Mastiffs who, on the day of the show, will be 6 months of age and under 18 months of age. Champions of Record and dogs with Championship Points are allowed.
- Each dog must be entered in a regular or non-regular class at this show.
- All AKC rules applying to the regular classes also apply to the Sweepstakes classes.
- The first place winners of all classes will compete for Best in Sweepstakes and Best of Opposite Sex in Sweepstakes. There is no Junior/Senior division.
- Cash prizes will be awarded to the person in the ring showing the dog. Claims for prize money must be made in the ring before judging is over. The Superintendent and REMC will disclaim any liability for cash prizes after the judging of Sweepstakes is completed.

SWEEPSTAKES CLASSIFICATION

PUPPY DOGS (6 mos. & under 9 mos.)	PUPPY BITCHES (6 mos. & under 9 mos.)
PUPPY DOGS (9 mos. & under 12 mos.)	PUPPY BITCHES (9 mos. & under 12 mos.)
DOGS (12 mos. & under 15 mos.)	BITCHES (12 mos. & under 15 mos.)
DOGS (15 mos. & under 18 mos.)	BITCHES (15 mos. & under 18 mos.)

VETERAN SWEEPSTAKES RULES

The same above rules apply to the Veteran Sweepstakes with the following exceptions:

- The Veteran Sweepstakes is open to all Mastiffs who, on the date of the show, are 6 years and older.
- Dogs entered in Veteran Sweepstakes do not need to be entered in a regular or non-regular class and may be spayed or neutered.
- All first place winners will compete for Best in Veteran Sweepstakes and Best of Opposite Sex in Veteran Sweepstakes.

VETERAN SWEEPSTAKES CLASSIFICATION

VETERAN DOGS, 6 yrs. & under 8 yrs.	VETERAN BITCHES, 6 yrs. & under 8 yrs.
VETERAN DOGS, 8 yrs. & under 10 yrs.	VETERAN BITCHES, 8 yrs. & under 10 yrs.
VETERAN DOGS, 10 yrs.& older	VETERAN BITCHES, 10 yrs.& older

SWEEPSTAKES & VETERAN SWEEPSTAKES PRIZE MONEY

40% of total entry fees will be retained by Club for expenses. The remaining 60% (for each Sweepstakes: Puppy & Veteran) is available for prize money. The entry fees for each class will be divided as follows:

ENTRIES	FIRST PLACE	SECOND PLACE	THIRD PLACE	FOURTH PLACE
4 or More in Class	40%	30%	20%	10%
3 in Class	50%	30%	20%	---
2 in Class	60%	40%	---	---
1 in Class	100%			

AKC NATIONAL OWNER-HANDLED SERIES (NOHS)

The AKC National Owner-Handled Series is a non-titling competition for dogs that are exhibited by their owners that are not professional handlers. Exhibitors must declare their dog is Owner-Handled eligible at the time of entry on the entry form. Dogs entered in the Amateur-Owner-Handler class will automatically be marked as eligible to compete in the NOHS. Eligible dogs will be identified by an asterisk in the judge's book, steward's book & the catalog. Professional handlers,* household members and current assistants to professional handlers** may not exhibit. Dogs must be handled by an eligible owner/handler for the AKC NOHS throughout the breed level (all classes, Winners, and Best of Breed) competition. Owner-Handled Best of Breed will be selected from the dogs that are eligible to compete in the Best of Breed competition including Winners Dog, Winners Bitch and winners of the non-regular classes.

**Professional handlers are defined as any person who belongs or has belonged to a professional handlers' organization, distributed rate cards, or otherwise advertised or represented themselves as handling dogs for pay within the last five years.*

***A current assistant is defined as anyone employed by a professional handler on a full-time basis, or assisting a professional handler at the show or any time during the cluster/weekend. Current assistants that are eligible to compete in Junior Showmanship (meet age & amateur status requirements) may participate in NOHS.*



**American
Kennel Club®**

The American Kennel Club Rules and Regulations will govern this Show and Exhibitors must make themselves familiar with the agreement of the American Kennel Club, referred to on the reverse side of the entry blanks that accompany this Show Premium List.

- The American Kennel Club will collect: a \$3.00 Event Service Fee and \$.50 Recording Fee where applicable for the first entry of a dog, plus a \$3.00 service fee for each additional entry of the same dog in the regular and non-regular recordable single-entry classes, in all AKC licensed and member club events. At every licensed or member club rally trial, a recording fee of \$3.50 is required for the first entry of each dog and a recording fee of \$3.00 is required for each additional entry of the same dog.
- No Entry will be accepted which specifies any condition as to its acceptance. Telegraph, e-mail and unsigned entries cannot be accepted and will be returned. Entries not on Official AKC Entry Forms and Photocopies of Entry Forms without Agreement and Rules on reverse side are NOT ACCEPTABLE. The Club and/or Baray Events assumes no responsibility for wrong or incomplete information given on the entry blank by the owner or the owner's agent. RESPONSIBILITY FOR COMPLETENESS OF ENTRY RESTS SOLELY WITH ENTRANT.
- RETURNED CHECKS DO NOT CONSTITUTE A VALID ENTRY FEE. BaRay Events will add a \$30.00 collection fee to the amount of each returned check. We will not re-process checks. The exhibitor will be contacted & required to send a money order for the original amount PLUS the \$30.00 NSF fee. Subsequent returned checks from same person may result in their being put on a CASH ONLY BASIS.
- REFUNDS for cancellations due to judge change or cancellations made prior to entries closing will be mailed by the Club to said Exhibitor or Agent AFTER THE SHOW. An administrative fee of \$5.00 will be withheld from all refunds for entries cancelled prior to the closing of entries.
- Females in season are not permitted to compete in Obedience or Rally Trials. If a female is withdrawn from competition because it came into season and the Superintendent is notified no later than one half hour prior to the start of the first class in the trial, the Clubs is required to refund the entry fee. The Clubs may retain a processing fee and must publish this information in the premium. Clubs may determine the documentation, if any that is required to confirm the female is in season. This shall be stated in the premium. Note: No fee is paid to the AKC for females in season who are withdrawn.
- FAX ENTRIES – Fax entries will be accepted up to closing time. Fee is \$4.00 per dog per show. If the credit card charge is denied for any reason, an additional service charge of \$20.00 will be added. FAX NUMBER: 360-755-2248. This is for Fax Machine ONLY. Incomplete or illegible Fax entries are not acceptable as a valid entry in a show. Proof of transmission is not proof of receipt of a legible or complete transmission (under AKC Rule Ch. 11, Sec. 4). A Fax-Friendly entry blank PDF is available for download at www.BarayEvents.com
- Entries will be acknowledged after entries close with entry acknowledgment and judging program to address on entry. Should Exhibitor NOT receive an acknowledgment within a reasonable time, PLEASE notify BaRay Events at 360-755-7086 or email dogshows@barayevents.com.
- Entry fees shall NOT be refunded in the event that a dog is absent, disqualified, sick, lame, excused by the Judge or Veterinarian, or barred from competition by action of the Show Committee, or because it has been entered incorrectly. There is no refund for DUPLICATE ENTRIES or OVERPAYMENTS. If, because of riots, civil disturbances or other acts beyond the control of the management it is impossible to open, or to complete the Show NO REFUND will be made. To find out about any AKC event cancellations call the AKC Event Cancellation Hotline 877-252-3229.
- Please note: Any hotel or motel listed in the premium list is subject to Event Committee Rules. We expect our exhibitors to be responsible guests. A report that an exhibitor at this show has abused hotel or motel property during this weekend may result in disciplinary action. Clubs reserve the right to decline future entries from the offending party in accordance with the provisions of Chapter 11, Section 15 of the Rules Applying to Dog Shows.
- Dogs need be present only for scheduled judging and will be released if not needed for further judging. Dogs must be ready for judging. Neither the club nor its Superintendent will be responsible or obligated to furnish any service for notifying exhibitors or their agents of Breed or Class Judging. Judges need not wait for any dog holding up a class. Owners or agents alone are responsible for the presence of their dogs in the judging rings.
- Only dogs eligible for these shows will be admitted into the show area. There is no provision for unentered dogs.
- LOSS OR DAMAGE – The Show Committee will use due care and diligence for the welfare of dogs and exhibitors, but will not be responsible for, or assume any liability in the event of any accident or misfortune, to either dogs or exhibitors participating in these Shows. The welfare of an Exhibitor's child is assumed to be the responsibility of the Exhibitor. It is distinctly understood that Exhibitors will exercise control and restraint over their children.
- Exhibitors should follow their veterinarian's recommendation to assure their dogs are free of internal and external parasites, any communicable diseases, and have appropriate vaccinations. Additionally, clubs should include any specific local health requirements; for example proof of rabies vaccination.
- PUBLICATION RIGHTS – By entering this show, all owners, handlers, breeders and kennels agree that all rights to televise, videotape, photograph, advertise, promote and publicize or otherwise exploit this show, or the persons or animals participating in it or the results of the competition before, during or after the event, shall belong solely to The American Kennel Club and their respective assigns, including the use of the names, likenesses or biographical matter of all dogs, owners, handlers, breeders and kennels participating in the show and no such owner, handler, breeder or kennel shall allow any other party to make commercial use of any videotape or photograph of any person or animal participating in this competition.

ENTER ONLINE: <http://www.BarayEvents.com>

TROPHIES 2021

- Best of Breed** – Rosette & Shadow Box
- Best of Winners** – Rosette & Shadow Box
- Best of Opposite Sex** - Rosette & Shadow Box
- Select Dog & Select Bitch** – Rosette
- NOHS Best of Breed** – Rosette & Shadow Box
- Award of Merit** (up to five) – Rosette
- Winners Dog & Winners Bitch** – Rosette
- Reserve Winners Dog & Reserve Winners Bitch** – Rosette
- Best in Sweepstakes** – Rosette & Shadow Box
- Best Opposite Sex to Best in Sweepstakes** – Rosette & Shadow Box
- Best in Veteran Sweepstakes** – Rosette & Shadow Box
- Best Opposite Sex to Best in Veteran Sweepstakes** – Rosette & Shadow Box
- Best Puppy from the Regular Puppy Classes** – Rosette & Shadow Box
- Best Bred By Exhibitor** - Rosette & Shadow Box
- Best Veteran** – Rosette & Shadow Box
- Best Junior Handler** - Rosette & Shadow Box
- Reserve Best Junior Handler** - Rosette & Shadow Box

ROUTES TO THE SHOW

FROM NORTH OR SOUTH (Highway 89-21)
 – Turn west on 400 S. Go 5 blocks, turn left.
 Please enter fairgrounds from west entrances

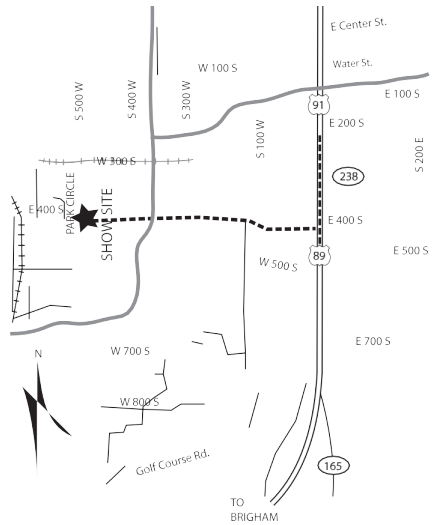

MOTELS THAT WILL ACCEPT PETS

NOTE: These motels will allow guests to have well-behaved dogs in the room provided the guests guarantee to reimburse the management for any damages. Some of these motels will not allow dogs unattended in rooms, some require a pet fee/deposit, and some limit numbers and sizes of dogs. (When calling for reservations let the motel know you are with the dog show as some are making special dispensations for our show). **MAKE RESERVATIONS EARLY.**

- BEST WESTERN WESTON INN** 250 N Main, Logan, UT 435-752-5700 or 800-532-5055
 (Check with hotel for pet fee) Full Breakfast
- LAQUINTA INN AND SUITES BY WYNDHAM** 853 US-89 #91, Logan, UT 435-752-0707
- BEST WESTERN BAUGH MOTEL** 153 S Main, Logan UT 1-800-462-4154 or 435-752-5220
 (Check with hotel for pet fee) Full Breakfast
- SUPER 8 MOTEL** (Check with hotel for pet fee) 865 S Main, Logan, UT 435-753-8883
- COMFORT INN & SUITES** 1665 N Main St, Logan, UT 435-713-4567

All motels have been notified of disciplinary action that WILL be taken if property is abused.

NO BATHING OF DOGS IN THE ROOM.

PLEASE VERIFY THAT MOTEL WILL ACCEPT YOUR DOGS – MANAGERS AND POLICIES CHANGE.

AKC Code of Sportsmanship

PREFACE:

The sport of purebred dog competitive events dates prior to 1884, the year of AKC's birth. Shared values of those involved in the sport include principles of sportsmanship. They are practiced in all sectors of our sport: conformation, performance and companion. Many believe that these principles of sportsmanship are the prime reason why our sport has thrived for over one hundred years. With the belief that it is useful to periodically articulate the fundamentals of our sport, this code is presented.

- Sportsmen respect the history, traditions and integrity of the sport of purebred dogs.
- Sportsmen commit themselves to values of fair play, honesty, courtesy, and vigorous competition, as well as winning and losing with grace.
- Sportsmen refuse to compromise their commitment and obligation to the sport of purebred dogs by injecting personal advantage or consideration into their decisions or behavior.
- The sportsman judge judges only on the merits of the dogs and considers no other factors.
- The sportsman judge or exhibitor accepts constructive criticism.
- The sportsman exhibitor declines to enter or exhibit under a judge where it might reasonably appear that the judge's placements could be based on something other than the merits of the dogs.
- The sportsman exhibitor refuses to compromise the impartiality of a judge.
- The sportsman respects the AKC bylaws, rules, regulations and policies governing the sport of purebred dogs.
- Sportsmen find that vigorous competition and civility are not inconsistent and are able to appreciate the merit of their competition and the effort of competitors.
- Sportsmen welcome, encourage and support newcomers to the sport.
- Sportsmen will deal fairly with all those who trade with them.
- Sportsmen are willing to share honest and open appraisals of both the strengths and weaknesses of their breeding stock.
- Sportsmen spurn any opportunity to take personal advantage of positions offered or bestowed upon them.
- Sportsmen always consider as paramount the welfare of their dog.
- Sportsmen refuse to embarrass the sport, the American Kennel Club, or themselves while taking part in the sport.



**American
Kennel Club®**

ENTRY SUBMISSIONS, CANCELLATIONS, CHANGES, TRANSFERS

MAIL ENTRIES WITH FEES to PO Box 508, Burlington, WA 98233.

CANADIANS make all entry fees payable in U.S. funds.

FAX ENTRIES: Fax number: 360-755-2248. \$4.00 per dog per show added for FAX-Credit Card entries. Both sides of entry form must be transmitted. Entries must be accompanied by a cover sheet stating the number of pages, what shows and how many dogs per show. Visa, MasterCard, and American Express are accepted for Fax entries. Credit card information (Credit Card number, expiration date, and cardholder name) must be on cover sheet. Note: Visa and MasterCard users – You must include the 3-digit security code that appears above your signature on the back of the card. Proof of fax transmission is not proof of receipt of a legible or complete transmission (under AKC Rule Ch. 11, Sec. 4). A Fax-Friendly entry blank PDF is available for download at www.BaRayEvents.com.

ONLINE ENTRIES: Web site is BaRayEvents.com Follow instructions on Web site. \$3.00 charge per dog per show.

FEDEX, UPS, AIRBORNE or HAND-DELIVERED: Do NOT require signature. 113 E. Fairhaven Ave., Burlington, WA 98233.

PHONE ENTRIES WILL NOT BE ACCEPTED.

CANCELLATIONS, CHANGES AND TRANSFERS will be accepted according to AKC Rules. Any refunds will be made within three weeks after the show. An administration fee may apply. (01/2016)