

ENTRIES OPEN WEDNESDAY, MARCH 24, 12:00 NOON PDT

AMERICAN KENNEL CLUB RULES & REGULATIONS GOVERN THESE EVENTS. Entries close at the BaRay Event's Office 12:00PM PDT, Wednesday, MAY 5, 2021, or when any numerical limit is reached, after which time entries cannot be accepted, cancelled or substituted EXCEPT as provided for in Ch. 11, Sec. 6 of the Dog Show Rules. **EVENT NUMBER:** 2021719104

THE *Great Basin*
NON-SPORTING
CLUB of UTAH

PREMIUM LIST

(American Kennel Club Licensed – Outdoors – Unbenched)

NON-SPORTING GROUP SHOW

ENTRY LIMIT 175, INCLUDING JR. SHOWMANSHIP

WEDNESDAY, MAY 19, 2021

Non-Sporting Group Show with NOHS & Jr. Showmanship
Non-Sporting Group Sweepstakes

**Cache County Fairgrounds
450 South 500 West, Logan, UT**

An inherent risk of exposure to COVID-19 exists in any public place where people are present. COVID-19 is an extremely contagious disease that can lead to severe illness and death. By attending these events, you voluntarily assume all risks related to exposure to COVID-19.



**American
Kennel Club®**

CERTIFICATION Permission has been granted by the American Kennel Club for the holding of this event under the American Kennel Club rules & regulations.

GINA M. DINARDO, Executive Secretary



BaRay Event Services, Inc.

A.K.C. ANNUALLY LICENSED SUPERINTENDENTS
MEMBER: DOG SHOW SUPERINTENDENTS ASSOCIATION

•SHEILA RAYMOND•BECKY SUMNER•JERRY SUMNER•CHUCK ST. JOHN
•DALE NEUKOM, JR•JEFFERY INMAN•GLENN WHITTEN•KRISTIN MARICICH
•ROBERTA MARTIN•GUY MICHELSON•SHARON SAMSON

PO BOX 508, BURLINGTON, WA 98233
PHONE: 360-755-7086 • FAX: 360-755-2248

HAND-DELIVERED, EXPRESS or PRIORITY, FEDEX or UPS:
113 E. FAIRHAVEN AVE., BURLINGTON, WA 98233 (do NOT require signature)
E-MAIL: dogshows@barayevents.com • WEB SITE: BaRayEvents.com

OFFICE HOURS
10AM-5PM
PACIFIC TIME
MON-FRI.

Like us on
FACEBOOK



SHOW HOURS EACH DAY - 8:00AM to 7:00PM - MDT

Dogs are not required to be at the show until scheduled time of judging.

All dogs not needed for further judging will be excused.

The Show Site & RV Parking will be available to exhibitors after 2:00PM Tuesday. On Wednesday, overnight parking will be available after 10:00AM. Dogs must be removed from the show site 1.5 hours after Best in Show on Sunday.

OFFICERS

Gayle DenmanPresident Lynda Wolfe Vice President
Jackie BowenTreasurer Bruce Swift Secretary
1961 E Cedar Loop Drive, Weber, UT 84405

BOARD OF DIRECTORS – Shelly Bowen, Melanie North, Kim Thomas

SHOW COMMITTEE

Gayle Denman – Show Chair

PO Box 71160, Salt Lake City, UT 84171 • 801-824-8295 • gmdenman@gmail.com

Officers of the Club and Members of the Board of Directors

COMMITTEES

Melanie North Trophies Melia Dudley Trophies Co-Chair
Carol Enright Publicity Kim Thomas Hospitality
Shelly Bowen Grounds Carol Enright Chief Ring Steward

SHOW VETERINARIAN (ON-CALL)

Bridgeland Cache Animal Hospital – 95 W 900 N, Logan, UT 84321 • 435-752-2151

DIRECTIONS TO CLINIC: Out of the Fairgrounds go North 1/2 block to 400 South, turn right and go East on 400 S (.7 mi). Turn left onto Main Street (US89/US91). Continue on Main to 900 N (1.7 mi). Turn left onto 900 North. Go 1 block to 95 W. The clinic is on the North side of the street.

MEDICAL EMERGENCY SERVICES

DIRECTIONS TO LOGAN REGIONAL HOSPITAL: 1400 N 500 E, Logan, UT 84341, 435-716-5307. From show site go East on 400 S 5 blocks to State Street Highway 89/91. Turn left & go North to 1400 N, turn right and go 5 blocks East.

SHOW PHOTOGRAPHER

Bill Kohler & Associates, Inc. – Bill, Jan and Bob Kohler

2202W Edgemont Ave, Phoenix, AZ 85009-1941

602-271-9953 • 602-340-1263 fax • billkohlerphoto@msn.com

JUDGES

Ms. Marcie S Dobkin [6442] 14558 TOPSHAM ST, POWAY, CA 92064
All Non-Sporting Conformation Classes & Non-Sporting Group, Junior Showmanship
Mrs. Lisa Graser [37267] 45 LITTLE CHUCKEY CUTOFF, MOSHEIM, TN 37818
All Sweepstakes Classes & Non-Sporting NOHS Group & Bred by Exhibitor Group

ENTRY FEES

Highest Priced Class considered the FIRST ENTRY
Separate Fee for each dog – Includes AKC Fees where applicable

First Entry of Each Dog \$28.00
Each Additional Entry of Same Dog, unless otherwise specified \$20.00
First Entry in Puppy Classes (6-9 mos. & 9-12 mos.), Bred by Exhibitor & Veteran Classes \$23.00
Junior Showmanship Only or as Additional Class No Fee
Sweepstakes (dog must be entered in a regular class) \$15.00
Veteran Sweepstakes (dog need not be entered in an additional class) \$15.00

MAIL ENTRIES WITH FEES to BaRay Event Services, PO Box 508, Burlington, WA 98233

See Entry Submission Guidelines, Page 10

VARIETY GROUP JUDGING

Non-Sporting Group	Ms. Marcie S Dobkin
NOHS Non-Sporting Group	Mrs. Lisa Graser
Bred by Exhibitor Non-Sporting Group	Mrs. Lisa Graser
American Eskimo Dog	Ms. Marcie S Dobkin
Bichon Frise	Ms. Marcie S Dobkin
Boston Terrier	Ms. Marcie S Dobkin
Bulldog	Ms. Marcie S Dobkin
Chinese Shar-Pei	Ms. Marcie S Dobkin
Chow Chow	Ms. Marcie S Dobkin
Coton de Tulear	Ms. Marcie S Dobkin
Dalmatian	Ms. Marcie S Dobkin
Finnish Spitz	Ms. Marcie S Dobkin
French Bulldog	Ms. Marcie S Dobkin
Keeshond	Ms. Marcie S Dobkin
Lhasa Apso	Ms. Marcie S Dobkin
Lowchen	Ms. Marcie S Dobkin
Norwegian Lundehund	Ms. Marcie S Dobkin
Miniature Poodle	Ms. Marcie S Dobkin
Standard Poodle	Ms. Marcie S Dobkin
Schipperke	Ms. Marcie S Dobkin
Shiba Inu	Ms. Marcie S Dobkin
Tibetan Spaniel	Ms. Marcie S Dobkin
Tibetan Terrier	Ms. Marcie S Dobkin
Xoloitzcuintli	Ms. Marcie S Dobkin
Junior Showmanship	Ms. Marcie S Dobkin
Sweepstakes	Mrs. Lisa Graser
Veteran Sweepstakes	Mrs. Lisa Graser

ATTENTION EXHIBITORS

Please clean up after your dogs on the show grounds and at your motel site. We want to retain these facilities for future events.

Remember, all complaints regarding conduct prejudicial to the sport will be dealt with in accordance with AKC rules, by the Show Committee.

SMOKING is not permitted on Cache County Fairgrounds property. This will be enforced.

The Great Basin Non-Sporting Club of Utah does not agree to arbitrate claims as set forth on the Official AKC entry form for these events.

**ALL GROUNDS RULES LISTED IN THE MT OGDEN KENNEL CLUB PREMIUM LIST
ARE IN EFFECT AT THIS SHOW,**

PARKING INFORMATION & RESERVED GROOMING

**RESERVED OVERNIGHT PARKING INFORMATION, DAY OF SHOW PARKING INFORMATION
and INDOOR GROOMING INSTRUCTIONS – REFER TO MT. OGDEN KENNEL CLUB PREMIUM LIST
For questions contact Pat Jenkins – 435-770-0334 – pmj16@msn.com**

RIBBON/ROSETTE PRIZES

The Ribbon Prizes in all Regular Classes will be as follows:

First Prize.....	Blue Ribbon	Second Prize.....	Red Ribbon
Third Prize.....	Yellow Ribbon	Fourth Prize.....	White Ribbon
Winners.....	Purple Ribbon	Reserve Winners.....	Purple & White
Best of Winners.....	Blue & White Ribbon	Selects.....	Light Blue & White Ribbon
Best of Each Breed and Best of Each Variety of Breed.....			Purple & Gold Ribbon
Best of Opposite Sex to Best of Breed and Best of Variety of Breed.....			Red & White Ribbon
Best Bred by Exhibitor.....	Dark Green Ribbon	Best NOHS in Breed.....	Maroon Ribbon

The Ribbon Prizes in all Non-Regular Classes, Jr. Showmanship & Sweepstakes will be as follows:

First Prize.....	Rose Ribbon	Second Prize.....	Brown Ribbon
Third Prize.....	Light Green Ribbon	Fourth Prize.....	Gray Ribbon
Best Junior Handler.....	Rose & Green Rosette	Reserve Best Jr. Handler.....	Rose & Gray Rosette
Best in Sweepstakes & Veteran Sweepstakes.....			Pink & Green Rosette
Best of Opposite Sex in Sweepstakes & Veteran Sweepstakes.....			Lavender Rosette

VARIETY GROUPS

First Prize.....	Blue Rosette	Second Prize.....	Red Rosette
Third Prize.....	Yellow Rosette	Fourth Prize.....	White Rosette
Best in Show.....			Red, White & Blue Rosette
Reserve Best in Show.....			Black, Irish Gold, & Cream Rosette

NOHS VARIETY GROUP ROSETTES

First Prize.....	Neon Pink Rosette	Second Prize.....	Neon Green Rosette
Third Prize.....	Teal Rosette	Fourth Prize.....	Cream Rosette
Reserve Best in Show.....	Light Green Rosette	Best in Show.....	Turquoise Rosette

BRED BY EXHIBITOR GROUP ROSETTES – SEE GUIDELINES, PAGE 7

First Prize.....	Rose Rosette	Second Prize.....	Brown Rosette
Third Prize.....	Light Green Rosette	Fourth Prize.....	Gray Rosette

SWEEPSTAKES

Sweepstakes classes are open to all non-sporting dogs at least six months and not over 18 months old on the day of the show. Breeds will be judged together, divided by age. Dogs must be entered in the regular classes of this show. No dog may be handled by a Professional Handler unless handler is the registered owner of the dog.

Sweepstakes Classes – All Breeds Shown Together, Divided by Sex

Puppy Dogs, 6 months and under 9	Puppy Bitches, 6 months and under 9
Puppy Dogs, 9 months and under 12	Puppy Bitches, 9 months and under 12
Dogs, 12 months and under 15	Bitches, 12 months and under 15
Dogs, 15 months and under 18	Bitches, 15 months and under 18

Winners of each class will compete for

Best in Sweepstakes • Best of Opposite Sex to Best in Sweepstakes

VETERAN SWEEPSTAKES

Veteran Sweepstakes classes are open to all non-sporting dogs 7 years of age and older. Breeds will be judged together, divided by age. Dogs need not be entered in the regular classes of this show. No dog may be handled by a Professional Handler unless handler is the registered owner of the dog.

Veteran Sweepstakes Classes – All Breeds Shown Together, Divided by Sex

Dogs, 7 yrs. & under 9 yrs.	Bitches, 7 yrs. & under 9 yrs.
Dogs, 9 yrs. & under 11 yrs.	Bitches, 9 yrs. & under 11 yrs.
Dogs, 11 yrs.& older	Bitches, 11 yrs.& older

Winners of each class will compete for

Best in Veteran Sweepstakes • Best of Opposite Sex to Best in Veteran Sweepstakes

DIVISION OF ENTRY MONEY – SWEEPSTAKES & VETERAN SWEEPSTAKES

Club to retain 35% of total Sweepstakes entry fees to defray expenses.

Of the remaining 65 percent, 10 percent will be awarded as follows:

6% Best in Sweepstakes/Veteran Sweepstakes • 4% Best of Opposite Sex.

The remainder will be known as the Sweepstakes Fund and will be awarded as follows, based on the entry in each particular class.

First Prize.....	50%	Second Prize.....	25%
Third Prize.....	15%	Fourth Prize.....	10%

CLASSIFICATION

Classes Open To All AKC Non-Sporting Breeds

Classes are offered for all breeds or varieties of AKC Non-Sporting breeds. Where classes are further divided by color, weight, or other breed characteristics, it is so indicated below, and the class division MUST be indicated on entry form.

Regular Classes

PUPPY DOGS (6 mos. & under 9 mos.)	PUPPY BITCHES (6 mos. & under 9 mos.)
PUPPY DOGS (9 mos. & under 12 mos.)	PUPPY BITCHES (9 mos. & under 12 mos.)
DOGS (12 mos. & under 18 mos.)	BITCHES (12 mos. & under 18 mos.)
NOVICE DOGS	NOVICE BITCHES
AMATEUR-OWNER-HANDLER DOGS	AMATEUR-OWNER-HANDLER BITCHES
BRED BY EXHIBITOR DOGS	BRED BY EXHIBITOR BITCHES
AMERICAN BRED DOGS	AMERICAN BRED BITCHES
OPEN DOGS	OPEN BITCHES
WINNERS DOG	WINNERS BITCH

Non-Regular Classes Involving Single Dog Entries

VETERAN DOGS	VETERAN BITCHES
--------------	-----------------

A class for Dogs and a class for Bitches, 7 years of age and older. Dogs/bitches entered in Veterans must be intact. Winners, if otherwise undefeated, are eligible for Best of Breed competition.

BEST OF BREED (VARIETY) COMPETITION – The following categories of dogs may be entered and shown in Best of Breed (Variety) Competition: Dogs that are Champions of Record and dogs which according to their owners' records, have completed the requirements for a championship, but whose championships are unconfirmed. The showing of unconfirmed champions in Best of Breed (Variety) Competition is limited to a period of 90 days from the date of the show where the dog completed the requirements for a championship.

BREEDS WITH OPEN CLASS DIVISIONS – MUST BE INDICATED ON ENTRY BLANK

OPEN CLASSES DIVIDED, BOTH SEXES AS LISTED BELOW IN THE FOLLOWING BREEDS

American Eskimo Dogs: Toy (9 in. to & including 12 in.), Miniature (over 12 in. to & including 15 in.),

Standard (over 15 in. to & including 19 in.)

Boston Terriers: Under 15 lbs., 15 lbs. & Over.

Chinese Shar-Pei: Brush Coat; Horse Coat.

Chow Chows: Rough Coat, Black; Red; AOC. Smooth Coat.

Dalmatians: Black Spotted, Liver Spotted

JUNIOR SHOWMANSHIP COMPETITION – NON-SPORTING BREEDS ONLY

NOVICE CLASS: This shall be for boys and girls who are at least 9 years old and under 18 years old on the day of the show and who at the time entries close have not won three (3) first place awards, with competition present, in a Novice Class.

OPEN CLASS: For boys and girls who are at least 9 years old and under 18 years old on the day of the show, and who have won three first place awards in a Novice Class or if a win in Novice leads to a Best Junior with competition present it will count as one win towards moving to Open in a licensed or member show.

MASTER CLASS: This class will be for boys and girls who are at least 9 years old and under 18 years on the day of the show, and who have 10 Best Junior wins with competition. The calendar for this class will be consistent with the eligibility dates for the AKC National Championship. All Juniors meeting the criteria for this class are required to enter the Master Class and may change their entry the day of the show if entries have already closed. Once the eligibility time frame for that year has passed all participants return to the Open Class to compete for the following year.

NOVICE AND OPEN CLASS DIVIDED: **Junior**-9 years old and under 12 years old on the day of the show;

Intermediate-12 years old and under 15 years old on the day of the show; **Senior**-15 years old and under 18 years old on the day of the show.

After the judge has awarded the Best Junior Handler, the second place winner from the class that the Junior was awarded Best Junior Handler returns to the ring to compete for Reserve Best Junior Handler.

NOTICE: Junior Handlers must include their AKC JUNIOR HANDLER NUMBER on each entry. You may obtain your junior identification number by calling the AKC, Judges Education Department, 919-233-9767. BE SURE ALL INFORMATION for Junior Showmanship Classes is entered on front and back of entry form.

NOTE: SUBSTITUTION OF DOG IN JUNIOR SHOWMANSHIP AT THE SHOW(S): There will be an Administration Fee of \$5.00 charged for any substitution of dog in Junior Showmanship at each show. In addition, if the dog originally entered in Jr. Showmanship was an additional entry, and the dog being substituted is not otherwise entered in the show, the Junior Showmanship Only fee applies.

AKC NATIONAL OWNER-HANDLED SERIES



The AKC National Owner-Handled Series is a non-titling competition for dogs that are exhibited by their owners that are not professional handlers. Exhibitors must declare their dog is Owner-Handled eligible at the time of entry on the entry form. Dogs entered in the Amateur-Owner-Handler class will automatically be marked as eligible to compete in the NOHS. Eligible dogs will be identified by an asterisk in the judge's book, steward's book & the catalog. Professional handlers,* household members and current assistants to professional handlers** may not exhibit. Dogs must be handled by an eligible owner/handler for the AKC NOHS throughout the breed level (all classes, Winners, and Best of Breed) competition. Additionally, dogs must be handled by an eligible owner/handler for all AKC National Owner-Handled Series competition (Group). Any person may exhibit the dog in the regular Group.

Owner-Handled Best of Breed will be selected from the dogs that are eligible to compete in the Best of Breed competition including Winners Dog, Winners Bitch and winners of the non-regular classes.

- If the Best of Breed/Variety winner is Owner-Handled competition eligible, it will automatically be Owner-Handled Best of Breed/Variety and be eligible to compete in both the regular as well as the Owner-Handled group.
- If the Best of Breed/Variety winner is not eligible for Owner-Handled competition and the Best of Opposite Sex to Best of Breed/Variety is eligible, the Best of Opposite Sex to Best of Breed/Variety will compete against the eligible exhibits of the other sex to determine Owner-Handled Best of Breed/Variety.
- If neither the Best of Breed nor the Best of Opposite Sex to Best of Breed/Variety are Owner-Handled competition eligible and Select Dog & Select Bitch are both eligible, the judge is to choose Best Owner-Handled exhibit from the Selects and eligible Winners Dog or Winners Bitch.
- If one of the Selects is eligible, excuse all Champions and non-regular class winners of the same sex and then choose Best Owner-Handled exhibit from the remaining dogs of the opposite sex including the eligible Winners.
- If Best of Breed, Best of Opposite Sex to Best of Breed, Select Dog & Select Bitch are not eligible, the judge may choose any eligible dog remaining in the ring including Winners Dog or Winners Bitch as Owner-Handled Best of Breed/Variety.
- If the Best of Winners is eligible, the other Winner is ineligible since it was defeated.
- No class dogs other than the Winners Dog & Winners Bitch are eligible to return to the ring.

The breed will not be represented in the Owner-Handled Group if there is no eligible dog competing in the Best of Breed or in Best of Winners competition.

**Professional handlers are defined as any person who belongs or has belonged to a professional handlers' organization, distributed rate cards, or otherwise advertised or represented themselves as handling dogs for pay within the last five years.*

***A current assistant is defined as anyone employed by a professional handler on a full-time basis, or assisting a professional handler at the show or any time during the cluster/weekend. Current assistants that are eligible to compete in Junior Showmanship (meet age & amateur status requirements) may participate in NOHS. (05/20)*

USE OF RAMPS – NON-SPORTING BREEDS

A judge requesting the use of a ramp must give notice to the show superintendent/show secretary prior to judging. AKC approval is not required. The entire entry in a breed is to be examined in the same manner (ground, table, or ramp).

At the discretion of the judge, the following breeds may be judged on a ramp through all levels of competition: Finnish Spitz.

The following breeds must be judged on a ramp through all levels of conformation competition: Bulldogs, Chinese Shar-Pei, Chow Chows and Keeshonden.

This extends to all conformation competition at AKC conformation dog shows and any AKC event where a conformation title may be earned. This policy includes Group, BIS, Junior Showmanship, the 4–6 Month Beginner Puppy Competition, the AKC National Owner-Handled Series (NOHS), and all other special attractions that offer Group and BIS competitions. Ramps can be used in emergency situation to judge any breed.

In an emergency situation, where use of a ramp is not indicated in the premium list, an exhibitor has the option of withdrawing their entry and receiving a refund. For the judging of juniors the ramp may be used at the discretion of the judge for the ramp optional breeds. (01/2021)

TROPHIES

VARIETY GROUP PRIZES

FIRST IN REGULAR GROUP – \$100.00 – Offered by Cindie Swaim, LeMar’s Tibetan Spaniels

SECOND IN REGULAR GROUP – \$75.00 – Offered by Kim Thomas, Concord Frenchies

THIRD IN REGULAR GROUP – \$50.00 – Offered by Gayle & Dick Denman, Gandalf’s Miniature Bull Terriers

FOURTH IN REGULAR GROUP – \$25.00 – Offered by Nancy Lloyd, High Societys Bulldogs

FIRST, SECOND, THIRD & FOURTH IN GROUP – ROSETTE – Offered by the Great Basin Non-Sporting Club of Utah

OWNER-HANDLED GROUP PRIZES

FIRST IN OWNER-HANDLED GROUP – \$75.00 Offered by Kailien Vernon, DeWinter Poodles

SECOND IN OWNER-HANDLED GROUP – \$50.00..... Offered by Bruce Swift, Kotu Poodles

THIRD IN OWNER-HANDLED GROUP – \$25.00..... Offered by Teresa Bramwell

FOURTH IN OWNER-HANDLED GROUP – \$15.00 Offered by Nancy Lloyd, High Societys Bulldogs

FIRST, SECOND, THIRD & FOURTH IN O/H GROUP – ROSETTE Offered by the Great Basin Non-Sporting Club of Utah

JUNIOR SHOWMANSHIP COMPETITION PRIZES

BEST JUNIOR HANDLER – \$25.00 Hathaway’s Gift Card (not redeemable for cash) – Offered by Hathaway’s Best In Show. ROSETTE, Offered by the Great Basin Non-Sporting Club of Utah

RESERVE BEST JUNIOR HANDLER – \$15.00 Hathaway’s Gift Card (not redeemable for cash) – Offered by the Wolfes, HyContry’s Kennels. RIBBON – Offered by the Great Basin Non-Sporting Club of Utah

SWEEPSTAKES & VETERAN SWEEPSTAKES PRIZES

BEST IN SWEEPSTAKES – \$25.00 Hathaway’s Gift Card (not redeemable for cash) – Offered by Louise Ekenstam. ROSETTE – Offered by the Great Basin Non-Sporting Club of Utah

BEST IN VETERAN SWEEPSTAKES – \$25.00 Hathaway’s Gift Card (not redeemable for cash) – Offered by Jackie & Shelly Bowen, Redlion. ROSETTE – Offered by the Great Basin Non-Sporting Club of Utah

BEST BRED-BY-EXHIBITOR GROUP PRIZES

FIRST IN BRED-BY-EXHIBITOR GROUP – \$25.00 Hathaway’s Gift Card (not redeemable for cash) – Offered by Bruce Swift, Kotu Poodles

FIRST, SECOND, THIRD & FOURTH IN BRED-BY-EXHIBITOR GROUP – ROSETTE– Offered by the Great Basin Non-Sporting Club of Utah

Best Bred by Exhibitor will be awarded from the First Place winners in the Bred by Exhibitor classes immediately following each breed. If the Best of Breed is awarded to a dog/bitch coming from a Bred by Exhibitor Class for that breed, the Best Bred by Exhibitor win is automatic. Bred by Exhibitor Group Judging will be judged following Regular Group judging.

BREED PRIZES

BULLDOGS – Best of Breed, Best of Opposite Sex, Best of Winners, Select Dog, Select Bitch – \$15.00 Hathaway’s Gift Card (not redeemable for cash) – Offered by Jimmy Bane and William Clayton, Bane Bulldogs

STANDARD POODLES – Best of Variety – \$15.00 Hathaway’s Gift Card (not redeemable for cash) – Offered by Karen Betker Green, Desert Reef Standard Poodles.

MINIATURE POODLES – Best of Variety – \$15.00 Hathaway’s Gift Card (not redeemable for cash) – Offered by Karen Betker Green, Desert Reef Standard Poodles.

COVID 19 SHOW EVENT POLICIES

ALL OF US TOGETHER

The policies below were developed for the well being of all of us and with current guidance from AKC's Suggested Best Practices For The Well-Being of Dog Sport Participants, the CDC, and the state of Utah. Because the incidence of COVID-19 can change rapidly, we may adjust our policies. Please review the club's policies that will be displayed at each ring.

The general public is not allowed at these shows due to COVID-19.

FACE MASK/COVERINGS

All club members, volunteers, judges, exhibitors, and spectators will wear face masks during show hours while on show grounds. As per current science, bandanas, face shields without an accompanying mask, neck gaiters and masks with vents are ineffective and, therefore, these are prohibited. If you have any questions or concerns about underlying health issues and this policy, please consult a physician. You are requested to maintain a minimum of 6 feet of physical distance with anyone not residing in your household.

DO NOT ATTEND THE SHOWS

If you or a household member have any of the following symptoms, or if you have recently been exposed to Covid 19, or if you develop any of the following symptoms during the show weekend, do not attend the show(s) and follow CDC, your state, and Utah state guidelines. As per the CDC website:

People with COVID-19 have had a wide range of symptoms reported – ranging from mild symptoms to severe illness. Symptoms may appear 2-14 days after exposure to the virus. People with these symptoms may have COVID-19: Fever or chills, cough, shortness of breath or difficulty breathing, fatigue, muscle or body aches, headache, new loss of taste or smell, sore throat, congestion or runny nose, nausea or vomiting, diarrhea.

NOTE: This list does not include all possible symptoms. CDC will continue to update this list as we learn more about COVID-19.

If you later test Covid 19 positive, or have a suspected case, contact your state health officials and Utah State health officials at coronavirus.utah.gov, and provide them with relevant show chair(s) contact information.

BRING YOUR OWN

Face mask - note: *bandanas, face shields without an accompanying mask, neck gaiters and masks with vents are ineffective and, therefore, these face coverings are prohibited;* CDC recommended hand sanitizer; disposable gloves, if desired; food, water, pens, personal items.

**These shows are outdoor shows,
please bring: grooming tools, including generators,
there will be no indoor grooming; easy ups with 3 sided coverings
if you intend to use a blow dryer.**

SUGGESTED COVID-19 GUIDANCE WEBSITES:

AKC.org; coronavirus.Utah.Gov; CDC.gov

<p>Vehicles that are parked illegally will be towed by the Logan City Police Department. If your vehicle is towed, you will be charged for towing as well as possible impound charges. WE MUST KEEP FIRE LANES as well as some other areas clear. PLEASE PARK ONLY IN DESIGNATED AREA</p>

COVID 19 WAIVER FORM

GREAT BASIN NON-SPORTING CLUB OF UTAH MAY 19, 2021

NOTICE

ANYONE WHO ATTENDS THIS GROUP SHOW MUST SIGN THIS FORM

(Exhibitors, Owners, Handlers, Breeders, Assistants, Vendors, Family, Friends, Etc)

If you are on the show grounds, this form must be on file.

This also includes minor children under 18 years of age.

I fully attest to the best of my knowledge I do not have COVID-19 at the time of attending this event. I, also, attest I have not been in contact with or exposed to any known carrier of COVID-19 within the past 14 days. I agree that I am attending the above-mentioned show entirely at my own risk and take full responsibility for my own health and safety during this event. I will follow all AKC, Club & Cache County Fairground requirements, procedures, protocols and guidelines to reduce any exposure and possibility of contracting or spreading the Covid-19 virus. I will also follow CDC, Federal, State of Utah, Cache County, and City of Logan guidelines in regard to COVID-19. I fully submit that the AKC, Great Basin Non-Sporting Club of Utah, Mount Ogden Kennel Club and all other contracted staff & employees, any workers or volunteers, or any event attendees are in no way liable for any present or future COVID-19 exposure incurred at any time by any person, in attendance or not in attendance, during or after this event, and hereby waive all rights to file a lawsuit against above and aforementioned if I am exposed to COVID-19. By signing this waiver below, I hereby agree to & agree to follow everything contained within this waiver.

I also state that I do not have any of the following symptoms: fever or chills, cough, shortness of breath or difficulty breathing, fatigue, muscle or body aches, headache, new loss of taste or smell, sore throat, congestion or runny nose, nausea or vomiting, diarrhea.

Signature: _____

Print Name: _____

Print Name of Minor child under 18 years of age:* _____

Address: _____

Cell Phone: _____ Date: _____

PRINT, FILL OUT & BRING THIS FORM WITH YOU.

YOU MUST HAND IN THE FORM TO GET YOUR WRISTBAND

NO FORM – NO WRISTBAND – NO SHOW – NO EXCEPTIONS

*Use a new form for each minor child

ROUTES TO THE SHOW

FROM NORTH OR SOUTH (Highway 89-21)
 – Turn west on 400 S. Go 5 blocks, turn left.
 Please enter fairgrounds from west entrances

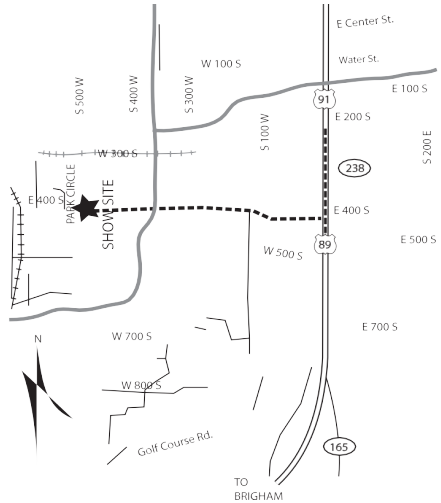

MOTELS THAT WILL ACCEPT PETS

NOTE: These motels will allow guests to have well-behaved dogs in the room provided the guests guarantee to reimburse the management for any damages. Some of these motels will not allow dogs unattended in rooms, some require a pet fee/deposit, and some limit numbers and sizes of dogs. (When calling for reservations let the motel know you are with the dog show as some are making special dispensations for our show). **MAKE RESERVATIONS EARLY.**

- BEST WESTERN WESTON INN** 250 N Main, Logan UT 435-752-5700 or 800-532-5055
 (Check with hotel for pet fee) Full Breakfast
- LAQUINTA INN AND SUITES BY WYNDHAM** 853 US-89 #91, Logan UT 435-752-0707
- BEST WESTERN BAUGH MOTEL** 153 S Main, Logan UT 1-800-462-4154 or 435-752-5220
 (Check with hotel for pet fee) Full Breakfast
- SUPER 8 MOTEL** (Check with hotel for pet fee) 865 S Main, Logan UT 435-753-8883
- COMFORT INN & SUITES** 1665 N Main St, Logan, UT 435-713-4567

All motels have been notified of disciplinary action that WILL be taken if property is abused.
NO BATHING OF DOGS IN THE ROOM.

PLEASE VERIFY THAT MOTEL WILL ACCEPT YOUR DOGS – MANAGERS AND POLICIES CHANGE.

ENTRY SUBMISSIONS, CANCELLATIONS, CHANGES, TRANSFERS

MAIL ENTRIES WITH FEES to PO Box 508, Burlington, WA 98233.

CANADIANS make all entry fees payable in U.S. funds.

FAX ENTRIES: Fax number: 360-755-2248. \$4.00 per dog per show added for FAX-Credit Card entries. Both sides of entry form must be transmitted. Entries must be accompanied by a cover sheet stating the number of pages, what shows and how many dogs per show. Visa, MasterCard, and American Express are accepted for Fax entries. Credit card information (Credit Card number, expiration date, and cardholder name) must be on cover sheet. Note: Visa and MasterCard users – You must include the 3-digit security code that appears above your signature on the back of the card. Proof of fax transmission is not proof of receipt of a legible or complete transmission (under AKC Rule Ch. 11, Sec. 4). A Fax-Friendly entry blank PDF is available for download at www.BarayEvents.com.

ONLINE ENTRIES: Web site is BaRayEvents.com Follow instructions on Web site. \$3.00 charge per dog per show.

FEDEX, UPS, AIRBORNE or HAND-DELIVERED: Do NOT require signature. 113 E. Fairhaven Ave., Burlington, WA 98233.

PHONE ENTRIES WILL NOT BE ACCEPTED.

CANCELLATIONS, CHANGES AND TRANSFERS will be accepted according to AKC Rules. Any refunds will be made within three weeks after the show. An administration fee may apply. (01/2016)

NOTICE TO EXHIBITORS – ALL EVENTS



**American
Kennel Club®**

The American Kennel Club Rules and Regulations will govern this Show and Exhibitors must make themselves familiar with the agreement of the American Kennel Club, referred to on the reverse side of the entry blanks that accompany this Show Premium List.

- The American Kennel Club will collect: a \$3.00 Event Service Fee and \$.50 Recording Fee where applicable for the first entry of a dog, plus a \$3.00 service fee for each additional entry of the same dog in the regular and non-regular recordable single-entry classes, in all AKC licensed and member club events. At every licensed or member club rally trial, a recording fee of \$3.50 is required for the first entry of each dog and a recording fee of \$3.00 is required for each additional entry of the same dog.
- No Entry will be accepted which specifies any condition as to its acceptance. Telegraph, e-mail and unsigned entries cannot be accepted and will be returned. Entries not on Official AKC Entry Forms and Photocopies of Entry Forms without Agreement and Rules on reverse side are NOT ACCEPTABLE. The Club and/or Baray Events assumes no responsibility for wrong or incomplete information given on the entry blank by the owner or the owner's agent. RESPONSIBILITY FOR COMPLETENESS OF ENTRY RESTS SOLELY WITH ENTRANT.
- RETURNED CHECKS DO NOT CONSTITUTE A VALID ENTRY FEE. BaRay Events will add a \$30.00 collection fee to the amount of each returned check. We will not re-process checks. The exhibitor will be contacted & required to send a money order for the original amount PLUS the \$30.00 NSF fee. Subsequent returned checks from same person may result in their being put on a CASH ONLY BASIS.
- REFUNDS for cancellations due to judge change or cancellations made prior to entries closing will be mailed by the Club to said Exhibitor or Agent AFTER THE SHOW. An administrative fee of \$5.00 will be withheld from all refunds for entries cancelled prior to the closing of entries.
- Entries will be acknowledged after entries close with entry acknowledgment and judging program to address on entry. Should Exhibitor NOT receive an acknowledgment within a reasonable time, PLEASE notify BaRay Events at 360-755-7086 or email dogshows@barayevents.com.
- Entry fees shall NOT be refunded in the event that a dog is absent, disqualified, sick, lame, excused by the Judge or Veterinarian, or barred from competition by action of the Show Committee, or because it has been entered incorrectly. There is no refund for DUPLICATE ENTRIES or OVERPAYMENTS. If, because of riots, civil disturbances or other acts beyond the control of the management it is impossible to open, or to complete the Show NO REFUND will be made. To find out about any AKC event cancellations call the AKC Event Cancellation Hotline 877-252-3229.
- Only dogs eligible for these shows will be admitted into the show area. There is no provision for unentered dogs.
- LOSS OR DAMAGE – The Show Committee will use due care and diligence for the welfare of dogs and exhibitors, but will not be responsible for, or assume any liability in the event of any accident or misfortune, to either dogs or exhibitors participating in these Shows. The welfare of an Exhibitor's child is assumed to be the responsibility of the Exhibitor. It is distinctly understood that Exhibitors will exercise control and restraint over their children.
- Exhibitors should follow their veterinarian's recommendation to assure their dogs are free of internal and external parasites, any communicable diseases, and have appropriate vaccinations. Additionally, clubs should include any specific local health requirements; for example proof of rabies vaccination.
- PUBLICATION RIGHTS – By entering this show, all owners, handlers, breeders and kennels agree that all rights to televise, videotape, photograph, advertise, promote and publicize or otherwise exploit this show, or the persons or animals participating in it or the results of the competition before, during or after the event, shall belong solely to The American Kennel Club and their respective assigns, including the use of the names, likenesses or biographical matter of all dogs, owners, handlers, breeders and kennels participating in the show and no such owner, handler, breeder or kennel shall allow any other party to make commercial use of any videotape or photograph of any person or animal participating in this competition.

ENTER ONLINE: <http://www.BaRayEvents.com>