

AMERICAN KENNEL CLUB RULES & REGULATIONS GOVERN THESE EVENTS. Entries close at the BaRay Event's Office 12:00PM PDT, Wednesday, **April 24, 2024**, or when any numerical limit is reached, after which time entries cannot be accepted, cancelled or substituted EXCEPT as provided for in Ch. 11, Sec. 6 of the Dog Show Rules. **EVENT NUMBERS:**

Thu.: 2024092901-C, 2024092902-BP, 2024092911-OP. Fri.: 2024092903-C, 2024092904-BP, 2024092912-OP.
Sat.: 2024092905-C, 2024092906-BP, 2024092913-OP. Sun.: 2024092907-C, 2024092908-BP, 2024092914 -OP.



PREMIUM LISTS

Mount Ogden Kennel Club, Inc.

152nd, 153rd, 154th & 155th

All Breed Dog Shows

(Member of the American Kennel Club)

THURSDAY, FRIDAY, SATURDAY & SUNDAY

MAY 16 - 19, 2024

NOHS - Thursday, Friday & Saturday

Jr Showmanship - All Days • Beginner Puppy 4-6 Mos. - All Days

Cache County Fairgrounds - 450 South 500 West, Logan, UT

Outdoors • Show Hours Each Day - 7:00am To 7:00pm - MDT • Unbenched

FSS OPEN SHOWS • ALL 4 DAYS - PAGES 18-19

GREAT BASIN NON-SPORTING CLUB OF UTAH

Non-Sporting Group Show - Wednesday, May 15, 2024

ON SAME GROUNDS - SEE PREMIUM LIST, PAGES 28-36

ALASKAN MALAMUTE CLUB OF AMERICA

Two Specialty Shows - Wednesday, May 15, 2024

ON SAME GROUNDS - SEE PREMIUM LIST, PAGES 37-44

SCOTTISH DEERHOUND CLUB OF AMERICA

All Breed FastCAT - May 18 & 19, 2024

ON SAME GROUNDS - SEE PREMIUM LIST, PAGE 22



AMERICAN
KENNEL CLUB®

CERTIFICATION Permission has been granted by the
American Kennel Club for the holding of this event
under the American Kennel Club rules and regulations.

GINA M. DINARDO, Executive Secretary



BaRay Event Services, Inc.

A.K.C. ANNUALLY LICENSED SUPERINTENDENTS

MEMBER: DOG SHOW SUPERINTENDENTS ASSOCIATION

• SHEILA RAYMOND • BECKY SUMNER • JERRY SUMNER • ANDREA L. FERNANDEZ
• KRISTIN MARICICH • SHARON SAMSON • ROBERTA MARTIN • GLENN WHITTEN
• KRISTILYN FALKENTHAL • SCOTT KIPP • JEFFERY INMAN • HILLARY TREGILLUS

PO BOX 508, BURLINGTON, WA 98233-0508

PHONE: 360-755-7086 • FAX: 360-755-2248

HAND-DELIVERED, EXPRESS or PRIORITY, FEDEX or UPS:

113 E. FAIRHAVEN AVE., BURLINGTON, WA 98233-0508 (do NOT require signature)

E-MAIL: dogshows@barayevents.com • WEB SITE: BaRayEvents.com

OFFICE HOURS
10AM-5PM
PACIFIC TIME
MON.-FRI.

Like us on
FACEBOOK



MOUNT OGDEN KENNEL CLUB

MOUNT OGDEN KENNEL CLUB OFFICERS

Pat Jenkins	President	Karen Park	Vice President
Pat Jenkins	Treasurer	Leneia Rogowski.....	Rec. & Corres. Secretary
		Leneia.rogowski@comcast.net	

BOARD OF DIRECTORS

Todd Thornton • Kathryn Taylor • Kevin Taylor • Shannon Orr • Justin Scoffield

Delegate to the American Kennel Club – Karen Park

SHOW COMMITTEE

Leneia Rogowski – Show Chair

435-770-9377 • leneia.rogowski@comcast.net

Kathryn Taylor – Assistant Show Chair

Officers of the Club and Members of the Board of Directors

COMMITTEES

Jo Arave.....	Hospitality
Todd Thornton & Pat Jenkins	Grounds & Parking • PO Box 417, Richmond, UT 84333
Leneia Rogowski.....	Catalog, Advertising & Vendors
Karen Park	Health Committee
Justin & Navy Scoffield.....	Trophies
Lyle Harding	Chief Ring Steward

WE SUPPORT & ENCOURAGE THE SHOW CHAIR & SHOW COMMITTEE MEMBERS
TO EXHIBIT THEIR DOGS AT THESE EVENTS.

SHOW VETERINARIAN (ON-CALL)

Bridgeland Cache Animal Hospital

95 W 900 N, Logan, UT 84321 • 435-752-2151

DIRECTIONS TO CLINIC: Out of the Fairgrounds go North 1/2 block to 400 South, turn right and go East on 400 S (.7 mi). Turn left onto Main Street (US89/US91). Continue on Main to 900 N (1.7 mi). Turn left onto 900 North. Go 1 block to 95 W. The clinic is on the North side of the street. (If calling after hours press 1 to talk to a veterinarian. The show is considered a client)

MEDICAL EMERGENCY SERVICES

DIRECTIONS TO LOGAN REGIONAL HOSPITAL: From show site go East on 400 S 5 blocks to State Street Highway 89/91. Turn left & go North to 1400 N, turn right and go 5 blocks East.

We Will Have An EMERGENCY MEDICAL TEAM. An EMT will be onsite all four days.

An AED is located in the Cache Event Center by the office.

SHOW PHOTOGRAPHER

Tyler Crady-Roche • 916-807-6043

Tyler@AllBreedPhoto.com • www.AllBreedPhoto.com

All photos will be available for viewing and purchase within 24 hours after Best In Show

(Donating complimentary photos for any Junior and PeeWee)

The Show Site & RV Parking will be available to exhibitors after 2:00PM Tuesday. On Wednesday & Thursday parking will be available after 10:00AM. While Wednesday's specialty and group shows are occurring, those with RV parking adjacent to the rings will be required to wait until after the conclusion of the specialty and group shows. Dogs must be removed from the show site 1.5 hours after Best in Show on Sunday.

MOUNT OGDEN KENNEL CLUB

ENTRY FEES - EACH DAY - ALL EVENTS

Highest Priced Class considered the FIRST ENTRY

Separate Fee for each dog, each day - Includes AKC Fees where applicable

THE MOUNT OGDEN KENNEL CLUB, INC. IS PLEASED TO CONTINUE TO OFFER LOW ENTRY FEES IN CONSIDERATION OF OUR VALUED EXHIBITORS - THANKS FOR COMING.

First Entry of Each Dog.....	\$30.00
Each Additional Entry of Same Dog, unless otherwise specified.....	\$24.00
First Entry in Puppy Classes (6-9 mos. & 9-12 mos.), Bred by Exhibitor & Veterans.....	\$25.00
Junior Showmanship Only or as Additional Class.....	No Fee
Beginner Puppy 4-6 Months	\$24.00
MAIL ENTRIES WITH FEES to BaRay Event Services, PO Box 508, Burlington, WA 98233	
See Entry Submission Guidelines, Page 24.	

Dogs are not required to be at the show until scheduled time of judging.
All dogs not needed for further judging will be excused.

JUDGES - ALL DAYS

Mrs. Judi Bendt [37568].....	RAPID CITY, SD
Mr. Stephen M Cabral* [5812].....	DUARTE, CA
Mrs. Gayle M Denman [7289].....	SALT LAKE CITY, UT
Mr. Nathaniel Horn [4549].....	KEY LARGO, FL
Mr. Kim Griffith* [99175].....	WESTMORELAND, TN
Mrs. Nancy Lovelady* [97313].....	CARSON CITY, NV
Ms. Helene Nietsch* [7259].....	NEWTOWN, CT
Dr. Tracy Powell* [101481]	BROAD BROOK, CT
Dr. Carlos Roberto Flaquer Rocha [97983].....	SAO PAULO, BRA
Mr. Ekarat Sangkunakup [31494]	NAKHONPATHOM, THI
Mr. Darryl Vice [6255].....	PALM SPRINGS, CA
Dr. Jill Warren* [94859].....	CORRALES, NM

*One or more breeds assigned approved as provisional/permit by AKC

BREEDS WITH OPEN CLASS DIVISIONS AT THESE SHOWS

OPEN CLASS DIVISION MUST BE INDICATED ON ENTRY BLANK

Retrievers (Labrador): Open Classes Divided, Both Sexes: Black; Chocolate; Yellow.

Dachshunds (All Varieties): Open Classes Divided, Both Sexes: Miniature (under 11 lbs. & 12 mos. old or over); Standard (11 lbs. & over and under 11 lbs. if less than 12 mos. old).

Boxers: Open Classes Divided, Both Sexes: Brindle; Fawn.

Bullmastiffs: Open Classes Divided, Both Sexes: Brindle; Any Other Allowed Color.

Doberman Pinschers: Open Classes Divided, Both Sexes: Black; Any Other Allowed Color.

Great Danes: Open Classes Divided, Both Sexes: Black; Blue; Brindle; Fawn; Harlequin; Mantle; Merle.

St Bernards: Open Classes Divided, Both Sexes: Longhaired; Shorthaired.

Pugs: Open Classes Divided, Both Sexes: Black; Fawn.

Boston Terriers: Open Classes Divided, Both Sexes: Under 15 lbs.; 15 lbs. & Over.

Chinese Shar-Pei: Open Classes Divided, Both Sexes: Brush Coat; Horse Coat.

Chow Chows: Open Classes Divided, Both Sexes: Rough Coat: Black, Red, AOC;
Smooth Coat.

Shiba Inu: Open Classes Divided, Both Sexes: Red/RedSesame; Black & Tan/AOAC.

Australian Shepherds: Open Classes Divided, Both Sexes: Black; Blue Merle; Red Merle; Red.

Collies (Rough): Open Classes Divided, Both Sexes: Blue Merle; Sable & White;
Tri-Color; White.

Shetland Sheepdogs: Open Classes Divided, Both Sexes: Sable & White; Any Other
Allowed Color.

MOUNT OGDEN KENNEL CLUB

CLASSIFICATION - ALL MOKC EVENTS

Classes for All Breeds

Classes are offered for all breeds or varieties of breeds. Where classes are further divided by color, weight, or other breed characteristics, it is so indicated in this premium list and the class division MUST be indicated on entry form.

Regular Classes

PUPPY DOGS (6 MOS. & under 9 MOS.)	PUPPY BITCHES (6 MOS. & under 9 MOS.)
PUPPY DOGS (9 MOS. & under 12 MOS.)	PUPPY BITCHES (9 MOS. & under 12 MOS.)
DOGS (12 MOS. & under 18 MOS.)	BITCHES (12 MOS. & under 18 MOS.)
NOVICE DOGS	NOVICE BITCHES
AMATEUR-OWNER-HANDLER DOGS	AMATEUR-OWNER-HANDLER BITCHES
BRED BY EXHIBITOR PUPPY DOGS (6-12 MOS.)	BRED BY EXHIBITOR PUPPY BITCHES (6-12 MOS.)
BRED BY EXHIBITOR ADULT DOGS (12+ MOS.)	BRED BY EXHIBITOR ADULT DOGS (12+ MOS.)
AMERICAN BRED DOGS	AMERICAN BRED BITCHES
OPEN DOGS	OPEN BITCHES
WINNERS DOG	WINNERS BITCH

Non-Regular Classes Involving Single Dog Entries

VETERAN DOG	VETERAN BITCH
-------------	---------------

A class for Dogs and a class for Bitches, 7 years of age and older. Dogs/bitches entered in Veterans must be intact. Winners, if otherwise undefeated, are eligible for Best of Breed competition.

BEST OF BREED (VARIETY) COMPETITION - The following categories of dogs may be entered and shown in Best of Breed (Variety) Competition: Dogs that are Champions of Record and dogs which according to their owners' records, have completed the requirements for a championship, but whose championships are unconfirmed. The showing of unconfirmed champions in Best of Breed (Variety) Competition is limited to a period of 90 days from the date of the show where the dog completed the requirements for a championship. Selects, if applicable, will be chosen following Best of Breed.

RIBBON/ROSETTE PRIZES - EACH DAY

The Ribbon Prizes in all Regular Classes will be as follows:

First Prize.....	Blue Ribbon	Second Prize.....	Red Ribbon
Third Prize.....	Yellow Ribbon	Fourth Prize.....	White Ribbon
Winners.....	Purple Ribbon	Reserve Winners.....	Purple & White Ribbon
Best of Winners.....	Blue & White Ribbon	Selects.....	Light Blue & White Ribbon
Best of Each Breed and Best of Each Variety of Breed.....	Purple & Gold Ribbon		
Best of Opposite Sex to Best of Breed and Best of Variety of Breed.....	Red & White Ribbon		
Best NOHS in Breed (not offered Sunday).....	Maroon Ribbon		

The Ribbon Prizes in all Non-Regular Classes will be as follows:

First Prize.....	Rose Ribbon	Second Prize.....	Brown Ribbon
Third Prize.....	Light Green Ribbon	Fourth Prize.....	Gray Ribbon
Miscellaneous Best of Breed.....	Orange Ribbon	Miscellaneous Best Opposite.....	Lavender Ribbon
Best Miscellaneous.....	Pink & Green Ribbon		
Best Junior Handler.....	Rose & Green Rosette	Reserve Jr. Handler.....	Rose & Gray Rosette

VARIETY GROUPS

First Prize.....	Blue Rosette	Second Prize.....	Red Rosette
Third Prize.....	Yellow Rosette	Fourth Prize.....	White Rosette
Best in Show.....	Red, White & Blue Rosette		
Reserve Best in Show.....	Black, Irish Gold, & Cream Rosette		

NOHS VARIETY GROUP ROSETTES (Not offered Sunday)

First Prize.....	Neon Pink Rosette	Second Prize.....	Neon Green Rosette
Third Prize.....	Teal Rosette	Fourth Prize.....	Cream Rosette
Reserve Best in Show.....	Light Green Rosette	Best in Show.....	Turquoise Rosette

MOUNT OGDEN KENNEL CLUB

CONCESSIONAIRES - BOOTH RESERVATIONS

FOR ARRANGEMENTS & ASSISTANCE, PLEASE CONTACT:

Leneia Rogowski • 640 East 50 North, Hyrum UT 84319

435-770-9377 • Leneia.rogowski@comcast.net

20 ft x 20 ft.....\$20.00 per day

20 ft x 40 ft.....\$30.00 per day

Rates are for each day (Does not include overnight parking fees)

STATE OF UTAH REQUIRES: Off-Site Business License • Off-Site State Tax ID Number

ATTENTION EXHIBITORS

Please clean up after your dogs on the show grounds and at your motel site. We want to retain these facilities for future events.

Remember, all complaints regarding conduct prejudicial to the sport will be dealt with in accordance with AKC rules, by the Show Committee. This includes dogs relieving themselves on the shrubbery outside the show buildings.

SMOKING will not be permitted inside show buildings - state law, or around show rings. This will be enforced.

The Show Site & RV parking will be available to exhibitors after 2:00PM Tuesday. On Wednesday, parking will be available after 10:00AM. Dogs must be removed from the show site 1 1/2 hours after BIS on Sunday.

1. Damages caused by vehicles will be the responsibility of those persons bringing vehicles on to the show site.
2. Please be sure that all dogs have current DHL, RABIES & PARVO VACCINATIONS!
3. EXHIBITORS & AGENTS must be governed by any rules & regulations of the Cache County Fairgrounds and/or local restrictions.
4. EXHIBITORS & AGENTS will be held responsible for damages and for keeping the premises clean around their crates and set-ups & grooming spaces.
5. EXHIBITORS & AGENTS must keep dogs under control and restrained at all times.
6. EXHIBITORS & AGENTS are advised to bring adequate shade for the comfort of their dogs and themselves.
7. NO CRATES within 25 feet of the show rings (outdoors) except during breed judging & must be removed immediately following that breed. No set-ups between RV/Parking & rings & concessions & rings. Day parking exhibitors' ex-pens will be allowed in designated area only. Ex-pens for overnight parking will be in parking only. NO GROOMING ALLOWED IN BUILDING OR SHOWER FACILITY.
8. RESTROOMS will be available for the convenience of exhibitors/spectators. Any exhibitor found bathing or grooming a dog in the public restrooms WILL NOT BE ALLOWED TO EXHIBIT AND WILL BE SUBJECT TO ACTION BY THE EVENT COMMITTEE.
9. Shower facilities available for paid reserved overnight parking exhibitors only. NO DOGS ALLOWED IN SHOWER BUILDING.
10. NO OVERNIGHT PARKING allowed except in reserved parking areas (see Parking information on page 14).
11. Mount Ogden Kennel Club, Inc. and Cache County Fairgrounds assume NO LIABILITY for loss or damage to equipment, property and/or exhibitors and agents.
12. No roller blades or skateboards allowed on show grounds.
13. Bring mats or other appropriate ground cover for grooming building.
14. Utah State Law prohibits smoking in public areas. **"NO SMOKING"**
15. Speed limit of 5mph for the safety of exhibitors and public.

The Alaskan Malamute Club of America, Inc. & the Mount Ogden Kennel Club, Inc. do not agree to arbitrate claims as set forth on the Official AKC entry form for these events.

MOUNT OGDEN KENNEL CLUB

For information regarding Regulations, Entry and Eligibility
for the AKC National Owner-Handled Series

Please See www.AKC.org

(Remember to check the box near the bottom of the entry form)



THUR ♦ FRI ♦ SAT

TROPHIES - ALL DAYS

THE FOLLOWING TROPHIES ARE OFFERED FOR EACH DAY, THURSDAY-SUNDAY

BEST IN SHOW, VARIOUS GROUP & JR SHOWMANSHIP PRIZES

BEST IN SHOW: A Minky Couture blanket (compliments of Minky Couture) & A gift basket offered by Pet Wants

FIRST PLACE, EACH VARIETY & NOHS GROUP: Bucket

BEST 4-6-MONTH PUPPY IN SHOW: Paw Board offered by Pat and Morty Jenkins - Wolfmountain Alaskan Malamutes

BEST & RESERVE BEST JUNIOR HANDLER: Engraved Brush offered by Mount Ogden Kennel Club

BREED PRIZES

PORTUGUESE WATER DOGS - SATURDAY ONLY

BEST OF BREED, BEST OF WINNERS, BEST OF OPPOSITE SEX TO BEST OF BREED,

WINNERS DOG/BITCH: Crystal Items offered by Lyle Harding

THANK YOU TO ALL OUR TROPHY DONORS

Karen Park, Pat Jenkins, Cynthia Stewart, Wendy Ward, Leneia Rogowski, Sue Bell, Lanette Sorenson, Kyle Hennefer, Todd Thornton and Lydia Hovanski

PEE WEE CLASS SPECIAL ATTRACTION

SATURDAY AT NOON - AGES 5-9 - ENTRY FEE: \$5.00

The Pee Wee Special Attraction is a pre-Junior Showmanship class that is geared toward children 5-9 years of age. Safety is a primary concern.

JUDGE: GAYLE M DENMAN

Each Pee Wee unit consists of the child, his/her parent/guardian/responsible adult, and the dog. Only one Pee Wee unit is in the ring at a time. This is not a competitive class, but rather a fun, learning experience for the child and the adult.

- A dog must be at least four months of age to enter the Pee Wee class.
- Bitches in season will not be allowed to participate. If pre-entered, a dog may be substituted that meets the eligibility requirements as specified by the club.
- All dogs entered must have the proper lead and collar.
- A responsible adult must be present with the child both inside and outside the ring. The adult is to maintain control of the dog outside of the ring.

The safety of both the dogs and Juniors inside and outside the ring is a primary concern. Outside of the ring, the dog is to be controlled by the adult accompanying the child. An additional lead, provided by the Club, will be at the Judge's table. At the Judge's discretion based upon the size of the child and the dog, for safety purposes the adult may be asked to attach a second lead to the dog so both child and adult will walk the dog together.

REGISTRATION WILL BE TAKEN AT THE CLUB TABLE ENTRIES WILL BE TAKEN UP UNTIL AN HOUR BEFORE THE EVENT. EACH ENTRANT WILL BE REQUIRED TO FILL OUT AN ENTRY FORM. IN ADDITION TO AN ENTRY, A RELEASE MUST BE SIGNED BY THE CHILD'S PARENT OR LEGAL GUARDIAN. SEE JUDGING SCHEDULE FOR TIME.

PeeWee Entries are open to All Breeds, including Miscellaneous and FSS Breeds, and All-American Dogs listed in the AKC Canine Partners Program.

MOUNT OGDEN KENNEL CLUB, INC.

JUNIOR SHOWMANSHIP COMPETITION

NOVICE CLASS: For boys and girls who are at least 9 years old and under 18 years old on the day of the show and who at the time entries close have not won three (3) first place awards, with competition present, in a Novice Class. A first place in Novice without competition leading to a Best Junior award with competition would count as one win towards moving to Open at a licensed or member show.

OPEN CLASS: For boys and girls who are at least 9 years old and under 18 years old on the day of the show, and who have won three first place awards in a Novice Class or if a win in Novice leads to a Best Junior with competition present it will count as one win towards moving to Open in a licensed or member show. Juniors which according to their records have completed the requirements to compete in the Open class but whose status is unconfirmed by the American Kennel Club are limited to competing in the Open Class for a period of 90 days from the date of the show where the Junior completed the requirements according to their records.

MASTER CLASS: This class will be for boys and girls who are at least 9 years old and under 18 years on the day of the show, and who have 10 Best Junior wins with competition. The calendar for this class will be consistent with the eligibility dates for the AKC National Championship. All Juniors meeting the criteria for this class are required to enter the Master Class and may change their entry the day of the show if entries have already closed. Once the eligibility time frame for that year has passed all participants return to the Open Class to compete for the following year.

NOVICE AND OPEN CLASS DIVIDED: Junior-9 years old and under 12 years old on the day of the show; Intermediate-12 years old and under 15 years old on the day of the show; Senior-15 years old and under 18 years old on the day of the show.

RESERVE JUNIOR HANDLER: After the judge has awarded the Best Junior Handler, the second place winner from the class that the Junior was awarded Best Junior Handler is to return to the ring to compete for Reserve Best Junior Handler.

NOTICE: Junior Handlers must include their AKC JUNIOR HANDLER NUMBER on each entry. You may obtain your junior identification number by calling the AKC, Judges Education Department, 919-233-9767. BE SURE ALL INFORMATION for Junior Showmanship Classes is entered on front and back of entry form.

NOTE: SUBSTITUTION OF DOG IN JUNIOR SHOWMANSHIP AT THE SHOW(S): There will be an Administration Fee of \$5.00 charged for any substitution of dog in Junior Showmanship at each show. In addition, if the dog originally entered in Jr. Showmanship was an additional entry, and the dog being substituted is not otherwise entered in the show, the Junior Showmanship Only fee applies.

JUNIOR "BEST OF THE BEST"

Junior Handling competition "The Best of the Best"

restricted to the winners of all specialties and MOKC Junior Handling competition from May 15, 2024 thru May 19, 2024. This competition will be held on Sunday at lunchtime. The winner will be awarded a \$500 scholarship offered by Mount Ogden Kennel Club, to be used at the school of their choice when they enter either a college, trade school, or specialty school. Each will be given a ticket to verify their entrance into the competition. If the junior does not use this scholarship within 5 years of graduation from high school or equivalent education, then the money reverts back to the account of mount Ogden Kennel Club

MOUNT OGDEN KENNEL CLUB, INC.

AKC SANCTIONED 4-6 MONTHS PUPPY

The Four-to-Six Month Puppy competition shall be for dogs that are four months of age and over but under six months on the day of the event. Classes will be offered for breeds and varieties and divided into Groups as described in Chapter 3, Section 1 of the Rules Applying to Dog Shows and the Miscellaneous Class breeds as listed in Chapter 3, Section 23. The Miscellaneous class competition will be the equivalent of Group competition and the winner will be eligible to compete in Best Four-to-Six Month Puppy in Show. The FSS competition will be the equivalent of Group competition and the winner will be eligible to compete in Best Four-to-Six Month Puppy in Show.

Entry and Eligibility

Entry and eligibility requirements include:

- AKC registration number or an AKC litter number will be required for entries of an AKC recognized breed as listed in Chapter 3, Section 1 of the Rules Applying to Dog Shows.
- A foreign born dog may enter this class if it is registered in the country of origin.
- FSS number or FSS registered litter number will be required for Miscellaneous and FSS breed entries.
- All entrants are to be vaccinated (including rabies) in accordance with their veterinarian's protocol.
- Dogs that are owned or co-owned by a professional handler may compete in this class, but must be handled by a non-professional handler. Professional handlers are defined as any person who belongs or has belonged to a professional handlers' organization, distributed rate cards, or otherwise advertised or represented themselves as handling dogs for pay within the last five years. Dogs may not be exhibited by current assistants or household members of a professional handler. A current assistant is defined as anyone employed by a professional handler on a full-time basis, or, assisting a professional handler at the show or any show during the cluster/weekend. Minors (under 18) with amateur status who reside with professional handlers and current assistants to professional handlers that are eligible to compete in Junior Showmanship (meet age and amateur status requirements) may personally exhibit dogs in the Four-to-Six Month (Beginner Puppy) Competition.

The Club may limit the Beginner Puppy judge to 20. If this occurs, an additional judge will be named on the Judging Program.

NO PUPPIES UNDER THE AGE OF SIX (6) MONTHS,
EXCEPT THOSE PARTICIPATING IN THE 4-6 MONTH PUPPY COMPETITION,
MAY BE ON THE GROUNDS.

CLASSIFICATION – CLASSES COMBINED
Puppy, 4 & Under 6 months

RIBBON PRIZES

Best of Breed/Variety	Orange Ribbon
Best of Opposite Sex to Best of Breed/Variety.....	Lavender Ribbon
GROUP ONE..... Rose Ribbon	GROUP TWO..... Brown Ribbon
GROUP THREE..... Light Green Ribbon	GROUP FOUR..... Gray Ribbon
Best 4 & Under 6 Months Puppy in Show.....	Pink & Green Rosette

ENTRIES WILL BE TAKEN THROUGH BARAY EVENTS

MOUNT OGDEN KENNEL CLUB, INC.

BEST IN SHOW & VARIETY GROUPS

	THURSDAY	FRIDAY	SATURDAY	SUNDAY
Best In Show	C R Flaquer Rocha	Helene Nietsch	E Sangkunakup	Nathaniel Horn
Sporting Group	Helene Nietsch	C R Flaquer Rocha	Nathaniel Horn	E Sangkunakup
Hound Group	E Sangkunakup	Helene Nietsch	Nathaniel Horn	C R Flaquer Rocha
Working Group	Darryl Vice	C R Flaquer Rocha	Tracy Powell	E Sangkunakup
Terrier Group	C R Flaquer Rocha	E Sangkunakup	Nancy Lovelady	Darryl Vice
Toy Group	Nathaniel Horn	C R Flaquer Rocha	Judi Bendt	E Sangkunakup
Non-Sporting Group	Judi Bendt	Darryl Vice	C R Flaquer Rocha	Helene Nietsch
Herding Group	Nathaniel Horn	E Sangkunakup	Judi Bendt	C R Flaquer Rocha
Miscellaneous	Judi Bendt	Nathaniel Horn	C R Flaquer Rocha	Darryl Vice
NOHS Best In Show	Nathaniel Horn	Judi Bendt	Tracy Powell	<i>Not Offered</i>
NOHS Sporting Group	S M Cabral	Darryl Vice	Helene Nietsch	<i>Not Offered</i>
NOHS Hound Group	S M Cabral	C R Flaquer Rocha	Nancy Lovelady	<i>Not Offered</i>
NOHS Working Group	Kim Griffith	Nathaniel Horn	Darryl Vice	<i>Not Offered</i>
NOHS Terrier Group	S M Cabral	Judi Bendt	C R Flaquer Rocha	<i>Not Offered</i>
NOHS Toy Group	C R Flaquer Rocha	Judi Bendt	E Sangkunakup	<i>Not Offered</i>
NOHS Non-Sporting Group	C R Flaquer Rocha	Helene Nietsch	Darryl Vice	<i>Not Offered</i>
NOHS Herding Group	Kim Griffith	Judi Bendt	C R Flaquer Rocha	<i>Not Offered</i>

BREED ASSIGNMENTS

	THURSDAY	FRIDAY	SATURDAY	SUNDAY
Barbet	Helene Nietsch	C R Flaquer Rocha	Nathaniel Horn	E Sangkunakup
Bracco Italiano	Helene Nietsch	C R Flaquer Rocha	Nathaniel Horn	E Sangkunakup
Brittany	Kim Griffith*	C R Flaquer Rocha	Nathaniel Horn	E Sangkunakup
Lagotto Romagnolo	Helene Nietsch	C R Flaquer Rocha	Nathaniel Horn	E Sangkunakup
Nederlandse Kooikerhondje	Helene Nietsch	C R Flaquer Rocha	Nathaniel Horn	E Sangkunakup
Pointer	Helene Nietsch	C R Flaquer Rocha	Nathaniel Horn	E Sangkunakup
German Shorthaired Pointer	Helene Nietsch	C R Flaquer Rocha	Nathaniel Horn	E Sangkunakup
German Wirehaired Pointer	Helene Nietsch	C R Flaquer Rocha	Nathaniel Horn	E Sangkunakup
Chesapeake Bay Retriever	Helene Nietsch	Judi Bendt	Nathaniel Horn	E Sangkunakup
Curly-Coated Retriever	Helene Nietsch	C R Flaquer Rocha	Nathaniel Horn	E Sangkunakup
Flat-Coated Retriever	Kim Griffith*	C R Flaquer Rocha	Nathaniel Horn	E Sangkunakup
Golden Retriever	Kim Griffith*	C R Flaquer Rocha	Darryl Vice	E Sangkunakup
Labrador Retriever	Helene Nietsch	C R Flaquer Rocha	Nathaniel Horn	E Sangkunakup
Nova Scotia Duck Tolling Ret.	Helene Nietsch	C R Flaquer Rocha	Nathaniel Horn	E Sangkunakup
English Setter	Helene Nietsch	C R Flaquer Rocha	Nathaniel Horn	E Sangkunakup
Gordon Setter	Helene Nietsch	C R Flaquer Rocha	Nathaniel Horn	E Sangkunakup
Irish Setter	Helene Nietsch	C R Flaquer Rocha	Nathaniel Horn	E Sangkunakup
Irish Red and White Setter	Helene Nietsch	C R Flaquer Rocha	Nathaniel Horn	E Sangkunakup
American Water Spaniel	Helene Nietsch	C R Flaquer Rocha	Nathaniel Horn	E Sangkunakup
Boykin Spaniel	Helene Nietsch	C R Flaquer Rocha	Nathaniel Horn	E Sangkunakup
Clumber Spaniel	Kim Griffith*	C R Flaquer Rocha	Nathaniel Horn	E Sangkunakup
Cocker Spaniel Black	Helene Nietsch	C R Flaquer Rocha	Nathaniel Horn	E Sangkunakup
Cocker Spaniel ASCOB	Helene Nietsch	C R Flaquer Rocha	Nathaniel Horn	E Sangkunakup
Cocker Spaniel Parti	Helene Nietsch	C R Flaquer Rocha	Nathaniel Horn	E Sangkunakup
English Cocker Spaniel	Helene Nietsch	C R Flaquer Rocha	Nathaniel Horn	E Sangkunakup
English Springer Spaniel	Helene Nietsch	C R Flaquer Rocha	Nathaniel Horn	E Sangkunakup
Field Spaniel	Helene Nietsch	C R Flaquer Rocha	Nathaniel Horn	E Sangkunakup
Irish Water Spaniel	Helene Nietsch	C R Flaquer Rocha	Nathaniel Horn	E Sangkunakup
Sussex Spaniel	Helene Nietsch	C R Flaquer Rocha	Nathaniel Horn	E Sangkunakup
Welsh Springer Spaniel	Helene Nietsch	C R Flaquer Rocha	Nathaniel Horn	E Sangkunakup
Spinone Italiano	Helene Nietsch	C R Flaquer Rocha	Nathaniel Horn	E Sangkunakup
Vizsla	S M Cabral*	C R Flaquer Rocha	Nathaniel Horn	E Sangkunakup
Weimaraner	Helene Nietsch	C R Flaquer Rocha	Nathaniel Horn	E Sangkunakup
Wirehaired Pointing Griffon	Helene Nietsch	C R Flaquer Rocha	Nathaniel Horn	E Sangkunakup
Wirehaired Vizsla	Helene Nietsch	C R Flaquer Rocha	Nathaniel Horn	E Sangkunakup

*Provisional/Permit

MOUNT OGDEN KENNEL CLUB, INC.

HOUND BREEDS	THURSDAY	FRIDAY	SATURDAY	SUNDAY
Afghan Hound	E Sangkunakup	C R Flaquer Rocha	Tracy Powell*	Nathaniel Horn
American English Coonhound	E Sangkunakup	C R Flaquer Rocha	Helene Nietsch	Nathaniel Horn
American Foxhound	E Sangkunakup	C R Flaquer Rocha	Helene Nietsch	Nathaniel Horn
Azawakh	E Sangkunakup	C R Flaquer Rocha	Tracy Powell*	Nathaniel Horn
Basenji	E Sangkunakup	C R Flaquer Rocha	Helene Nietsch	Nathaniel Horn
Basset Hound	E Sangkunakup	C R Flaquer Rocha	Helene Nietsch	Nathaniel Horn
Beagle (13 in. and under)	S M Cabral*	C R Flaquer Rocha	Darryl Vice	Nathaniel Horn
Beagle (over 13 in.)	S M Cabral*	C R Flaquer Rocha	Darryl Vice	Nathaniel Horn
Black and Tan Coonhound	E Sangkunakup	C R Flaquer Rocha	Tracy Powell*	Nathaniel Horn
Bloodhound	S M Cabral*	C R Flaquer Rocha	Helene Nietsch	Nathaniel Horn
Bluetick Coonhound	E Sangkunakup	C R Flaquer Rocha	Tracy Powell*	Nathaniel Horn
Borzoi	E Sangkunakup	Judi Bendt	Helene Nietsch	Nathaniel Horn
Cirneco dell'Etna	E Sangkunakup	C R Flaquer Rocha	Helene Nietsch	Nathaniel Horn
Dachshund (Longhaired)	E Sangkunakup	Judi Bendt	Tracy Powell*	Nathaniel Horn
Dachshund (Smooth)	E Sangkunakup	Judi Bendt	Helene Nietsch	Nathaniel Horn
Dachshund (Wirehaired)	E Sangkunakup	Judi Bendt	Tracy Powell*	Nathaniel Horn
English Foxhound	E Sangkunakup	C R Flaquer Rocha	Helene Nietsch	Nathaniel Horn
Grand Basset Griffon Vendeen	E Sangkunakup	C R Flaquer Rocha	Helene Nietsch	Nathaniel Horn
Greyhound	E Sangkunakup	C R Flaquer Rocha	Helene Nietsch	Nathaniel Horn
Harrier	E Sangkunakup	C R Flaquer Rocha	Helene Nietsch	Nathaniel Horn
Ibizan Hound	E Sangkunakup	C R Flaquer Rocha	Helene Nietsch	Nathaniel Horn
Irish Wolfhound	E Sangkunakup	C R Flaquer Rocha	Helene Nietsch	Nathaniel Horn
Norwegian Elkhound	E Sangkunakup	C R Flaquer Rocha	Helene Nietsch	Nathaniel Horn
Otterhound	E Sangkunakup	C R Flaquer Rocha	Tracy Powell*	Nathaniel Horn
Petit Basset Griffon Vendeen	E Sangkunakup	C R Flaquer Rocha	Helene Nietsch	Nathaniel Horn
Pharaoh Hound	E Sangkunakup	C R Flaquer Rocha	Helene Nietsch	Nathaniel Horn
Plott Hound	E Sangkunakup	C R Flaquer Rocha	Helene Nietsch	Nathaniel Horn
Portuguese Podengo Pequeno	E Sangkunakup	C R Flaquer Rocha	Tracy Powell*	Nathaniel Horn
Redbone Coonhound	E Sangkunakup	C R Flaquer Rocha	Helene Nietsch	Nathaniel Horn
Rhodesian Ridgeback	E Sangkunakup	C R Flaquer Rocha	Helene Nietsch	Nathaniel Horn
Saluki	E Sangkunakup	C R Flaquer Rocha	Helene Nietsch	Nathaniel Horn
Scottish Deerhound	E Sangkunakup	C R Flaquer Rocha	Helene Nietsch	Nathaniel Horn
Sloughi	E Sangkunakup	C R Flaquer Rocha	Helene Nietsch	Nathaniel Horn
Treeing Walker Coonhound	E Sangkunakup	C R Flaquer Rocha	Tracy Powell*	Nathaniel Horn
Whippet	E Sangkunakup	C R Flaquer Rocha	Darryl Vice	Nathaniel Horn
WORKING BREEDS	THURSDAY	FRIDAY	SATURDAY	SUNDAY
Akita	Darryl Vice	Helene Nietsch	Tracy Powell	E Sangkunakup
Alaskan Malamute	Darryl Vice	Helene Nietsch	Tracy Powell*	E Sangkunakup
Anatolian Shepherd Dog	Darryl Vice	Helene Nietsch	Tracy Powell	E Sangkunakup
Bernese Mountain Dog	Darryl Vice	Helene Nietsch	Tracy Powell	E Sangkunakup
Black Russian Terrier	Darryl Vice	Helene Nietsch	Tracy Powell	E Sangkunakup
Boerboel	Darryl Vice	Helene Nietsch	Tracy Powell	E Sangkunakup
Boxer	Darryl Vice	Helene Nietsch	Tracy Powell	E Sangkunakup
Bullmastiff	Kim Griffith*	Helene Nietsch	Tracy Powell	Darryl Vice
Cane Corso	Darryl Vice	Helene Nietsch	Tracy Powell	E Sangkunakup
Chinook	Darryl Vice	Helene Nietsch	Tracy Powell	E Sangkunakup
Doberman Pinscher	Darryl Vice	Helene Nietsch	Tracy Powell	E Sangkunakup
Dogo Argentino	Darryl Vice	Helene Nietsch	Tracy Powell	E Sangkunakup
Dogue de Bordeaux	Darryl Vice	Helene Nietsch	Tracy Powell	E Sangkunakup
German Pinscher	Darryl Vice	Helene Nietsch	Tracy Powell	E Sangkunakup
Giant Schnauzer	Darryl Vice	Helene Nietsch	Tracy Powell	E Sangkunakup
Great Dane	Darryl Vice	Helene Nietsch	Tracy Powell	E Sangkunakup
Great Pyrenees	Kim Griffith*	Helene Nietsch	Tracy Powell	Darryl Vice
Greater Swiss Mountain Dog	S M Cabral*	Helene Nietsch	Tracy Powell	Darryl Vice
Komondor	Darryl Vice	Helene Nietsch	Tracy Powell	E Sangkunakup
Kuvasz	Darryl Vice	Helene Nietsch	Tracy Powell	E Sangkunakup

MOUNT OGDEN KENNEL CLUB, INC.

Leonberger	Darryl Vice	Helene Nietsch	Tracy Powell	E Sangkunakup
Mastiff	Darryl Vice	Helene Nietsch	Tracy Powell	E Sangkunakup
Neapolitan Mastiff	Darryl Vice	Helene Nietsch	Tracy Powell	E Sangkunakup
Newfoundland	Kim Griffith*	Helene Nietsch	Tracy Powell	Darryl Vice
Portuguese Water Dog	S M Cabral*	Helene Nietsch	Tracy Powell	Darryl Vice
Rottweiler	Darryl Vice	Helene Nietsch	Tracy Powell	E Sangkunakup
St. Bernard	Darryl Vice	Helene Nietsch	Tracy Powell*	E Sangkunakup
Samoyed	Darryl Vice	Helene Nietsch	Tracy Powell	E Sangkunakup
Siberian Husky	S M Cabral*	Helene Nietsch	Tracy Powell	Darryl Vice
Standard Schnauzer	Darryl Vice	Helene Nietsch	Tracy Powell	E Sangkunakup
Tibetan Mastiff	Darryl Vice	Helene Nietsch	Tracy Powell	E Sangkunakup
TERRIER BREEDS	THURSDAY	FRIDAY	SATURDAY	SUNDAY
Airedale Terrier	E Sangkunakup	Darryl Vice	Nancy Lovelady	C R Flaquer Rocha
American Hairless Terrier	E Sangkunakup	Darryl Vice	Nancy Lovelady	C R Flaquer Rocha
American Staffordshire Terrier	S M Cabral*	Darryl Vice	Nancy Lovelady	C R Flaquer Rocha
Australian Terrier	E Sangkunakup	Darryl Vice	Nancy Lovelady	C R Flaquer Rocha
Bedlington Terrier	E Sangkunakup	Darryl Vice	Nancy Lovelady	C R Flaquer Rocha
Border Terrier	E Sangkunakup	Darryl Vice	Nancy Lovelady	C R Flaquer Rocha
Colored Bull Terrier	E Sangkunakup	Darryl Vice	Nancy Lovelady	C R Flaquer Rocha
White Bull Terrier	E Sangkunakup	Darryl Vice	Nancy Lovelady	C R Flaquer Rocha
Cairn Terrier	E Sangkunakup	Darryl Vice	Nancy Lovelady	C R Flaquer Rocha
Cesky Terrier	E Sangkunakup	Darryl Vice	Nancy Lovelady	C R Flaquer Rocha
Dandie Dinmont Terrier	E Sangkunakup	Darryl Vice	Nancy Lovelady	C R Flaquer Rocha
Smooth Fox Terrier	E Sangkunakup	Darryl Vice	Nancy Lovelady	C R Flaquer Rocha
Wire Fox Terrier	E Sangkunakup	Darryl Vice	Nancy Lovelady	C R Flaquer Rocha
Glen of Imaal Terrier	E Sangkunakup	Darryl Vice	Nancy Lovelady	C R Flaquer Rocha
Irish Terrier	E Sangkunakup	Darryl Vice	Nancy Lovelady	C R Flaquer Rocha
Kerry Blue Terrier	E Sangkunakup	Darryl Vice	Nancy Lovelady	C R Flaquer Rocha
Lakeland Terrier	E Sangkunakup	Darryl Vice	Nancy Lovelady	C R Flaquer Rocha
Standard Manchester Terrier	E Sangkunakup	Darryl Vice	Nancy Lovelady	C R Flaquer Rocha
Miniature Bull Terrier	E Sangkunakup	Darryl Vice	Nancy Lovelady	C R Flaquer Rocha
Miniature Schnauzer	E Sangkunakup	Darryl Vice	Nancy Lovelady	C R Flaquer Rocha
Norfolk Terrier	E Sangkunakup	Darryl Vice	Nancy Lovelady	C R Flaquer Rocha
Norwich Terrier	E Sangkunakup	Darryl Vice	Nancy Lovelady	C R Flaquer Rocha
Parson Russell Terrier	E Sangkunakup	Darryl Vice	Nancy Lovelady	C R Flaquer Rocha
Rat Terrier	E Sangkunakup	Darryl Vice	Nancy Lovelady	C R Flaquer Rocha
Russell Terrier	E Sangkunakup	Darryl Vice	Nancy Lovelady	C R Flaquer Rocha
Scottish Terrier	E Sangkunakup	Darryl Vice	Nancy Lovelady	C R Flaquer Rocha
Sealyham Terrier	E Sangkunakup	Darryl Vice	Nancy Lovelady	C R Flaquer Rocha
Skye Terrier	E Sangkunakup	Darryl Vice	Nancy Lovelady	C R Flaquer Rocha
Soft Coated Wheaten Terrier	E Sangkunakup	Darryl Vice	Nancy Lovelady	C R Flaquer Rocha
Staffordshire Bull Terrier	E Sangkunakup	Darryl Vice	Nancy Lovelady	C R Flaquer Rocha
Welsh Terrier	E Sangkunakup	Darryl Vice	Nancy Lovelady	C R Flaquer Rocha
West Highland White Terrier	E Sangkunakup	Darryl Vice	Nancy Lovelady	C R Flaquer Rocha
TOY BREEDS	THURSDAY	FRIDAY	SATURDAY	SUNDAY
Affenpinscher	C R Flaquer Rocha	Nathaniel Horn	E Sangkunakup	Judi Bendt
Biewer Terrier	C R Flaquer Rocha	Nathaniel Horn	E Sangkunakup	Judi Bendt
Brussels Griffon	C R Flaquer Rocha	Nathaniel Horn	E Sangkunakup	Judi Bendt
Cavalier King Charles Spaniel	C R Flaquer Rocha	Nathaniel Horn	E Sangkunakup	Helene Nietsch*
Long Coat Chihuahua	C R Flaquer Rocha	Nathaniel Horn	E Sangkunakup	Judi Bendt
Smooth Coat Chihuahua	C R Flaquer Rocha	Nathaniel Horn	E Sangkunakup	Judi Bendt
Chinese Crested	C R Flaquer Rocha	Nathaniel Horn	E Sangkunakup	Judi Bendt
English Toy Spaniel - BL&PC	C R Flaquer Rocha	Nathaniel Horn	E Sangkunakup	Judi Bendt
English Toy Spaniel - KC&R	C R Flaquer Rocha	Nathaniel Horn	E Sangkunakup	Judi Bendt
Havanese	C R Flaquer Rocha	Nathaniel Horn	E Sangkunakup	Judi Bendt
Italian Greyhound	C R Flaquer Rocha	Nathaniel Horn	E Sangkunakup	Judi Bendt
Japanese Chin	C R Flaquer Rocha	Nathaniel Horn	Darryl Vice	Judi Bendt

*Provisional/Permit

MAY 2024 • MOUNT OGDEN CLUSTER • 11

MOUNT OGDEN KENNEL CLUB, INC.

Maltese	C R Flaquer Rocha	Nathaniel Horn	E Sangkunakup	Judi Bendt
Toy Manchester Terrier	C R Flaquer Rocha	Nathaniel Horn	E Sangkunakup	Judi Bendt
Miniature Pinscher	C R Flaquer Rocha	Nathaniel Horn	E Sangkunakup	Judi Bendt
Papillon	C R Flaquer Rocha	Nathaniel Horn	E Sangkunakup	Judi Bendt
Pekingese	C R Flaquer Rocha	Nathaniel Horn	E Sangkunakup	Judi Bendt
Pomeranian	C R Flaquer Rocha	Nathaniel Horn	E Sangkunakup	Judi Bendt
Toy Poodle	C R Flaquer Rocha	Nathaniel Horn	E Sangkunakup	Helene Nietsch
Pug	C R Flaquer Rocha	Nathaniel Horn	E Sangkunakup	Helene Nietsch*
Russian Toy	C R Flaquer Rocha	Nathaniel Horn	E Sangkunakup	Judi Bendt
Shih Tzu	C R Flaquer Rocha	Nathaniel Horn	E Sangkunakup	Judi Bendt
Silky Terrier	C R Flaquer Rocha	Nathaniel Horn	E Sangkunakup	Judi Bendt
Toy Fox Terrier	C R Flaquer Rocha	Nathaniel Horn	E Sangkunakup	Judi Bendt
Yorkshire Terrier	C R Flaquer Rocha	Nathaniel Horn	E Sangkunakup	Judi Bendt
NON-SPORTING BREEDS	THURSDAY	FRIDAY	SATURDAY	SUNDAY
American Eskimo Dog	Judi Bendt	Darryl Vice	C R Flaquer Rocha	Helene Nietsch
Bichon Frise	Judi Bendt	Darryl Vice	C R Flaquer Rocha	Helene Nietsch
Boston Terrier	Judi Bendt	Darryl Vice	C R Flaquer Rocha	Helene Nietsch
Bulldog	Judi Bendt	Darryl Vice	C R Flaquer Rocha	Helene Nietsch
Chinese Shar-Pei	Judi Bendt	Darryl Vice	C R Flaquer Rocha	Helene Nietsch
Chow Chow	Judi Bendt	Darryl Vice	C R Flaquer Rocha	Helene Nietsch
Coton de Tulear	Judi Bendt	Darryl Vice	C R Flaquer Rocha	Helene Nietsch
Dalmatian	S M Cabral*	Darryl Vice	C R Flaquer Rocha	Helene Nietsch
Finnish Spitz	Judi Bendt	Darryl Vice	C R Flaquer Rocha	Helene Nietsch
French Bulldog	Judi Bendt	Darryl Vice	C R Flaquer Rocha	Helene Nietsch
Keeshond	Judi Bendt	Darryl Vice	C R Flaquer Rocha	Helene Nietsch
Lhasa Apso	Judi Bendt	Darryl Vice	C R Flaquer Rocha	Helene Nietsch
Lowchen	Judi Bendt	Darryl Vice	C R Flaquer Rocha	Helene Nietsch
Norwegian Lundehund	Judi Bendt	Darryl Vice	C R Flaquer Rocha	Helene Nietsch
Miniature Poodle	Judi Bendt	Darryl Vice	C R Flaquer Rocha	Helene Nietsch
Standard Poodle	Judi Bendt	Darryl Vice	C R Flaquer Rocha	Helene Nietsch
Schipperke	Judi Bendt	Darryl Vice	C R Flaquer Rocha	Helene Nietsch
Shiba Inu	Judi Bendt	Darryl Vice	C R Flaquer Rocha	Helene Nietsch
Tibetan Spaniel	Judi Bendt	Darryl Vice	C R Flaquer Rocha	Helene Nietsch
Tibetan Terrier	Judi Bendt	Darryl Vice	C R Flaquer Rocha	Helene Nietsch
Xoloitzcuintli	Judi Bendt	Darryl Vice	C R Flaquer Rocha	Helene Nietsch
HERDING BREEDS	THURSDAY	FRIDAY	SATURDAY	SUNDAY
Australian Cattle Dog	Kim Griffith*	E Sangkunakup	Judi Bendt	C R Flaquer Rocha
Australian Shepherd	Nathaniel Horn	E Sangkunakup	Judi Bendt	C R Flaquer Rocha
Bearded Collie	Nathaniel Horn	E Sangkunakup	Judi Bendt	C R Flaquer Rocha
Beauceron	Nathaniel Horn	E Sangkunakup	Judi Bendt	C R Flaquer Rocha
Belgian Laekenois	Nathaniel Horn	E Sangkunakup	Judi Bendt	Jill Warren
Belgian Malinois	Nathaniel Horn	E Sangkunakup	Judi Bendt	C R Flaquer Rocha
Belgian Sheepdog	Nathaniel Horn	E Sangkunakup	Judi Bendt	C R Flaquer Rocha
Belgian Tervuren	Nathaniel Horn	E Sangkunakup	Judi Bendt	C R Flaquer Rocha
Bergamasco Sheepdog	Nathaniel Horn	E Sangkunakup	Judi Bendt	C R Flaquer Rocha
Berger Picard	Nathaniel Horn	E Sangkunakup	Judi Bendt	C R Flaquer Rocha
Border Collie	Nathaniel Horn	E Sangkunakup	Judi Bendt	C R Flaquer Rocha
Bouvier des Flandres	Nathaniel Horn	E Sangkunakup	Judi Bendt	C R Flaquer Rocha
Briard	Nathaniel Horn	E Sangkunakup	Judi Bendt	C R Flaquer Rocha
Canaan Dog	Nathaniel Horn	E Sangkunakup	Judi Bendt	Jill Warren
Cardigan Welsh Corgi	Nathaniel Horn	E Sangkunakup	Judi Bendt	C R Flaquer Rocha
Rough Collie	Nathaniel Horn	E Sangkunakup	Judi Bendt	C R Flaquer Rocha
Smooth Collie	Nathaniel Horn	E Sangkunakup	Judi Bendt	C R Flaquer Rocha
Entlebucher Mountain Dog	Nathaniel Horn	E Sangkunakup	Judi Bendt	Jill Warren
Finnish Lapphund	Nathaniel Horn	E Sangkunakup	Judi Bendt	Jill Warren*
German Shepherd Dog	Nathaniel Horn	E Sangkunakup	Judi Bendt	C R Flaquer Rocha

MOUNT OGDEN KENNEL CLUB, INC.

Icelandic Sheepdog	Nathaniel Horn	E Sangkunakup	Judi Bendt	Jill Warren*
Lancashire Heeler	Nathaniel Horn	E Sangkunakup	Judi Bendt	Jill Warren*
Miniature American Shepherd	Nathaniel Horn	E Sangkunakup	Judi Bendt	Jill Warren
Mudi	Nathaniel Horn	E Sangkunakup	Judi Bendt	Jill Warren
Norwegian Buhund	Nathaniel Horn	E Sangkunakup	Judi Bendt	C R Flaquer Rocha
Old English Sheepdog	Nathaniel Horn	E Sangkunakup	Judi Bendt	C R Flaquer Rocha
Pembroke Welsh Corgi	Nathaniel Horn	E Sangkunakup	Judi Bendt	C R Flaquer Rocha
Polish Lowland Sheepdog	Nathaniel Horn	E Sangkunakup	Judi Bendt	Jill Warren*
Puli	Nathaniel Horn	E Sangkunakup	Judi Bendt	C R Flaquer Rocha
Pumi	Nathaniel Horn	E Sangkunakup	Judi Bendt	Jill Warren
Pyrenean Shepherd	Nathaniel Horn	E Sangkunakup	Judi Bendt	Jill Warren*
Shetland Sheepdog	Nathaniel Horn	E Sangkunakup	Judi Bendt	C R Flaquer Rocha
Spanish Water Dog	Nathaniel Horn	E Sangkunakup	Judi Bendt	Jill Warren
Swedish Vallhund	Nathaniel Horn	E Sangkunakup	Judi Bendt	Jill Warren
Miscellaneous	THURSDAY	FRIDAY	SATURDAY	SUNDAY
Basset Fauve de Bretagne	Judi Bendt	Nathaniel Horn	C R Flaquer Rocha	Darryl Vice
Danish-Swedish Farmdog	Judi Bendt	Nathaniel Horn	C R Flaquer Rocha	Darryl Vice
Dutch Shepherd	Judi Bendt	Nathaniel Horn	C R Flaquer Rocha	Darryl Vice
Japanese Akitainu	Judi Bendt	Nathaniel Horn	C R Flaquer Rocha	Darryl Vice
Kai Ken	Judi Bendt	Nathaniel Horn	C R Flaquer Rocha	Darryl Vice
Norrbottenspets	Judi Bendt	Nathaniel Horn	C R Flaquer Rocha	Darryl Vice
Peruvian Inca Orchid	Judi Bendt	Nathaniel Horn	C R Flaquer Rocha	Darryl Vice
Portuguese Podengo	Judi Bendt	Nathaniel Horn	C R Flaquer Rocha	Darryl Vice
Russian Tsvetnaya Bolonka	Judi Bendt	Nathaniel Horn	C R Flaquer Rocha	Darryl Vice
Small Munsterlander	Judi Bendt	Nathaniel Horn	C R Flaquer Rocha	Darryl Vice
Teddy Roosevelt Terrier	Judi Bendt	Nathaniel Horn	C R Flaquer Rocha	Darryl Vice
Junior Showmanship	S M Cabral	Judi Bendt	Tracy Powell	Jill Warren
Beginner Puppy 4-6 Months	S M Cabral	Judi Bendt	Helene Nietsch	Judi Bendt
FSS Show	Kim Griffith	Helene Nietsch	Nancy Lovelady	Jill Warren

USE OF RAMPS - ALL BREEDS

The following breeds **must be judged on a ramp** through all levels of conformation competition: Lagotto Romagnolo, Clumber Spaniels, Sussex Spaniels, Basset Hounds, Cirneco dell'Etnas, Kerry Blue Terriers, Bulldogs, Chinese Shar-Pei, Chow Chows and Keeshonden. Breeds designated as ramp optional may, at the discretion of the judge, be judged on a ramp through all levels of competition. The full policy and list of Table and Ramp eligible/required breeds is available on the AKC website at: https://images.akc.org/pdf/judges/table_breeds.pdf

Ramps can be used to judge any breed in an emergency situation where use of a ramp is not indicated in the premium list; an exhibitor has the option of withdrawing their entry and receiving a refund. For the judging of juniors the ramp may be used at the discretion of the judge for the ramp optional breeds. (04/2024)

ALL EVENTS

PARKING INFORMATION - ALL EVENTS

RESERVED OVERNIGHT PARKING INFORMATION & DAY OF SHOW PARKING INFORMATION

- Parking is a privilege which can be revoked -

RV RESERVATIONS DUE: APRIL 24, 2024

NO REFUND AFTER CLOSING DATE.

- No parking in the loading & unloading zones. 20-minute time limit absolutely enforced.
- Overnight parking of self-contained vehicles will be available by reservation only. Spaces will be assigned by the date on the reservation envelope & mailed payment. Consideration will be given to returning exhibitors & same spaces previously assigned.
- Electricity might be more limited this year so if you must have electricity SEND YOUR RESERVATION IN EARLY.
- No claims against Mount Ogden Kennel Club will be honored, if parking is not in designated areas. All generators must be vented away from dogs & exhibitors (**STRICTLY ENFORCED**).
- THOSE PARKING NEAR SHOW RINGS MUST STAY UNTIL SHOWS ARE OVER! INDICATE IF THIS IS A PROBLEM.
- Limited number of electrical hookups vary as to amps. Tent camping on grass is available. Long electrical cords & adapters may be needed.
- Mandatory that generators supply power for air-conditioners & recreational vehicle furnaces.
- OVERNIGHT PARKING WILL BE AVAILABLE ON TUESDAY, May 14, 2024 AT 2:00 PM.
- On Wednesday, parking will be available after 10:00AM.
- Parking in assigned spaces only - additional vehicles with Reserved Overnight Parking must pay \$5.00 a day & fit into assigned space.
- Anyone wishing to park together must send their reservations in together. Spaces will be assigned based also on size of vehicle & existing available spaces.
- **NOTE:** SPACES are 20 feet wide by the length of the vehicle - maximum 50 feet. Any outfit over 50 feet in length will be required to unhook & reserve two spaces or if your vehicle requires more than 20 feet in width, additional spaces will be required. Roadways are considered fire lanes.
- **DAY OF SHOW PARKING - \$5.00 PER DAY, PAYABLE ON ARRIVAL TO THE SHOW GROUNDS**
- Parking may have to be altered due to weather concerns, as we will not destroy the grounds.
- PLEASE BE ADVISED THAT PER AKC REGULATIONS, NO VEHICLE TRAFFIC IS ALLOWED WITHIN 50 FEET OF THE RING DURING SHOW HOURS

OVERNIGHT PARKING RESERVATION FORM - NEXT PAGE

While Wednesday's specialty and group shows are occurring, those with RV parking adjacent to the rings will be required to wait until after the conclusion of the specialty and group shows.

ALL EVENTS

OVERNIGHT PARKING RESERVATION FORM

ANYONE WISHING TO PARK TOGETHER MUST SEND THEIR RESERVATIONS IN TOGETHER.

OVERNIGHT PARKING IS \$55.00 PER NIGHT. Additional vehicles with reserved overnight parking must pay \$5.00 a day & fit into assigned space.

OVERNIGHT PARKING AVAILABLE TUESDAY AFTER 2:00PM & WEDNESDAY AFTER 10:00AM.

Fairgrounds close at 10:00PM each evening and open again at 6:00AM.

Please note: No pull through parking is available.

Reserved parking can be cancelled with full refund up to the day of show closing. There will be NO refunds after show closes.

If parked by the rings your space will not be available until after Wednesday specialties
Parking is a privilege and can be revoked.

Name _____

Address _____

City, State, Zip _____

Phone # _____ Email _____

Please list the breeds you are bringing _____

☐ Motorhome ☐ Trailer ☐ Fifth-Wheel ☐ Other _____

Total Length of vehicle including Tow Vehicle _____ Slides _____ # Spaces Requested _____

Parking in assigned spaces only – Incorrect length will be placed in overflow parking

☐ Conformation ☐ Other

Nights Reserved: ☐ Tues. ☐ Wed. ☐ Thu. ☐ Fri. ☐ Sat. ☐ Sun. (stay w/approval from parking).

All RV spaces are considered handicap accessible.

Signature of acceptance of rules and regulations pertaining to RV Parking _____

RV Parking is \$55 per night, due by APRIL 24, 2024

Make checks payable to Mount Ogden Kennel Club.

Mail Reservations to: Pat Jenkins - PO Box 417, Richmond, UT 84333

For questions contact Todd Thornton - 801-541-8989 - utcigar@gmail.com

No dogs that are disqualified for aggression will be allowed to enter these Shows, nor be allowed to be on the grounds. In addition, no aggression reinstatement procedures will be performed at these Shows.

ALL EVENTS

RESERVED GROOMING

RESERVATIONS FOR INDOOR GROOMING INSTRUCTIONS

RESERVATIONS DUE: APRIL 24, 2024

1. One reservation of no more than two spaces per exhibitor (with no more than three reservations per envelope - for a total of six spaces)
2. Spaces may vary in size with every attempt to make them as fair as possible will be extended as a courtesy to our exhibitors- spaces normally eight feet frontage and 12 feet deep.
Reserved Grooming is \$50.00 for entire show weekend per space, no split days.
3. Grooming is in a packed dirt arena
4. **NO DRIVING INTO BUILDING ALLOWED AT ANY TIME - INCLUDING LOADING AND UNLOADING**
5. Bathing area available outside, bring your own hose if needed
6. Bring ground cover and mats. The fairgrounds does a great job of packing the arena
7. Day of show parking is not included in the cost of reserved grooming. Day of show parking is \$5 per day. Please bring exact change if possible to minimize money exchange
8. Check must accompany reservation for grooming payable to MOUNT OGDEN KENNEL CLUB (No SASE available, but may confirm receipt of form and payment via email.) Assignments will be posted on the doors of the grooming building.

Chari Erickson, Grooming Chair - PO Box 981312, Park City, UT 84098

**Questions? Text (preferred) or call Chari Erickson at 385-204-6685 or email (preferred)
alaskansnowdogs@gmail.com**

RESERVED INDOOR GROOMING FORM

Name _____

Address _____

City, State, Zip _____

Phone # _____

Email _____

SIGNATURE - INDICATES ACCEPTANCE OF SPACES ASSIGNED BY MOUNT OGDEN KENNEL CLUB
And the willingness to abide by these rules.

Vehicles that are parked illegally will be towed.
If your vehicle is towed, you will be charged for towing as well as possible impound charges.
WE MUST KEEP FIRE LANES as well as some other areas clear.
PLEASE PARK ONLY IN DESIGNATED AREA

RING STEWARDS

HALF DAY - \$25.00 lunch included

FULL DAY- \$50.00 lunch included

Parking is included for volunteers that are ring stewarding.

If you are interested in being a Ring Steward Contact: Lyle Harding

801-319-6296 or ikonkennel@aol.com

ALL EVENTS

May 17th-19th, 2024



DESERT RATS BARN HUNT CLUB OF UTAH, LLC.

Join us at the Cache County Fairgrounds for 5 sanctioned barn hunt trials!
Offering all levels (Instinct, Novice, Open, Senior, Masters) and Crazy 8s!

Trials will be indoors with two concurrently running rings.
AM and PM trials will be offered to help accommodate MOKC ringtimes.

Friday May 17th: Trial 1 (AM), Trial 2 (PM)
Saturday, May 18th: Trial 3 (AM), Trial 4 (PM)
Sunday, May 19th: Trial 5 (AM)

Registration Opens **Saturday April 6th, 2024**
and Closes **Tuesday May 7th, 2024**. The trial is
expected to fill, so get your entries in early!

For the premium and more information:
<https://desertratters.com/>

To register with the BHA and read the rules:
<https://www.barnhunt.com/>

For questions visit our Facebook page:
<https://www.facebook.com/groups/desertratsbh>

Trial Chair: Shelby Craynor ♦ 801-725-6676 ♦ Shelbycraynor@gmail.com
Trial Secretary: Cynthia Heyman ♦ 801-930-0670 ♦ secretary@pawtap.net

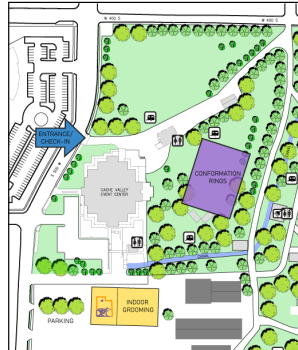

Photo Credit: Adam Dog Photography

MOKC FSS OPEN SHOWS

**MOUNT OGDEN KENNEL CLUB, INC.
FSS OPEN SHOWS**

LICENSED BY THE AMERICAN KENNEL CLUB

THUR: 2024092911-OP. FRI: 2024092912-OP. SAT: 2024092913-OP. SUN: 2024092914 -OP

MOUNT OGDEN KENNEL CLUB OFFICERS

Pat Jenkins	President	Karen Park	Vice President
Pat Jenkins	Treasurer	Leneia Rogowski.....	Rec. & Corres. Secretary
		Leneia.rogowski@comcast.net	

BOARD OF DIRECTORS

Todd Thornton • Kathryn Taylor • Kevin Taylor • Shannon Orr • Justin Scoffield

Delegate to the American Kennel Club – Karen Park

SHOW COMMITTEE

Leneia Rogowski – Show Chair

435-770-9377 • leneia.rogowski@comcast.net

Kathryn Taylor – Assistant Show Chair

Officers of the Club and Members of the Board of Directors

COMMITTEES

Jo Arave.....	Hospitality
Todd Thornton & Pat Jenkins	Grounds & Parking • PO Box 417, Richmond, UT 84333
Leneia Rogowski.....	Catalog, Advertising & Vendors
Karen Park	Health Committee
Justin & Navy Scoffield.....	Trophies
Lyle Harding	Chief Ring Steward

JUDGES

THU: Mr. Kim Griffith [99175].....	WESTMORELAND, TN
FRI: Ms. Helene Nietsch [7259].....	NEWTOWN, CT
SAT: Mrs. Nancy Lovelady [97313].....	CARSON CITY, NV
SUN: Dr. Jill Warren [94859].....	CORRALES, NM

ENTRY FEES - EACH SHOW

(Includes AKC Event Service Fee and AKC Recording Fee where applicable)

First Entry of Each Dog in Each Show	\$30.00
Each Additional Entry of Same Dog in Same Show.....	\$24.00

RIBBON PRIZES, EACH OPEN SHOW

REGULAR CLASSES

First Prize	Rose Ribbon	Second Prize	Brown Ribbon
Third Prize	Light Green Ribbon	Fourth Prize.....	Gray Ribbon
Best of Breed.....			Orange Ribbon
Best of Opposite Sex.....			Lavender Ribbon

MISCELLANEOUS GROUP & FSS GROUP

First Prize	Rose Rosette	Second Prize	Brown Rosette
Third Prize	Light Green Rosette	Fourth Prize.....	Gray Rosette
Best in Open Show			Pink & Green Rosette

MOKC FSS OPEN SHOWS

CLASSIFICATION - ALL ELIGIBLE BREEDS

Puppy Dogs, 4 mos. & under 6 mos.	Puppy Bitches, 4 mos. & under 6 mos.
Puppy Dogs, 6 mos. & under 9 mos.	Puppy Bitches, 6 mos. & under 9 mos.
Puppy Dogs, 9 mos. & under 12 mos.	Puppy Bitches, 9 mos. & under 12 mos.
Bred by Exhibitor Dogs	Bred by Exhibitor Bitches
Open Dogs	Open Bitches

**Followed by Best of Breed and Best of Opposite Sex,
Miscellaneous Group, FSS Group, Best in Open Show
DOGS ELIGIBLE TO ENTER**

WHO MAY ENTER: FSS and Miscellaneous breeds, ages 4 months and older on the day of the event are eligible to compete and earn points towards the Certificate of Merit. Miscellaneous Class breeds will be considered equivalent to a Group as will the FSS breeds. The winner of the Miscellaneous Class & FSS Groups will go on to compete for Best in FSS Open Show.

Professional handlers or agents are only permitted to exhibit in FSS Open Shows if they are listed as an owner of record of the dog being exhibited. *Professional handlers are defined as any person who belongs or has belonged to a professional handlers' organization, distributed rate cards, or otherwise advertised or represented themselves as handling dogs for pay.*

EACH OPEN SHOW WILL OFFER CLASSES FOR THE FOLLOWING.

BEST IN OPEN SHOW

MISCELLANEOUS GROUP

MISCELLANEOUS CLASSES

Basset Fauve de Bretagnes
Danish-Swedish Farmdogs
Dutch Shepherds
Kai Kens
Japanese Akitainu
Norrbotenspets
Peruvian Inca Orchids
Portuguese Podengos
Russian Tsvetnaya Bolonkas
Small Munsterlanders
Teddy Roosevelt Terriers

FOUNDATION STOCK SERVICE GROUP

Alaskan Klee Kai
American Bulldogs
American Leopard Hounds
Appenzeller Sennenhundes
Australian Kelpies
Australian Stumpy-Tail Cattle Dogs
Barbados da Terceira
Bavarian Mountain Scent Hounds
Bohemian Shepherds
Bolognese
Braque du Bourbonnais

Braque Francais Pyreneans
Braque St. Germain
Brazilian Terrier
Broholmers
Carolina Dogs
Catahoula Leopard Dogs
Caucasian Shepherd Dogs
Central Asian Shepherd Dogs
Croatian Sheepdogs
Czechoslovakian Vlcik
Deutscher Wachtelhunde
Drentsche Patrijshonden
Drevers
Estrela Mountain Dogs
Eurasiers
French Spaniels
German Longhaired Pointers
German Spitz
Hamiltonstovares
Hanoverian Scenthounds
Hokkaidos
Hovawarts
Jagdterriers
Japanese Spitzes
Japanese Terriers
Karelian Bear Dogs
Kishu Kens
Korean Jindo Dog
Kromfohrlanders
Lapponian Herders
Large Munsterlander
Mountain Curs

Porcelaines
Pont-Audemer Spaniel
Portuguese Pointers
Portuguese Sheepdogs
Presa Canario
Pudelpointers
Pyrenean Mastiffs
Rafeiro do Alentejos
Romanian Carpathian Shepherd
Dogs
Romanian Mioritic Shepherd Dogs
Schapendoes
Segugi Italiani
Shikoku
Slovakian Wirehaired Pointers
Slovensky Cuvac
Slovensky Kopovs
Spanish Mastiffs
Stabyhouns
Swedish Lapphunds
Taiwan Dogs
Thai Bangkaew
Thai Ridgebacks
Tornjaks
Tosas
Transylvanian Hounds
Treeing Tennessee Brindle
Coonhounds
Volpini Italiani
Wetterhouns
Working Kelpies
Yakutian Laikas

* Norrbottenspets may be judged on the ground or a ramp through all levels of competition.

FSS and Miscellaneous Breeds may be entered in Jr Showmanship, Obedience & Rally.

**THE MOUNT OGDEN KENNEL CLUB
WOULD LIKE TO INVITE
EVERYONE TO CELEBRATE**

ARMED FORCES DAY

**SATURDAY WE WILL BE HONORING OUR
ARMED FORCES PERSONNEL AND RETIRED MILITARY
IN HONOR OF THIS, WE INVITE YOU TO WEAR
RED, WHITE AND BLUE!!!**



HAVE FUN WITH CHUCK-A-DUCK

50/50 contest

- Ducks are \$5 each -

The winner takes home 50% of the total entry money and 50% goes to the Mount Ogden Kennel Club Junior Scholarship Fund. To be held On Saturday at noon.



ALL EVENTS

All Breed FastCAT by Scottish Deerhound Club of America May 18 & 19, 2024

Two runs each day, limited to 80 dogs per run per day.



First run 8AM- 12:30PM

Second run 1:00PM- 5:00PM

\$30 entry per dog per run

Entry information & forms
available by emailing:
SDCAFastCAT2024@outlook.com

Day of entries will be accepted
if there is still available running slots.

ROUTES TO THE SHOW

FROM NORTH OR SOUTH (Highway 89-21)

Turn west on 400 S. Go 5 blocks, turn left.

Please enter fairgrounds from west entrances

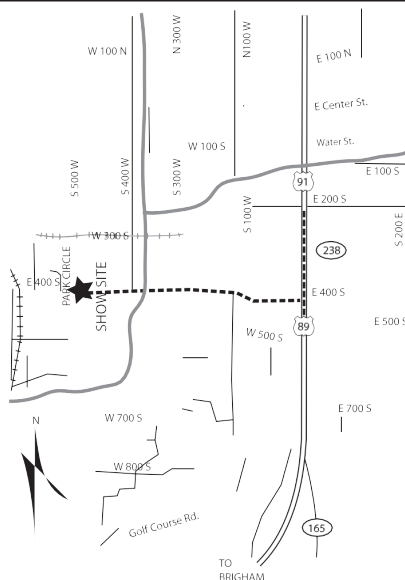



LUNCH

MOKC WOULD LIKE TO INVITE
ALL PARTICIPANTS TO ENJOY

A CATERED LUNCH

**MAY 18, 2024, SPONSORED BY
A SPECIAL FRIEND
AND SUPPORTER OF MOKC.
IT WILL BE SERVED ON THE GROUNDS
TO EVERYONE ATTENDING .**

Catered by Iron Gate Grill

IRON  GATE

ALL EVENTS

EYE CLINIC

May 18 & 19

9:00AM-4:00PM

Cost: payable by cash/check
Dr Amy Knollinger DVM DACVO
To schedule contact Karen Park
manoahmastiffs@gmail.com
Walk ins welcome

MOTELS THAT WILL ACCEPT PETS

NOTE: These motels will allow guests to have well-behaved dogs in the room provided the guests guarantee to reimburse the management for any damages. Some of these motels will not allow dogs unattended in rooms, some require a pet fee/deposit, and some limit numbers and sizes of dogs. (When calling for reservations let the motel know you are with the dog show as some are making special dispensations for our show).

MAKE RESERVATIONS EARLY.

BEST WESTERN WESTON INN250 N Main, Logan UT • 435-752-5700 or 800-532-5055
No pet fee • Full Hot Breakfast • Ask for the dog show group rate \$119 • Heated Indoor Pool & Spa

LAQUINTA INN AND SUITES BY WYNDHAM853 US-89 #91, Logan UT • 435-752-0707

SUPER 8 MOTEL (Check with hotel for pet fee).....865 S Main, Logan UT • 435-753-8883

COMFORT INN & SUITES1665 N Main St, Logan, UT • 435-713-4567

TOWN PLACE SUITES488 S. Main, Logan, UT • 435-709-6789

Free hot breakfast • Nonrefundable pet fee of \$75 • Ask for the dog show rate
Must reserve at least 30 days out to get the block rate.

All motels have been notified of disciplinary action that WILL be taken if property is abused.

NO BATHING OF DOGS IN THE ROOM.

PLEASE VERIFY THAT MOTEL WILL ACCEPT YOUR DOGS – MANAGERS AND POLICIES CHANGE.

ENTRY SUBMISSIONS, CANCELLATIONS, CHANGES, TRANSFERS

MAIL ENTRIES WITH FEES to PO Box 508, Burlington, WA 98233.

CANADIANS make all entry fees payable in U.S. funds.

FAX ENTRIES NOT ACCEPTED. An interactive entry blank PDF that can be filled out and mailed in is available for download at www.BaRayEvents.com.

ONLINE ENTRIES: Web site is **BaRayEvents.com** Follow instructions on Web site. \$3.00 charge per dog per show.

FEDEX, UPS, AIRBORNE or HAND-DELIVERED: Do NOT require signature. 113 E. Fairhaven Ave., Burlington, WA 98233.

PHONE ENTRIES WILL NOT BE ACCEPTED.

CANCELLATIONS, CHANGES AND TRANSFERS will be accepted according to AKC Rules. Any refunds will be made within three weeks after the show. An administration fee may apply. (07/22)

ALL EVENTS

NOTICE TO EXHIBITORS – ALL EVENTS



The American Kennel Club Rules and Regulations will govern this Show and Exhibitors must make themselves familiar with the agreement of the American Kennel Club, referred to on the reverse side of the entry blanks that accompany this Show Premium List.

The American Kennel Club will collect the following at every Licensed or Member club event:

- First entry of a dog in Conformation or Obedience, a \$3.00 Event Service Fee and \$.50 Recording Fee, plus a \$3.50 Service Fee for each additional entry of the same dog.
- First entry and each additional entry of a dog in Agility or Rally, a \$3.50 Service Fee.
- No Entry will be accepted which specifies any condition as to its acceptance. Telegraph, e-mail and unsigned entries cannot be accepted and will be returned. Entries not on Official AKC Entry Forms and Photocopies of Entry Forms without Agreement and Rules on reverse side are NOT ACCEPTABLE. The Club and/or Baray Events assumes no responsibility for wrong or incomplete information given on the entry blank by the owner or the owner's agent. RESPONSIBILITY FOR COMPLETENESS OF ENTRY RESTS SOLELY WITH ENTRANT.
- RETURNED CHECKS DO NOT CONSTITUTE A VALID ENTRY FEE. BaRay Events will add a \$30.00 collection fee to the amount of each returned check. We will not re-process checks. The exhibitor will be contacted & required to send a money order for the original amount PLUS the \$30.00 NSF fee. Subsequent returned checks from same person may result in their being put on a CASH ONLY BASIS.
- REFUNDS for cancellations due to judge change or cancellations made prior to entries closing will be mailed by the Club to said Exhibitor or Agent AFTER THE SHOW. An administrative fee of \$5.00 will be withheld from all refunds for entries cancelled prior to the closing of entries.
- Females in season are not permitted to compete in Obedience or Rally Trials. If a female is withdrawn from competition because it came into season and the Superintendent is notified no later than one half hour prior to the start of the first class in the trial, the Clubs is required to refund the entry fee. The Clubs may retain a processing fee and must publish this information in the premium. Clubs may determine the documentation, if any that is required to confirm the female is in season. This shall be stated in the premium. Note: No fee is paid to the AKC for females in season who are withdrawn.
- FAX ENTRIES – Fax entries will not be accepted.
- Entry fees shall NOT be refunded in the event that a dog is absent, disqualified, sick, lame, excused by the Judge or Veterinarian, or barred from competition by action of the Show Committee, or because it has been entered incorrectly. There is no refund for DUPLICATE ENTRIES or OVERPAYMENTS. If, because of riots, civil disturbances or other acts beyond the control of the management it is impossible to open, or to complete the Show NO REFUND will be made. To find out about any AKC event cancellations call the AKC Event Cancellation Hotline 877-252-3229.
- Please note: Any hotel or motel listed in the premium list is subject to Event Committee Rules. We expect our exhibitors to be responsible guests. A report that an exhibitor at this show has abused hotel or motel property during this weekend may result in disciplinary action. Clubs reserve the right to decline future entries from the offending party in accordance with the provisions of Ch. 11, Sec. 15 of the Rules Applying to Dog Shows.
- Dogs need be present only for scheduled judging and will be released if not needed for further judging. Dogs must be ready for judging. Neither the club nor its Superintendent will be responsible or obligated to furnish any service for notifying exhibitors or their agents of Breed or Class Judging. Judges need not wait for any dog holding up a class. Owners or agents alone are responsible for the presence of their dogs in the rings.
- Only dogs eligible for these shows will be admitted into show area. There is no provision for unentered dogs.
- LOSS OR DAMAGE – The Show Committee will use due care and diligence for the welfare of dogs and exhibitors, but will not be responsible for, or assume any liability in the event of any accident or misfortune, to either dogs or exhibitors participating in these Shows. The welfare of an Exhibitor's child is assumed to be the responsibility of the Exhibitor. It is distinctly understood that Exhibitors will exercise control and restraint over their children.
- Exhibitors should follow their veterinarian's recommendation to assure their dogs are free of internal and external parasites, any communicable diseases, and have appropriate vaccinations. Additionally, clubs should include any specific local health requirements; for example proof of rabies vaccination.
- PUBLICATION RIGHTS – By entering this show, all owners, handlers, breeders and kennels agree that all rights to televise, videotape, photograph, advertise, promote and publicize or otherwise exploit this show, or the persons or animals participating in it or the results of the competition before, during or after the event, shall belong solely to The American Kennel Club and their respective assigns, including the use of the names, likenesses or biographical matter of all dogs, owners, handlers, breeders and kennels participating in the show and no such owner, handler, breeder or kennel shall allow any other party to make commercial use of any videotape or photograph of any person or animal participating in this competition.

ENTER ONLINE: <http://www.BaRayEvents.com>

AMERICAN KENNEL CLUB RULES & REGULATIONS GOVERN THIS EVENT. Entries close at the BaRay Event's Office 12:00PM PDT, Wednesday, **April 24, 2024**, or when any numerical limit is reached, after which time entries cannot be accepted, cancelled or substituted EXCEPT as provided for in Ch. 11, Sec. 6 of the Dog Show Rules. EVENT NUMBER: #2024719102

PREMIUM LIST

THE *Great Basin* **NON-SPORTING** **CLUB of UTAH**

American Kennel Club Licensed – Outdoors – Unbenched SHOW HOURS - 7:00AM to 7:00PM MDT

NON-SPORTING GROUP SHOW

WEDNESDAY, MAY 15, 2024

Non-Sporting Group Show with NOHS & Jr. Showmanship
Best Puppy Competition

Cache County Fairgrounds
450 South 500 West, Logan, UT



CERTIFICATION Permission has been granted by the
American Kennel Club for the holding of this event
under the American Kennel Club rules and regulations.

GINA M. DINARDO, Executive Secretary



BaRay Event Services, Inc.

A.K.C. ANNUALLY LICENSED SUPERINTENDENTS

MEMBER: DOG SHOW SUPERINTENDENTS ASSOCIATION

• SHEILA RAYMOND • BECKY SUMNER • JERRY SUMNER • ANDREA L. FERNANDEZ
• KRISTIN MARICICH • SHARON SAMSON • ROBERTA MARTIN • GLENN WHITTEN
• KRISTILYN FALKENTHAL • SCOTT KIPP • JEFFERY INMAN • HILLARY TREGILLUS

PO BOX 508, BURLINGTON, WA 98233-0508

PHONE: 360-755-7086 • FAX: 360-755-2248

HAND-DELIVERED, EXPRESS or PRIORITY, FEDEX or UPS:

113 E. FAIRHAVEN AVE., BURLINGTON, WA 98233-0508 (do NOT require signature)

E-MAIL: dogshows@barayevents.com • WEB SITE: BaRayEvents.com

OFFICE HOURS
10AM-5PM
PACIFIC TIME
MON.-FRI.

Like us on
FACEBOOK



GREAT BASIN NON-SPORTING CLUB OF UTAH

Dogs are not required to be at the show until scheduled time of judging.

All dogs not needed for further judging will be excused.

The Show Site & RV Parking will be available to exhibitors after 2:00PM Tuesday. On Wednesday parking will be available after 10:00AM. While Wednesday's specialty and group shows are occurring, those with RV parking adjacent to the rings will be required to wait until after the conclusion of the specialty and group shows. Dogs must be removed from the show site 1.5 hours after Best in Show on Sunday.

OFFICERS

Gayle Denman	President	Lynda Wolfe	Vice President
Jackie Bowen	Treasurer	Bruce Swift	Secretary
			tyvigh@msn.com

BOARD OF DIRECTORS - Shelly Bowen, Melanie North, Kim Thomas

SHOW COMMITTEE

Gayle Denman - Show Chair

801-824-8295 • gmdenman@gmail.com

Officers of the Club and Members of the Board of Directors

COMMITTEES

Melanie North	Trophies	Melia North	Trophies Co-Chair
Bruce Swift	Publicity	Kim Thomas	Hospitality
Shelly Bowen	Grounds	Shawna Bagshaw	Chief Ring Steward

PHOTOGRAPHER, SHOW VETERINARIAN & MEDICAL EMERGENCY SERVICES

See Page 2

ENTRY FEES

Highest Priced Class considered the FIRST ENTRY

Separate Fee for each dog - Includes AKC Fees where applicable

First Entry of Each Dog	\$30.00
Each Additional Entry of Same Dog, unless otherwise specified	\$24.00
First Entry in Puppy Classes (6-9 mos. & 9-12 mos.), Bred by Exhibitor & Veteran	\$25.00
Junior Showmanship Only or as Additional Class	No Fee

MAIL ENTRIES WITH FEES to BaRay Event Services, PO Box 508, Burlington, WA 98233

See Entry Submission Guidelines, Page 34.

Vehicles that are parked illegally will be towed by the Logan City Police Department.
If your vehicle is towed, you will be charged for towing as well as possible impound charges.
WE MUST KEEP FIRE LANES as well as some other areas clear.
PLEASE PARK ONLY IN DESIGNATED AREA

ATTENTION EXHIBITORS

Please clean up after your dogs on the show grounds and at your motel site. We want to retain these facilities for future events.

Remember, all complaints regarding conduct prejudicial to the sport will be dealt with in accordance with AKC rules, by the Show Committee.

SMOKING is not permitted on Cache County Fairgrounds property. This will be enforced.

The Great Basin Non-Sporing Club of Utah does not agree to arbitrate claims as set forth on the Official AKC entry form for these events.

**ALL GROUNDS RULES LISTED IN THE MT OGDEN KENNEL CLUB PREMIUM LIST
ARE IN EFFECT AT THIS SHOW.**

GREAT BASIN NON-SPORTING CLUB OF UTAH

JUDGES

Mr. Stephen M Cabral [5812].....DUARTE, CA
Mr. Nathaniel Horn [4549].....KEY LARGO, FL

GROUP AND BREED ASSIGNMENTS	
Non-Sporting Group	Mr. Nathaniel Horn
NOHS Non-Sporting Group	Mr. Stephen M Cabral
Best Puppy Group	Mr. Stephen M Cabral
American Eskimo Dog	Mr. Nathaniel Horn
Bichon Frise	Mr. Nathaniel Horn
Boston Terrier	Mr. Nathaniel Horn
Bulldog	Mr. Nathaniel Horn
Chinese Shar-Pei	Mr. Nathaniel Horn
Chow Chow	Mr. Nathaniel Horn
Coton de Tulear	Mr. Nathaniel Horn
Dalmatian	Mr. Nathaniel Horn
Finnish Spitz	Mr. Nathaniel Horn
French Bulldog	Mr. Nathaniel Horn
Keeshond	Mr. Nathaniel Horn
Lhasa Apso	Mr. Nathaniel Horn
Lowchen	Mr. Nathaniel Horn
Norwegian Lundehund	Mr. Nathaniel Horn
Miniature Poodle	Mr. Nathaniel Horn
Standard Poodle	Mr. Nathaniel Horn
Schipperke	Mr. Nathaniel Horn
Shiba Inu	Mr. Nathaniel Horn
Tibetan Spaniel	Mr. Nathaniel Horn
Tibetan Terrier	Mr. Nathaniel Horn
Xoloitzcuintli	Mr. Nathaniel Horn
Junior Showmanship	Mr. Nathaniel Horn

GREAT BASIN NON-SPORTING CLUB OF UTAH

CLASSIFICATION

Classes Open To All AKC Non-Sporting Breeds

Classes are offered for all breeds or varieties of AKC Non-Sporting breeds. Where classes are further divided by color, weight, or other breed characteristics, it is so indicated below, and the class division MUST be indicated on entry form.

Regular Classes

PUPPY DOGS (6 mos. & under 9 mos.)	PUPPY BITCHES (6 mos. & under 9 mos.)
PUPPY DOGS (9 mos. & under 12 mos.)	PUPPY BITCHES (9 mos. & under 12 mos.)
DOGS (12 mos. & under 18 mos.)	BITCHES (12 mos. & under 18 mos.)
NOVICE DOGS	NOVICE BITCHES
AMATEUR-OWNER-HANDLER DOGS	AMATEUR-OWNER-HANDLER BITCHES
BRED BY EXHIBITOR DOGS	BRED BY EXHIBITOR BITCHES
AMERICAN BRED DOGS	AMERICAN BRED BITCHES
OPEN DOGS	OPEN BITCHES
WINNERS DOG	WINNERS BITCH

Non-Regular Classes Involving Single Dog Entries

VETERAN DOGS	VETERAN BITCHES
--------------	-----------------

A class for Dogs and a class for Bitches, 7 years of age and older. Dogs/bitches entered in Veterans must be intact. Winners, if otherwise undefeated, are eligible for Best of Breed competition.

BEST OF BREED (VARIETY) COMPETITION - The following categories of dogs may be entered and shown in Best of Breed (Variety) Competition: Dogs that are Champions of Record and dogs which according to their owners' records, have completed the requirements for a championship, but whose championships are unconfirmed. The showing of unconfirmed champions in Best of Breed (Variety) Competition is limited to a period of 90 days from the date of the show where the dog completed the requirements for a championship.

BREEDS WITH OPEN CLASS DIVISIONS - MUST BE INDICATED ON ENTRY BLANK

OPEN CLASSES DIVIDED, BOTH SEXES AS LISTED BELOW IN THE FOLLOWING BREEDS

- American Eskimo Dogs: Toy (9 in. to & including 12 in.), Miniature (over 12 in. to & including 15 in.), Standard (over 15 in. to & including 19 in.)
- Boston Terriers: Under 15 lbs., 15 lbs. & Over
- Chinese Shar-Pei: Brush Coat, Horse Coat
- Chow Chows: Rough Coat, Black, Red, AOC., Smooth Coat
- Dalmatians: Black Spotted, Liver Spotted
- Shiba Inus: Red/Red Sesame, Black& Tan/AOC
- Xoloitzcuintli: Toy, Miniature, Standard

USE OF RAMPS - NON-SPORTING BREEDS

The following breeds **must be judged on a ramp** through all levels of conformation competition: Bulldogs, Chinese Shar-Pei, Chow Chows and Keeshonden. Breeds designated as ramp optional may, at the discretion of the judge, be judged on a ramp through all levels of competition. The full policy and list of Table and Ramp eligible/required breeds is available on the AKC website at: https://images.akc.org/pdf/judges/table_breeds.pdf

Ramps can be used to judge any breed in an emergency situation where use of a ramp is not indicated in the premium list; an exhibitor has the option of withdrawing their entry and receiving a refund. For the judging of juniors the ramp may be used at the discretion of the judge for the ramp optional breeds. (04/2024)

GREAT BASIN NON-SPORTING CLUB OF UTAH

For information regarding Regulations, Entry and Eligibility
for the AKC National Owner-Handled Series

Please See www.AKC.org

(Remember to check the box near the bottom of the entry form)



JUNIOR SHOWMANSHIP COMPETITION - NON-SPORTING BREEDS ONLY

NOVICE CLASS: This shall be for boys and girls who are at least 9 years old and under 18 years old on the day of the show and who at the time entries close have not won three (3) first place awards, with competition present, in a Novice Class.

OPEN CLASS: For boys and girls who are at least 9 years old and under 18 years old on the day of the show, and who have won three first place awards in a Novice Class or if a win in Novice leads to a Best Junior with competition present it will count as one win towards moving to Open in a licensed or member show.

MASTER CLASS: This class will be for boys and girls who are at least 9 years old and under 18 years on the day of the show, and who have 10 Best Junior wins with competition. The calendar for this class will be consistent with the eligibility dates for the AKC National Championship. All Juniors meeting the criteria for this class are required to enter the Master Class and may change their entry the day of the show if entries have already closed. Once the eligibility time frame for that year has passed all participants return to the Open Class to compete for the following year.

NOVICE AND OPEN CLASS DIVIDED: **Junior**-9 years old and under 12 years old on the day of the show; **Intermediate**-12 years old and under 15 years old on the day of the show; **Senior**-15 years old and under 18 years old on the day of the show.

After the judge has awarded the Best Junior Handler, the second place winner from the class that the Junior was awarded Best Junior Handler returns to the ring to compete for Reserve Best Junior Handler.

NOTICE: Junior Handlers must include their AKC JUNIOR HANDLER NUMBER on each entry. You may obtain your junior identification number by calling the AKC, Judges Education Department, 919-233-9767. BE SURE ALL INFORMATION for Junior Showmanship Classes is entered on front and back of entry form.

NOTE: SUBSTITUTION OF DOG IN JUNIOR SHOWMANSHIP AT THE SHOW(S): There will be an Administration Fee of \$5.00 charged for any substitution of dog in Junior Showmanship at each show. In addition, if the dog originally entered in Jr. Showmanship was an additional entry, and the dog being substituted is not otherwise entered in the show, the Junior Showmanship Only fee applies.

See the Mount Ogden Kennel Club, Inc Premium List pages noted below for the following information:

Day, Reserved & RV Parking - Pages 14 - 15

Reserved Grooming - Page 16

Site Information & Rules - Page 5

Motels & Hotels - Page 24

**The Show Site & RV Parking will be available to exhibitors after 2:00PM Tuesday.
On Wednesday, parking will be available after 10:00AM.**

GREAT BASIN NON-SPORTING CLUB OF UTAH

REGULAR VARIETY GROUP PRIZES

FIRST PLACE, NON-SPORTING GROUP: Rosette, offered by Great Basin Non- Sporting Club of Utah
\$100.00 offered by Bruce Swift Kotu Poodles

SECOND PLACE, NON-SPORTING GROUP: Rosette offered by Great Basin Non-Sporting Club of Utah

\$75.00 offered by Quail Pointe Veterinary Hospital

THIRD PLACE, NON-SPORTING GROUP: Rosette offered by Great Basin Non-Sporting Club of Utah
\$50.00 offered by Kim Thomas Concord Frenchies

FOURTH PLACE, NON-SPORTING GROUP: Rosette offered by Great Basin Non-Sporting Club of Utah

\$25.00 offered by Gayle & Dick Denman Gandalfs Miniature Bull Terriers

NOHS NON-SPORTING GROUP

FIRST PLACE, NOHS NON-SPORTING GROUP: Rosette offered by Great Basin Non-Sporting Club of Utah

\$100.00 offered by Pat M Jenkins, Wolfmountain

SECOND PLACE, NOHS NON-SPORTING GROUP: Rosette offered by Great Basin Non-Sporting Club of Utah

\$75.00 offered by Erin Coogan

THIRD PLACE, NOHS NON-SPORTING GROUP: Rosette offered by Great Basin Non-Sporting Club of Utah

\$50.00 offered by Kim Thomas, Concord Frenchies

FOURTH PLACE, NOHS NON-SPORTING GROUP: Rosette offered by Great Basin Non-Sporting Club of Utah

\$25.00 offered by Melanie North & Melia North, Lacy Lane Poodles

PUPPY GROUP

FIRST PLACE, PUPPY GROUP: Rosette offered by Great Basin Non-Sporting Club of Utah
Dog Toy valued at \$25.00 offered by Gayle & Dick Denman, Gandalfs Miniature Bull Terriers

SECOND-FOURTH PLACE, PUPPY GROUP: Ribbon offered by Great Basin Non-Sporting Club of Utah

Dog Toy valued at \$15.00 offered by Shelly & Jackie Bowen, Red Lion

JUNIOR SHOWMANSHIP

BEST JUNIOR HANDLER: Rosette offered by Great Basin Non-Sporting Club of Utah
\$50.00 Visa Gift Card offered by Lesli Smith Professional Handling, LLC

RESERVE BEST JUNIOR HANDLER: Rosette offered by Great Basin Non-Sporting Club of Utah
\$25.00 Visa Gift Card offered by Lesli Smith Professional Handling, LLC

GREAT BASIN NON-SPORTING CLUB OF UTAH

RIBBON/ROSETTE PRIZES

REGULAR CLASSES

First Prize.....	Blue Ribbon	Second Prize.....	Red Ribbon
Third Prize.....	Yellow Ribbon	Fourth Prize.....	White Ribbon
Winners.....	Purple Ribbon	Reserve Winners.....	Purple & White Ribbon
Best of Winners.....	Blue & White Ribbon	Selects.....	Light Blue & White Ribbon
Best of Each Breed and Best of Each Variety of Breed.....			Purple & Gold Ribbon
Best of Opposite Sex to Best of Breed and Best of Variety of Breed.....			Red & White Ribbon
Best Puppy.....	Dark Green Ribbon	NOHS Best of Breed.....	Maroon Ribbon

NON-REGULAR & JR. SHOWMANSHIP CLASSES

First Prize.....	Rose Ribbon	Second Prize.....	Brown Ribbon
Third Prize.....	Light Green Ribbon	Fourth Prize.....	Gray Ribbon
Best Junior Handler.....	Rose & Green Rosette	Reserve Best Jr. Handler.....	Rose & Gray Rosette

VARIETY GROUP

First Prize.....	Blue Rosette	Second Prize.....	Red Rosette
Third Prize.....	Yellow Rosette	Fourth Prize.....	White Rosette

NOHS VARIETY GROUP

First Prize.....	Neon Pink Rosette	Second Prize.....	Neon Green Rosette
Third Prize.....	Teal Rosette	Fourth Prize.....	Cream Rosette

PUPPY GROUP

First Prize.....	Rose Rosette	Second Prize.....	Brown Ribbon
Third Prize.....	Light Green Ribbon	Fourth Prize.....	Gray Ribbon

SPECIAL RECOGNITION

Eligibility for Best Puppy competitions predicated upon entry into the following class(es) and all divisions of:

- Best Puppy – any class limited to dogs six months and older and under 12 months of age; Puppy, 6-9 Puppy and 9-12 Puppy.

NOTE: Best Puppy competition will be forgone if the Best of Breed is one of the above.

The Best Puppy will be awarded from the First Place winners in the Puppy classes immediately following each breed. If the Best of Breed is awarded to a dog/bitch coming from a Puppy Class for that breed, the Best Puppy win is automatic. Best Puppy Group Judging will be judged following Regular Group judging.

ENTRY SUBMISSIONS, CANCELLATIONS, CHANGES, TRANSFERS

MAIL ENTRIES WITH FEES to PO Box 508, Burlington, WA 98233.

CANADIANS make all entry fees payable in U.S. funds.

FAX ENTRIES NOT ACCEPTED. An interactive entry blank PDF that can be filled out and mailed in is available for download at www.BarayEvents.com.

ONLINE ENTRIES: Web site is **BaRayEvents.com** Follow instructions on Web site. \$3.00 charge per dog per show.

FEDEX, UPS, AIRBORNE or HAND-DELIVERED: Do NOT require signature. 113 E. Fairhaven Ave., Burlington, WA 98233.

PHONE ENTRIES WILL NOT BE ACCEPTED.

CANCELLATIONS, CHANGES AND TRANSFERS will be accepted according to AKC Rules. Any refunds will be made within three weeks after the show. An administration fee may apply. (07/22)

AMERICAN KENNEL CLUB RULES & REGULATIONS GOVERN THESE EVENTS. Entries close at the BaRay Event's Office 12:00PM PDT, Wednesday, **April 24, 2024**, or when any limit is reached, after which time entries cannot be accepted, cancelled or substituted EXCEPT as provided for in Ch. 11, Sec. 6 of the Dog Show Rules. **EVENT NUMBERS:** #1-2024011418, #2-2024011419



PREMIUM LIST

Alaskan Malamute Club of America

(Member of the American Kennel Club - Outdoors, Unbenched)

Cache County Fairgrounds

450 South 500 West, Logan, UT 84319

WEDNESDAY, MAY 15, 2024

ROCKY MOUNTAIN AREA SPECIALTY

Show #1 with Sweepstakes

Show #2 with Sweepstakes & Jr. Showmanship

Entry Limit 100 Each Show.

SHOW HOURS - 8:30AM to 7:00PM - MDT

Dogs are not required to be at the show until scheduled time of judging.

All dogs not needed for further judging will be excused.



AMERICAN
KENNEL CLUB®

CERTIFICATION Permission has been granted by the American Kennel Club for the holding of this event under the American Kennel Club rules and regulations.

GINA M. DINARDO, Executive Secretary



BaRay Event Services, Inc.

A.K.C. ANNUALLY LICENSED SUPERINTENDENTS

MEMBER: DOG SHOW SUPERINTENDENTS ASSOCIATION

• SHEILA RAYMOND • BECKY SUMNER • JERRY SUMNER • ANDREA L. FERNANDEZ
• KRISTIN MARICICH • SHARON SAMSON • ROBERTA MARTIN • GLENN WHITTEN
• KRISTILYN FALKENTHAL • SCOTT KIPP • JEFFERY INMAN • HILLARY TREGILLUS

PO BOX 508, BURLINGTON, WA 98233-0508

PHONE: 360-755-7086 • FAX: 360-755-2248

HAND-DELIVERED, EXPRESS or PRIORITY, FEDEX or UPS:

113 E. FAIRHAVEN AVE., BURLINGTON, WA 98233-0508 (do NOT require signature)

E-MAIL: dogshows@barayevents.com • WEB SITE: BaRayEvents.com

OFFICE HOURS
10AM-5PM
PACIFIC TIME
MON.-FRI.

Like us on
FACEBOOK



ALASKAN MALAMUTE CLUB OF AMERICA

OFFICERS

Pam Fusco President Rob Pratt Vice President
Dru Martin-Nutzell Treasurer Leneia Rogowski Recording Secretary
Melissa Sage Corresponding Secretary
melissa@sageresearchconsulting.net

BOARD OF DIRECTORS

Justin Scoffield • Amy Novak • Ann Mayberry-Welch
Tina Robbins • Andrea Sautbine • Sharon Weston

Delegate to the American Kennel Club – Kate McCallum

SHOW COMMITTEE

Brock Powell – Show Chair
brock75p@yahoo.com – 801-201-2038

And All Officers and Board of Directors

COMMITTEES

Kami Jenkins Chief Ring Steward Pat & Morty Jenkins Grounds
Pat Jenkins & Leneia Rogowski Trophies Leneia Rogowski Catalog Advertising

This club does not agree to arbitrate claims as set forth on the Official AKC entry form for this event.

PHOTOGRAPHER, SHOW VETERINARIAN & MEDICAL EMERGENCY SERVICES

See Page 2.

ENTRY FEES - EACH SHOW

Highest Priced Class considered the FIRST ENTRY

Separate Fee for each dog, each show - Includes AKC Fees where applicable

When a dog is entered in more than one class, highest priced class is considered first entry.

First Entry of Each Dog, unless otherwise specified\$30.00
Each Additional Entry of Same Dog, unless otherwise specified.....\$25.00
Junior Showmanship Only or as Additional Class..... No Fee
Sweepstakes (must be entered in a regular class)\$15.00
Veteran Sweepstakes (need not be entered in another class).....\$15.00
Brace, Per Dog.....\$10.00

MAIL ENTRIES WITH FEES to BaRay Event Services, PO Box 508, Burlington, WA 98233

See Entry Submission Guidelines, Page 42

See the Mount Ogden Kennel Club, Inc Premium List pages noted below for the following information:

Day, Reserved & RV Parking - Pages 14 - 15

Reserved Grooming - Page 16

Site Information & Rules - Page 5

Motels & Hotels - Page 24

**The Show Site & RV Parking will be available to exhibitors after 2:00PM Tuesday.
On Wednesday, parking will be available after 10:00AM.**

ALASKAN MALAMUTE CLUB OF AMERICA

JUDGES

Show #1 - All Conformation Classes	
Mr. Kim Griffith* [99175].....	WESTMORELAND, TN
Show #1 - Sweepstakes & Veteran Sweepstakes	
Ms. Laurie Newburn	BELLEVUE, MI
Show #2 - All Conformation & Junior Showmanship Classes	
Mr. Stephen M Cabral* [5812]	DUARTE, CA
Show #2 - Sweepstakes & Veteran Sweepstakes	
Ms. Betty Ruffini	LOS CRUCES, NM

CLASSIFICATION - BOTH EVENTS

Regular Classes

PUPPY DOGS (6 MOS. & under 9 MOS.)	PUPPY BITCHES (6 MOS. & under 9 MOS.)
PUPPY DOGS (9 MOS. & under 12 MOS.)	PUPPY BITCHES (9 MOS. & under 12 MOS.)
DOGS (12 MOS. & under 18 MOS.)	BITCHES (12 MOS. & under 18 MOS.)
NOVICE CLASSES NOT OFFERED	
AMATEUR-OWNER-HANDLER DOGS	AMATEUR-OWNER-HANDLER BITCHES
BRED BY EXHIBITOR PUPPY DOGS (6-12 MOS.)	BRED BY EXHIBITOR PUPPY BITCHES (6-12 MOS.)
BRED BY EXHIBITOR ADULT DOGS (12+ MOS.)	BRED BY EXHIBITOR ADULT BITCHES (12+ MOS.)
AMERICAN BRED DOGS	AMERICAN BRED BITCHES
OPEN DOGS	OPEN BITCHES
WINNERS DOG	WINNERS BITCH

Non-Regular Classes Involving Single Dog Entries

VETERAN DOGS, 8 yrs. & under 10 yrs.	VETERAN BITCHES, 8 yrs. & under 10 yrs.
VETERAN DOGS, 10 yrs. & under 12 yrs.	VETERAN BITCHES, 10 yrs. & under 12 yrs.
VETERAN DOGS, 12 yrs. & older	VETERAN BITCHES, 12 yrs. & older

A class for Dogs and a class for Bitches in each of the age groups listed above. Dogs/bitches entered in Veterans need not be intact. Winners, if otherwise undefeated, are eligible for Best of Breed competition.

BEST OF BREED (VARIETY) COMPETITION - The following categories of dogs may be entered and shown in Best of Breed (Variety) Competition: Dogs that are Champions of Record and dogs which according to their owners' records, have completed the requirements for a championship, but whose championships are unconfirmed. The showing of unconfirmed champions in Best of Breed (Variety) Competition is limited to a period of 90 days from the date of the show where the dog completed the requirements for a championship. Selects, if applicable, will be chosen following Best of Breed.

Non-Regular Class Involving Multiple Dog Entries

Brace Class: Two Dogs, performing in unison, and presented by a maximum of two handlers. Both dogs competing in the brace class must have at least one common owner. Both dogs do not need to be entered in any other class, however, one of the dogs must be entered in a regular class. Dogs comprising a Brace Class must be named at the time of entry, and full particulars must be given for each dog on individual entry forms. An entry form for a dog entered in another class and entered as part of a Brace must be marked accordingly in the space provided for additional classes as "Brace Class."

"Dogs found in an unsafe environment, distress or harm's way (for example: left unattended on a grooming table in a noose not attached to a safety release clip; left in a vehicle without proper ventilation) will be removed to safety. Exposing a dog to an unsafe environment, distress or harm's way is considered mistreatment."

ALASKAN MALAMUTE CLUB OF AMERICA

BREED PRIZES - ALL EVENTS

All prizes are Malamute related items.
- items of greater value may be substituted -

Best of Breed, Best of Opposite Sex to Best of Breed & Best of Winners: offered by AMCA

Best of Breed, Best of Opposite Sex to Best of Breed & Best of Winners: offered by Wolfmountain & Stormrunner Kennels

Best in Sweepstakes/Veteran Sweepstakes: offered by Patriot Kennels

Best of Opposite Sex to Best in Sweepstakes/Veteran Sweepstakes: offered by Patriot Kennels

Best Junior Handler: offered by Wolfmountain & Stormrunner Kennels

RIBBON/ROSETTE PRIZES - ALL EVENTS

The Ribbon Prizes in all Regular Classes will be as follows:

First Prize.....	Blue Ribbon	Second Prize.....	Red Ribbon
Third Prize.....	Yellow Ribbon	Fourth Prize.....	White Ribbon
Winners.....	Purple Ribbon	Reserve Winners.....	Purple & White
Selects.....			Light Blue & White Ribbon
Best of Breed.....			Purple & Gold Rosette
Best of Winners.....			Blue & White Rosette
Best of Opposite Sex to Best of Breed.....			Red & White Rosette

The Ribbon Prizes in all Non-Regular Classes will be as follows:

First Prize.....	Rose Ribbon	Second Prize.....	Brown Ribbon
Third Prize.....	Light Green Ribbon	Fourth Prize.....	Gray Ribbon
Best Junior Handler.....			Rose & Green Rosette
Best in Sweepstakes & Best in Veteran Sweepstakes.....			Pink & Green Rosette
Best of Opposite Sex to Best in Sweepstakes & Veteran Sweepstakes.....			Lavender Rosette

JUNIOR SHOWMANSHIP COMPETITION - SHOW 2

NOVICE CLASS: This shall be for boys and girls who are at least 9 years old and under 18 years old on the day of the show and who at the time entries close have not won three (3) first place awards, with competition present, in a Novice Class.

OPEN CLASS: For boys and girls who are at least 9 years old and under 18 years old on the day of the show, and who have won three first place awards in a Novice Class or if a win in Novice leads to a Best Junior with competition present it will count as one win towards moving to Open in a licensed or member show.

MASTER CLASS: This class will be for boys and girls who are at least 9 years old and under 18 years old on the day of the show, and who have 10 Best Junior wins with competition.

NOVICE AND OPEN CLASS DIVIDED: **Junior**-9 years old and under 12 years old on the day of the show; **Intermediate**-12 years old and under 15 years old on the day of the show; **Senior**-15 years old and under 18 years old on the day of the show.

NOTICE: Junior Handlers must include their AKC JUNIOR HANDLER NUMBER on each entry. You may obtain your junior identification number by calling the AKC, Judges Education Department, 919-233-9767. BE SURE ALL INFORMATION for Junior Showmanship Classes is entered on front and back of entry form.

NOTE: SUBSTITUTION OF DOG IN JUNIOR SHOWMANSHIP AT THE SHOW(S): There will be an Administration Fee of \$5.00 charged for any substitution of dog in Junior Showmanship at each show. In addition, if the dog originally entered in Jr. Showmanship was an additional entry, and the dog being substituted is not otherwise entered in the show, the Junior Showmanship Only fee applies.

ALASKAN MALAMUTE CLUB OF AMERICA

SWEEPSTAKES

REQUIREMENTS & CLASSIFICATION

Open to any Alaskan Malamute between the ages of 6 months and not over 18 months on the day of the show. All entries in the Sweepstakes MUST ALSO be entered in one of the regular Conformation classes at the regular entry fee and on the regular entry form. Indicate your Sweepstakes Class with the age division in the space provided for "Additional Class." Champions of Record are eligible for the Sweepstakes.

The following classes will be provided for both dogs and bitches

- Puppy, 6 Mos & Under 9 Mos
- Puppy, 9 Mos & Under 12 Mos
- Graduate, 12 Mos & Under 18 Mos
- Best in Sweepstakes
- Best of Opposite Sex to Best in Sweepstakes

DIVISION OF ENTRY MONEY AS PRIZES

35% of total entry fees will be retained for expenses.

Best In Sweepstakes 10% of total purse

Best of Opposite in Sweepstakes 5% of total purse

The remainder will be divided as follows:

First Place in Each Class.....40% Second Place in Each Class.....30%

Third Place in Each Class.....20% Fourth Place in Each Class.....10%

Undistributed funds revert to the club

VETERAN SWEEPSTAKES

REQUIREMENTS & CLASSIFICATION

Veteran Sweepstakes is open to all Alaskan Malamutes that are at least 8 years of age & older on the day of the show. Dogs DO NOT have to be entered in a regular class to compete in Veteran Sweepstakes. Indicate your Veteran Sweepstakes Class with the age division in the space provided. Neutered dogs & spayed bitches are eligible.

The following classes will be provided for both dogs and bitches

- Veteran, 8 Yrs. & Under 10 Yrs.
- Veteran, 10 Yrs. & Under 12 Yrs.
- Veterans, 12 Yrs. and older
- Best in Veteran Sweepstakes
- Best of Opposite Sex to Best in Veteran Sweepstakes

DIVISION OF ENTRY MONEY AS PRIZES

35% of total entry fees will be retained for expenses.

Best in Veteran Sweepstakes10% of total purse

Best of Opposite in Veteran Sweepstakes.....5% of total purse

The remainder will be divided as follows:

First Place in Each Class.....40% Second Place in Each Class.....30%

Third Place in Each Class.....20% Fourth Place in Each Class.....10%

Undistributed funds revert to the club

ALASKAN MALAMUTE CLUB OF AMERICA

ATTENTION EXHIBITORS

Please clean up after your dogs on the show grounds and at your motel site. We want to retain these facilities for future events.

Remember, all complaints regarding conduct prejudicial to the sport will be dealt with in accordance with AKC rules, by the Show Committee.

SMOKING will not be permitted inside show buildings - state law, or around show rings. This will be enforced.

The Alaskan Malamute Club of America, Inc. does not agree to arbitrate claims as set forth on the Official AKC entry form for these events.

CATALOG ADVERTISING

All pages include one photo or logo. Additional photos or logos are \$15.00 each.

No limit on photos/logos on camera-ready ads.

Inside front or inside back cover.....	\$45
Full page.....	\$35
Half Page.....	\$25
Quarter Page.....	\$15

Deadline March 20, 2024

Please contact: Leneia Rogowski
640 E 50 N, Hyrum, UT 84319

Lunch will be offered between shows to be held at the bowery.

Sponsored by Wolfmountain Kennel (Pat & Morty Jenkins) and
Stormrunner Kennel (Leneia & Cassandra Rogowski)

Vehicles that are parked illegally will be towed by the Logan City Police Department.
If your vehicle is towed, you will be charged for towing as well as possible impound charges.

WE MUST KEEP FIRE LANES as well as some other areas clear.

PLEASE PARK ONLY IN DESIGNATED AREA

ENTRY SUBMISSIONS, CANCELLATIONS, CHANGES, TRANSFERS

MAIL ENTRIES WITH FEES to PO Box 508, Burlington, WA 98233.

CANADIANS make all entry fees payable in U.S. funds.

FAX ENTRIES NOT ACCEPTED. An interactive entry blank PDF that can be filled out and mailed in is available for download at www.BarayEvents.com.

ONLINE ENTRIES: Web site is **BaRayEvents.com** Follow instructions on Web site. \$3.00 charge per dog per show.

FEDEX, UPS, AIRBORNE or HAND-DELIVERED: Do NOT require signature. 113 E. Fairhaven Ave., Burlington, WA 98233.

PHONE ENTRIES WILL NOT BE ACCEPTED.

CANCELLATIONS, CHANGES AND TRANSFERS will be accepted according to AKC Rules. Any refunds will be made within three weeks after the show. An administration fee may apply. (07/22)